

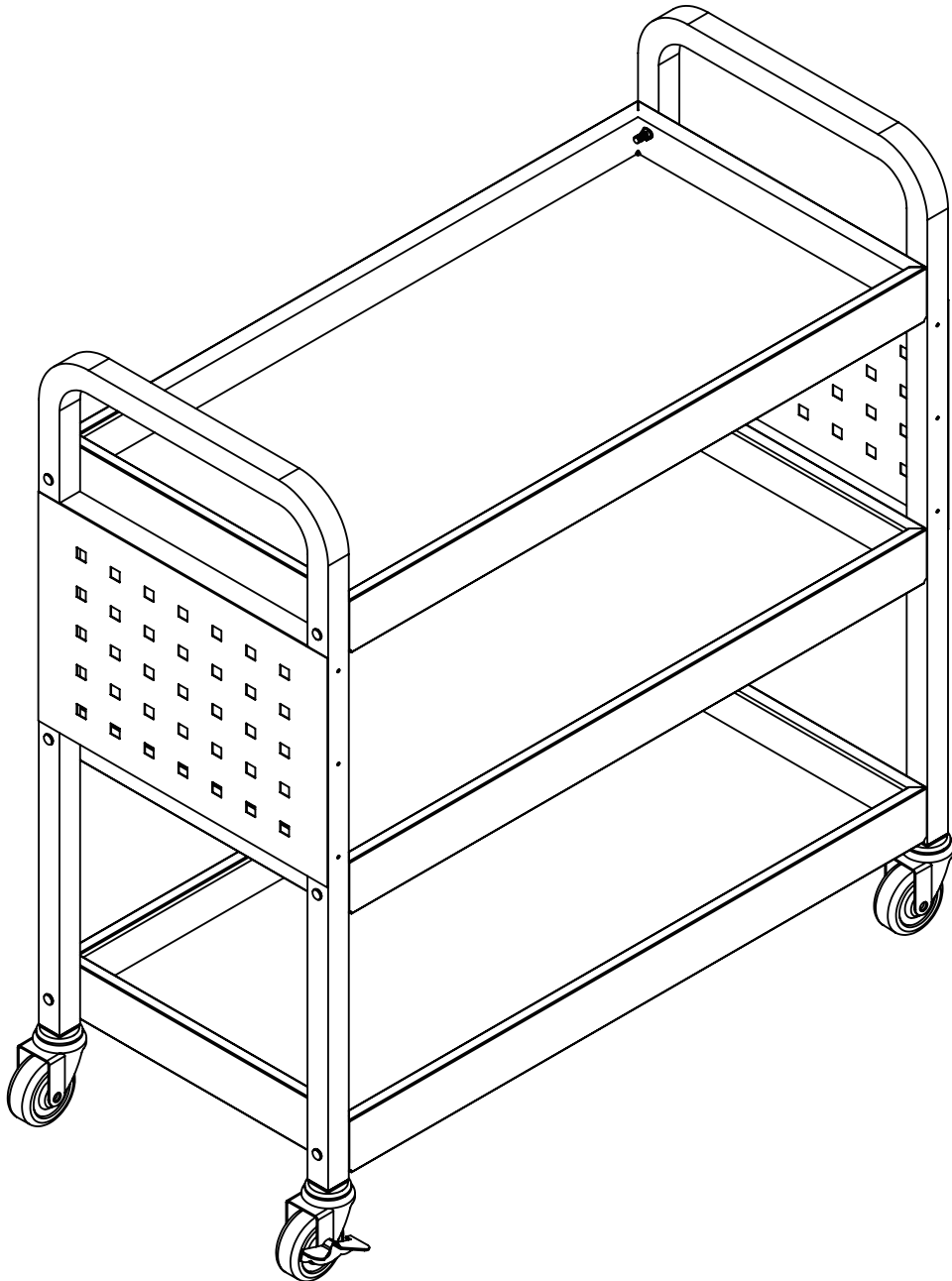

IN220800108V01_UK

B20-095V01



IMPORTANT, RETAIN FOR FUTURE REFERENCE: READ CAREFULLY

ASSEMBLY INSTRUCTION

EXPLOSION FIGURE

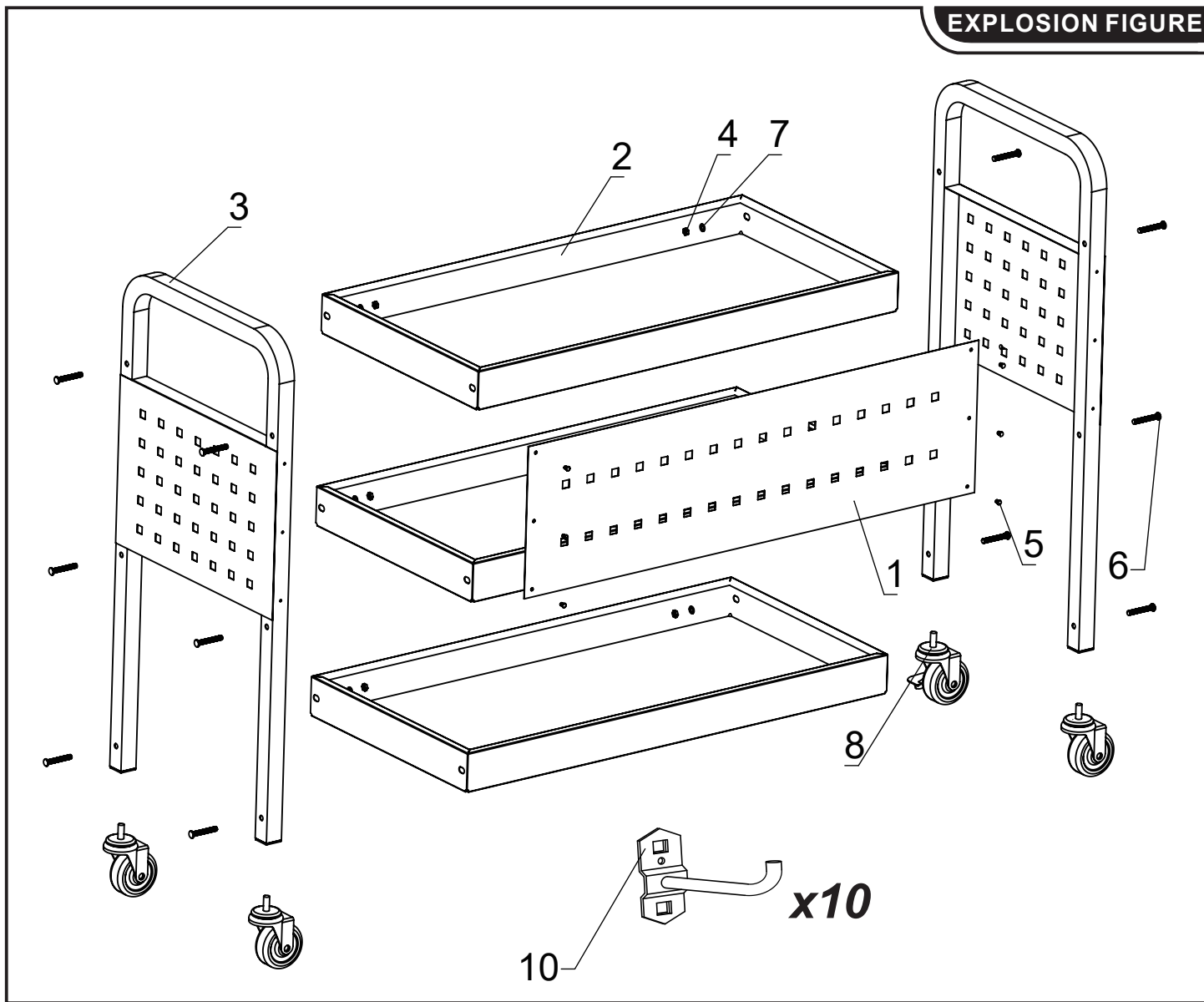

PARTS

<p>① x 1</p>	<p>② x 3</p>	<p>③ x 2</p>
<p>④ x 12 +1 (spare)</p> <p>M6</p>	<p>⑤ x 6 +1 (spare)</p> <p>M4*8</p>	<p>⑥ x 12 +1 (spare)</p> <p>M6*40</p>
<p>⑦ x 12 +1 (spare)</p>	<p>⑧ x 1</p>	<p>⑨ x 3</p>
<p>⑩ x 10</p>		

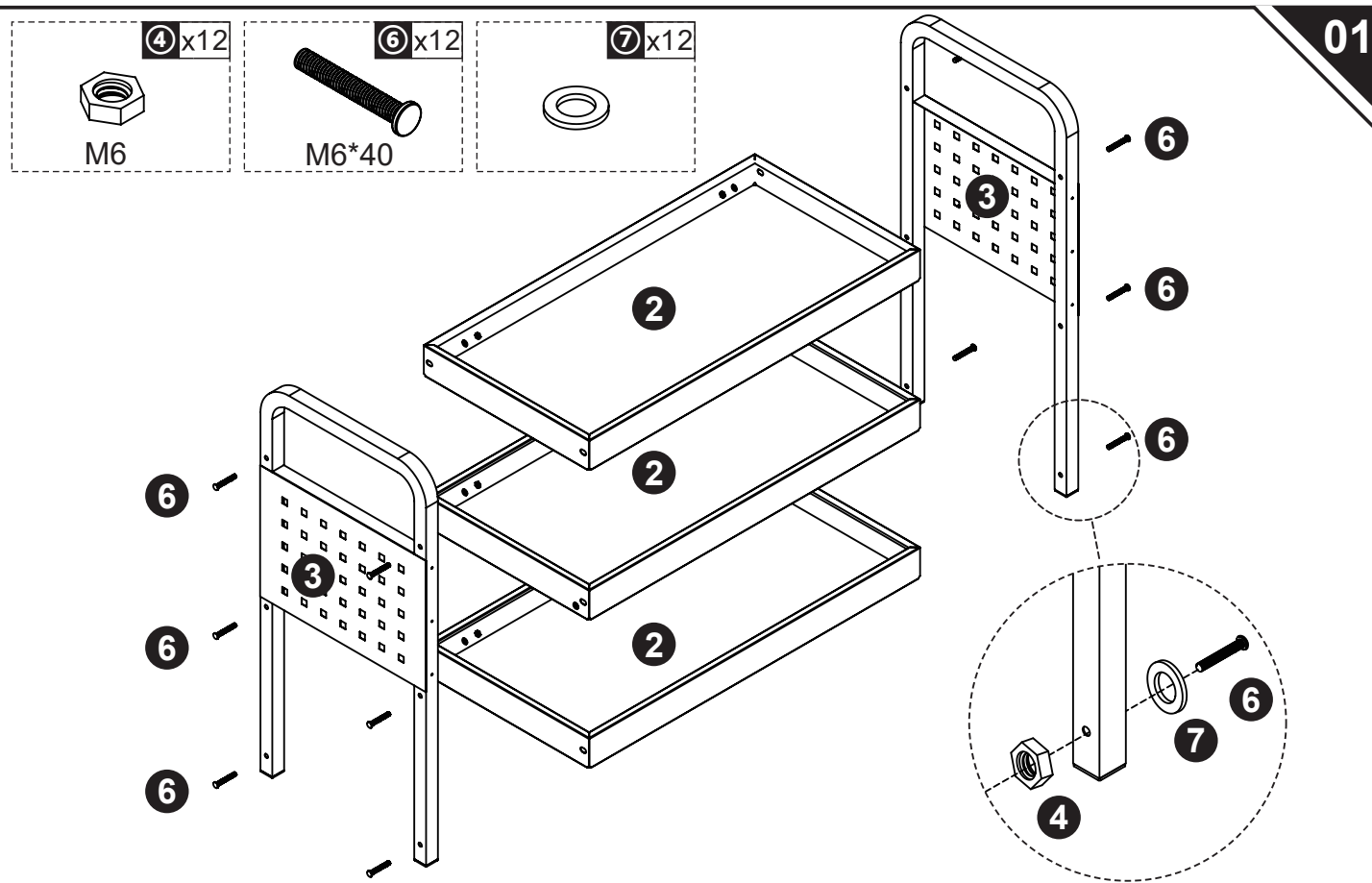

Step 1: Fixed the 3 trays on the left and right pillars with 12 pieces M6*40 screws and gaskets

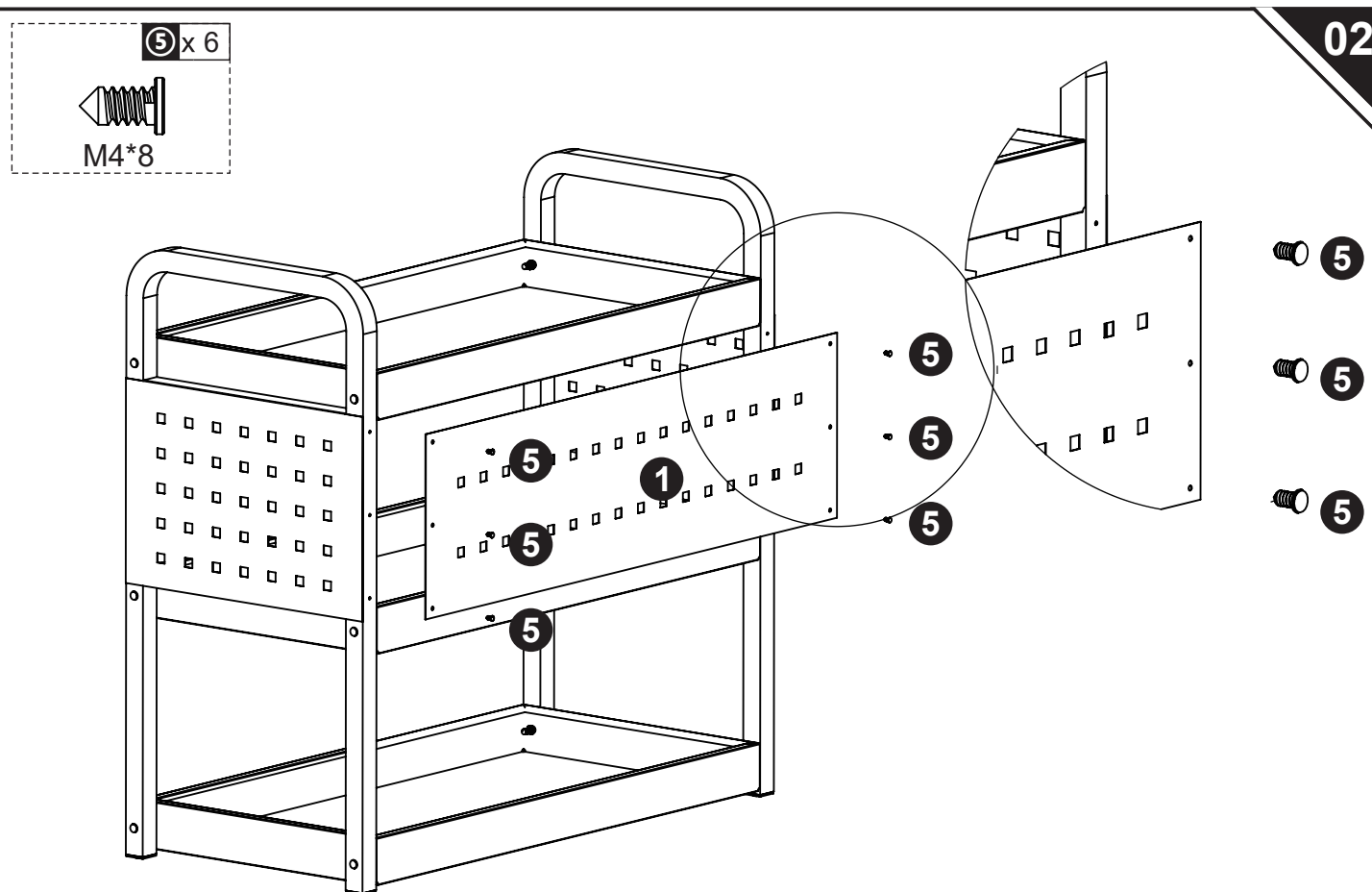

Step 2: Fixed the back board on the pillars with 6 pieces M4*8 tapping screws

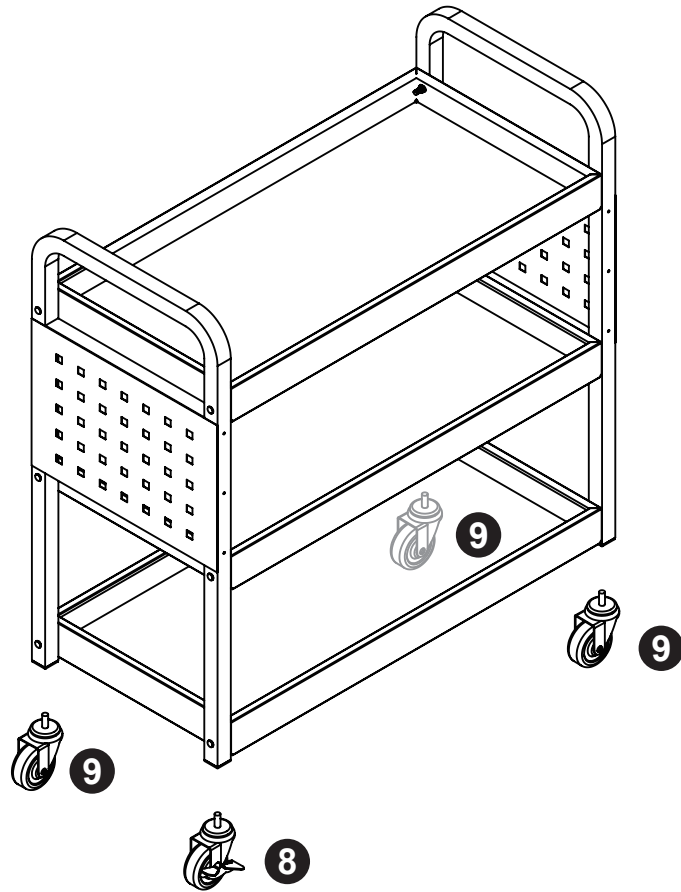

Step 3: Assemble 3 swivel casters and 1 brake caster on the below of pillars



x10

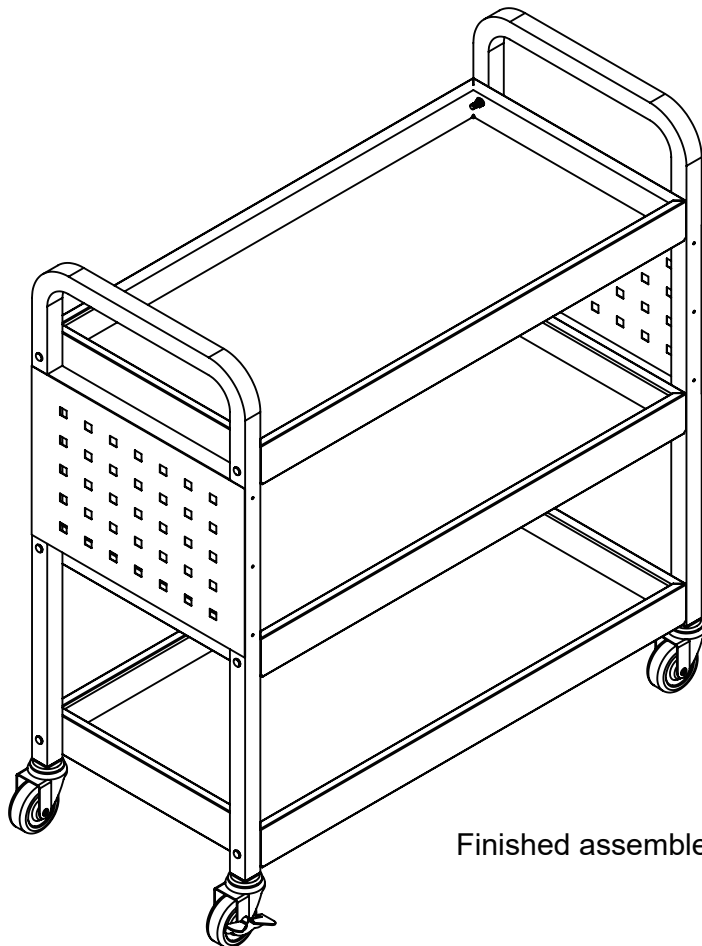



Finished assemble!

Dear customer,

Thank you for purchasing this product. So that your appliance serves you well, please read all the instructions in this user's manual. If you have any questions, please contact our customer care center.

Our contact details are below:

Country	 Phone	 Email
UK	0044-800-240-4004	enquiries@mhstar.co.uk

IMPORTER ADDRESS:

MH STAR UK LTD
Unit 27, Perivale Park,
Horsenden lane South
Perivale, UB6 7RH

MADE IN CHINA