



EN
AGES 3+

GMC Sierra HD

12V BATTERY OPERATED RIDE ON

INfda006_US_370-147

OWNER'S MANUAL

Please read entire manual before starting assembly.
Keep this manual along with your purchase receipt
for future reference.



⚠ WARNING:
CHOKING HAZARD—Small parts.
Not for children under 3 yrs.

⚠ WARNING:
Toy must be assembled by adult before use.

⚠ CAUTION
Screws contain potentially
hazardous sharp points or
sharp edges. Adult assembly
required.

⚠ WARNING
To reduce the risk of injury, adult supervision
is required. Never use on road ways, near
motor vehicles, on or near steep inclines or
steps, swimming pools or other bodies of
water. Always wear shoes, and never allow
more than two riders.



OFFICIAL
LICENSED PRODUCT

GENERAL MOTORS TRADEMARKS USED UNDER LICENSE TO JIAXING HARLEY BABY CAR CO.LTD

Contents, colors and decorations may vary from those shown.

| | |
|-----------------|--|
| Specifications: | |
| Battery: | 1*12V*10AH |
| Motor: | 2*550(45W) |
| Suitable ages: | 3-8 ages |
| Maximum weight: | 40KG |
| Speed : | 3-5KM/H |
| Power way: | Charging type |
| Use of time: | Charg: 8-10 hours ; Use: 0.75 hours |
| Charger: | Input AC 110~ 240V, ~Hz, output DC 12 V 1000mA |

WARNING

- 1.The pictures in this instruction is only for explaining the operation and structure of the product, when there's any difference with the real product, please confirm with the real product.
- 2.In order to improve the quality of the product,we may amend some structure or appearance of the product without notification.Thank you for your understanding.

FOR THE SAFETY OF YOUR CHILD, PLEASE READ ALL WARNINGS AND ASSEMBLY/USE INSTRUCTIONS. KEEP THIS GUIDE FOR FUTURE REFERENCE.

- ADULT ASSEMBLY REQUIRED. The product contains small parts, which are for adult assembly only. keep small children away when assembling.
- always remove protective material and poly bags and dispose before assembly.
- never leave child unattended. direct adult supervision is required.
- always keep child in view when child is in vehicle.
- Keep Children within Safe Riding Areas:
- Never use in roadways, near motor vehicles, on lawn space, on or near steep inclines or steps, swimming pools or or any other dangerous area.
- Use the toy only on flat surfaces. Such as inside your house, garden or playground.
- Never use in the dark. A child could encounter unexpected obstacles and have an accident. Operate the vehicle only in the daytime or a well-lit area.
- Please avoid running on sand or any other rough ground.
- always wear shoes.
- always sit on the seat.
- this toy has no brake.
- It is prohibited to change the circuit or add other electric parts
- Inspect wires and connections of the vehicle periodically.
- Do not let any child touch the wheels or be near them when the car is moving.
- This vehicle has adjustable play seat belts. Please instruct children how to tie the safety belt before using, guarantee the security.

STORAGE BATTERY INFORMATION AND MAINTENANCE

- Please charge 12 hours before first time use.
 - Please use the suitable adapter to charge storage battery, otherwise the ride-on will be damaged.
 - Please charge the car once the speed is slower than normal, otherwise it will decrease storage battery life.
 - Please fully charge the battery before you put your ride-on away, and remember to recharge the battery every 30 days. This will ensure the normal use of the battery, otherwise, the battery might not hold a charge without proper maintenance.
 - Batteries may leak fluids that can cause chemical burn injury or ruin your product.
 - To avoid battery leakage: Do not mix old and new batteries or batteries of different types: alkaline, standard (carbon-zinc) or rechargeable (nickel-cadmium).
 - Insert batteries as indicated inside the battery compartment. Remove batteries during long periods of non-use.
 - Always remove exhausted batteries from the product. Dispose of batteries safely. Do not dispose of batteries in a fire. The batteries may explode or leak.
 - Never short-circuit the battery terminals.
 - Non-rechargeable batteries are not to be recharged.
 - Use only batteries of the same or equivalent type as recommended.
 - Do not charge non-rechargeable batteries.
 - Remove rechargeable batteries from the product before charging.
 - If removable rechargeable batteries are used, they are only to be charged under adult supervision.
 - Every single charging can not go over 24 hours. Both charger and storage batteries will occur mildly warm during charging. Do not use malfunctioned adapter or storage battery unless they are repaired.
 - Charger and storage batteries are not considered as toys.
 - Please make periodical inspection for storage battery, especially for adapter wires and plugs.
 - Please turn off the switch when the ride-on is not in use. Please do a full charge after long periods of inactivity.
 - Charge in well ventilated, dry place. Do not open the battery or the charger.
 - Tighten the screws with a screwdriver. DO NOT over tighten
- Disposal Of Battery:
1. Your sealed lead-acid battery must be recycled or disposed of in an environmentally sound manner.
 2. Do not dispose of your lead-acid battery in a fire. The battery may explode or leak.
 3. Do not dispose of a lead-acid battery in your regular, household trash. The incineration, land filling or mixing of sealed lead-acid batteries with house-hold trash is prohibited by law.

PREVENT FIRE AND ELECTRIC SHOCK:

- Use the only rechargeable battery and charger supplied with your vehicle.
- NEVER substitute the battery or the charger with another brand. Using another battery or charger may cause a fire or explosion.
- Do not use the battery or charger for any other product. Overheating, fire or explosion could occur.
- NEVER modify the electric circuit system. Tampering with the electric system may cause a shock, fire or explosion or may permanently damage the system.
- Do not allow direct contact between battery terminals. Fire or explosion can occur.
- Do not allow any type of liquid on the battery or its components.
- Explosive gasses are created during charging. Do not charge near heat or flammable materials. Charge the battery in a well-ventilated area ONLY.
- NEVER pick up the battery by the wires or charger. Damage can occur to the battery and may cause a fire. Pick up the battery by the case ONLY. Charge the battery in a dry area ONLY.

- Battery posts, terminals and related accessories contain lead and lead compounds, chemicals known to the State of California to cause cancer and reproductive harm. Wash hands after handling.

- Do not open the battery. Battery contains lead acid and other materials that are toxic and corrosive.

- Do not open the charger. Exposed wiring and circuitry inside case may cause electric shock.

ONLY adults may handle or charge the battery. NEVER allow child to handle or charge the battery. Battery is heavy and contains lead acid (electrolyte).

- Do not drop the battery. Permanent damage to the battery could occur or cause serious injury.

- Before charging the battery, check for wear or damage to the battery, charger, its supply cord and the connectors. DO NOT charge the battery if any damage to parts has occurred.

Do not allow the battery to drain completely. Recharge the battery after each use or once a month if not used regularly.

- Do not charge battery upside down.

- Always secure the battery with the bracket. Battery can fall out and injure a child if vehicle tips over.

- It is parents' responsibility to check main parts of the toy before using. Must regularly examine for potential hazard, such as the battery, charge, cable or cord, plug, screws are fastening enclosure of other parts and that in the event of such damage, the toy must not be until that damage had been properly removed. Make sure the plastic parts of the vehicle are not cracked or broken.

- Occasionally use a lightweight oil to lubricate moving parts such as wheels.

- Park the vehicle indoors or cover it with a tarp to protect it from wet weather.

- Keep the vehicle away from sources of heat, such as stoves and heaters. Plastic parts may melt.

- Recharge the battery after each use. Only an adult can handle the battery. Recharge the battery at least once a month when the vehicle Raider is not being used.

- Do not wash the vehicle with a hose. Do not wash the vehicle with soap and water. Do not drive the vehicle in rainy or snowy weather. Water will damage the motor, electric system and battery.
- Clean the vehicle with a soft, dry cloth. To restore shine to plastic parts, use a non-wax furniture polish. Do not use car wax. Do not use abrasive cleaners.
- Do not drive the vehicle in loose dirt, sand or fine gravel which could damage moving parts, motors or the electric system.
- When not using, all the electrical source should be turned off. Turn off the power switch and disconnect the battery connection.

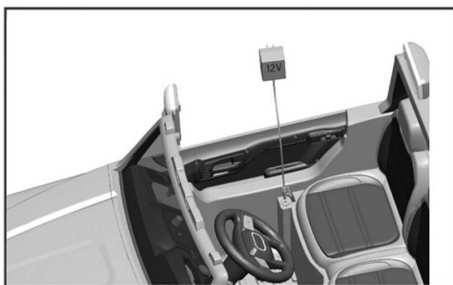

Charge the Battery

The first charge will take about 12 hours.

Tips 1:

1. Open the battery charger port (located on the seat of near by).
2. Insert the battery charger connector into the charger port.
3. Plug the **charger** into a standard 120V or 230V wall outlet. *Note:* The charger may feel warm during charging. This is normal and not a cause for concern.
4. After charging is complete (at least **8-10** hours, but not more than **twenty four hours**, with the first charge taking about 12 hours) unplug the charger from the wall outlet and unplug the battery connector from the charger port.

Tips 2: Charge the battery separately

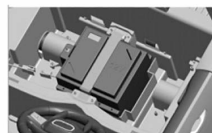

Take out the battery



Charge the battery same as tips 1.

- Plug the battery connector into the charger port.
- Plug the charger into a standard wall outlet.
- Only use the 12 volt charger to charge your 12 volt battery.
- *Note:* if power flow to the wall outlet is controlled by a switch, make sure the switch is "ON".
- Before first-time use, charge the battery for at least 12 hours. Never charge the battery longer than 24 hours.
- Recharge the battery for at least 8-10 hours after each use of your vehicle.
- Do not charge the battery longer than 24 hours.
- Do not charge or store battery upside down. Charging produces explosive gases. Charge away from flames, sparks and lit cigarettes. Charge in a well ventilated area.
- Once the battery is charged, disconnect the battery connector from the charger connector. Unplug the charger from the wall outlet. The battery is now ready to be installed in your vehicle. Please see the following Battery Installation Section for detailed instructions on installing your vehicle:



Battery Replacement

1. Lift the seat out.
2. Disconnect the battery connectors.
3. Remove the eight screws on the sides of the battery.
4. Take out lift the battery out of the battery compartments.

Parts List

6

- Please identify all parts before assembly and save all packaging material until assembly is completed to ensure that no parts are discarded.
- Metal parts have been coated with lubricant for protection during shipment. Wipe all metal parts with a paper towel to remove any excess lubricant.



Main Body X 1

Steering wheel x 1

Side mirror x 2(L/R)

Seat x 1



Front Wheel (size no.:12 hole) X 2



Rear Wheel (size no.:15 hole) X 2



Side Support Frame X 2 (L/R)



Rear Bumper Support Frame X1



Rear Window X1



Windshield x 1



Wheel cover x 4



Screw x 27
(Ø4 x 12mm)

For wheels:



Washer x 6
(Ø12 x 1.5mm)

Pin x 4



Charger x1



Manual x1

Tools needed: (Not included)



Screwdriver

Spare parts:

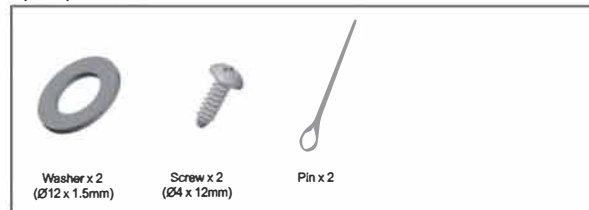

Washer x 2
(Ø12 x 1.5mm)

Screw x 2
(Ø4 x 12mm)

Pin x 2

Remote Control Operation, please read the attached manual separately.

Assembly

WARNING

Children can be harmed by small parts, sharp edges and sharp points in the vehicles unassembled state, or by electrical items. Care should be taken in unpacking and assembling the vehicle. Children should not handle parts, including the battery, or help in the assembly of the vehicle.

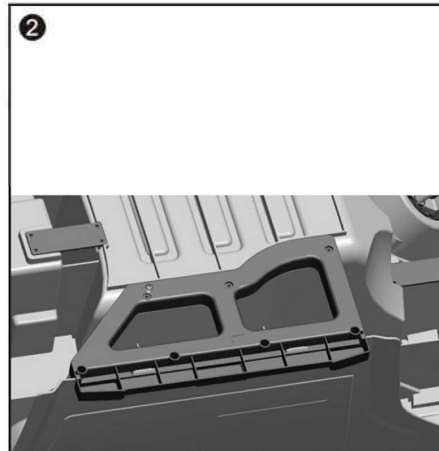
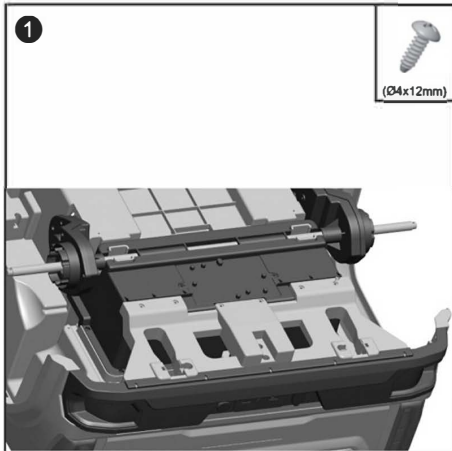

- Insert the rear bumper support frame under the main body. Fasten it with 11 screws.
- Insert the side support (left) under the main body as picture show above, and fasten it with 7 screws. (The same steps for the right)

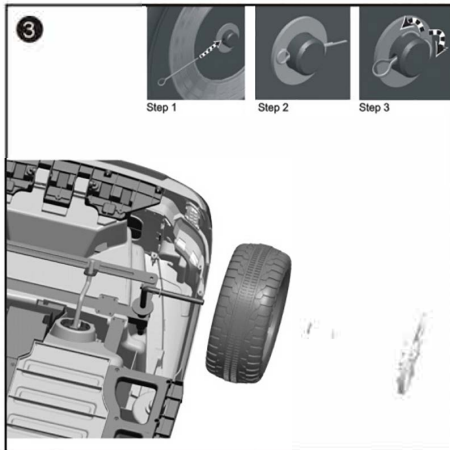

Front Wheel Assembly
Assemble all the parts in sequence as picture shown. Insert a pin to the hole of the front axle and make it into an "M" shape by a plier. "Snap" a hubcap into the center. Repeat the process for the other side.

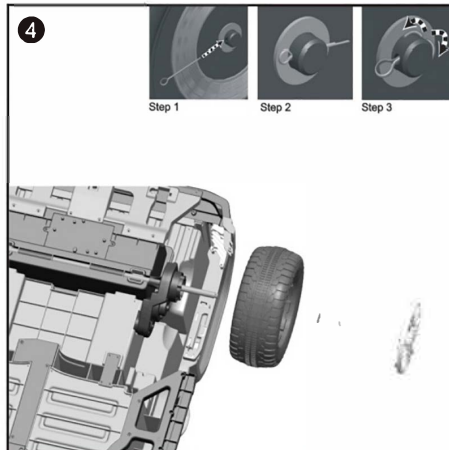

- **Rear Wheel Assembly**
Assemble all the parts in sequence as picture shown. Insert a pin to the hole of the front axle and make it into an "M" shape by a plier. "Snap" a hubcap into the center. Repeat the process for the other side.

Assembly

8

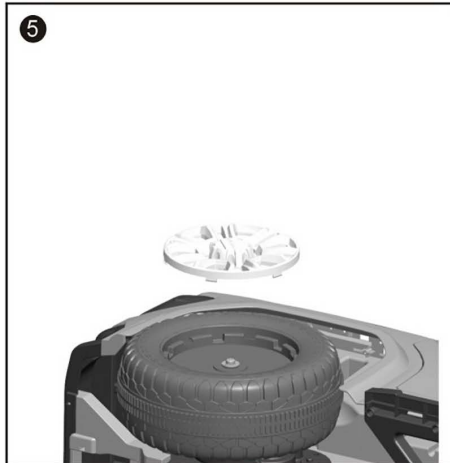

“Snap” the wheel cover into the right place, repeat the process for the other three wheels.

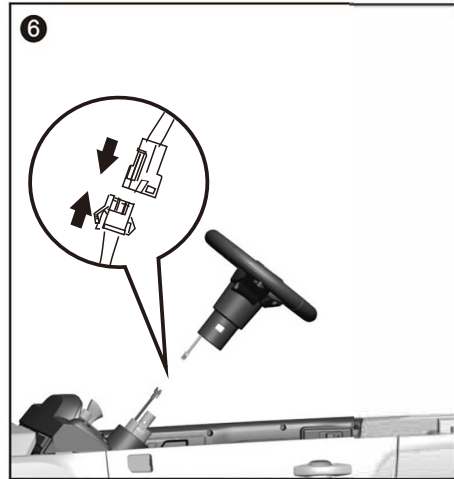

● Plug connectors. Place the steering wheel onto the turning shaft, press it to the right place.

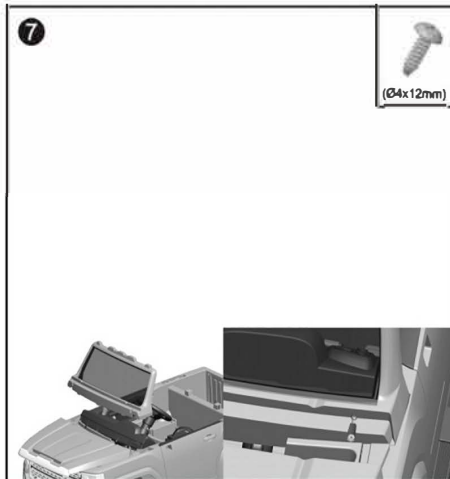

● Insert the windshield into the slots on the main body and fasten with 2 screws.

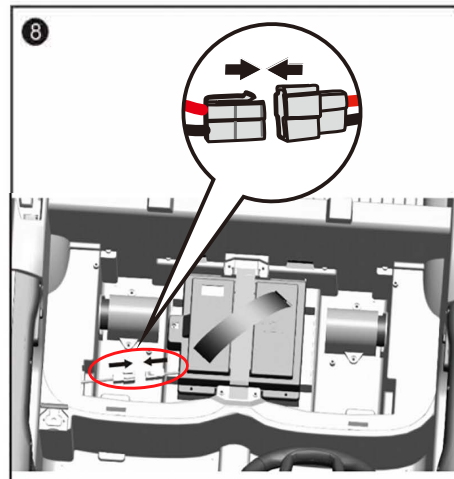

● Battery Assembly
Plug connect as the picture shows.

Assembly

9

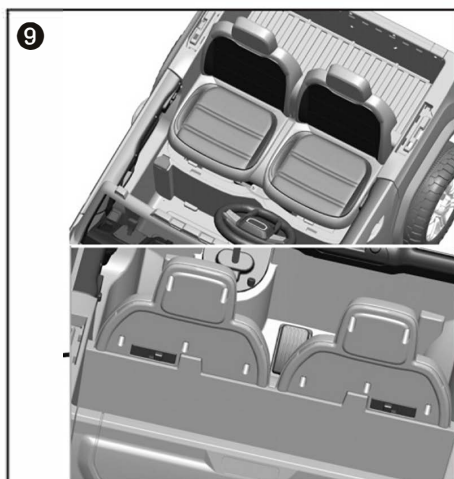

- Insert the seat to the slots of the main body. Press the backrest to the right place.



- Spot lights Assembly. Insert the light to the slot of the rear window. (picture is the right one). Repeat the process for the other one.



- Rear window Assembly. Insert the window into the slot of the main body. Press each side into the right place.

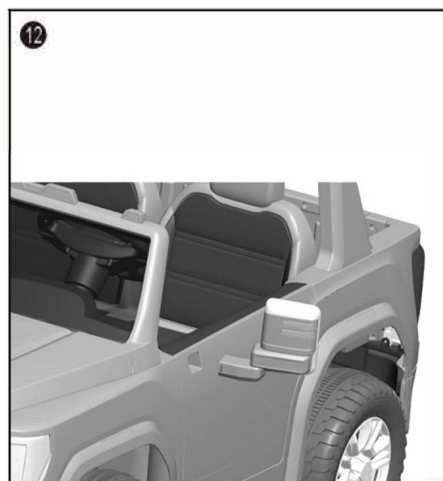

- Insert the seat into the slots of the main body. Press the backrest into the right place.

Operating your Vehicle

10

Forward

Push the shifter in downward position and press the accelerator slowly.

Reverse

Push the shifter in upward position and press the accelerator slowly.

Low speed

Vehicle has been pre-set to operate at low speed (2.5 mph, (4 kmh) maximum). Once your child has mastered safe driving skills and understands the Safe Driving Rules.

High speed

Vehicle to be driven at the higher speed (5 mph, (8 kmh) maximum) as well as the the lower speed (2.5 mph, (4 kmh) maximum).

Make sure your child can safely steer and operate the vehicle and knows the rules for safe driving.

Stop

Vehicle will automatically stop after the accelerator is released.

Sound effect

Press the buttons on the sides of the steering wheel. Each button will make a different sound effect.

Port for MP3

Turn on the power switch.
Plug in MP3 cable.
Adjust volume when need.

Safety device

AUTO POWER OFF. If the motor is overloaded for any reason, including improper usage, an electrical circuit breaker will automatically cut off the power, then resume after the parts have cooled!

Maintenance

- Clean with a dry, soft cloth only. Do not wash with water or corrosive agents.
- Store vehicle in a dry area when not in use, since moisture could cause the metal components and electrical parts to corrode.
- Remember to charge the battery monthly while the vehicle is not in regular use.
- Check and tighten all screws and coverings regularly.
- Check all plastic parts for cracks. Replace as necessary.

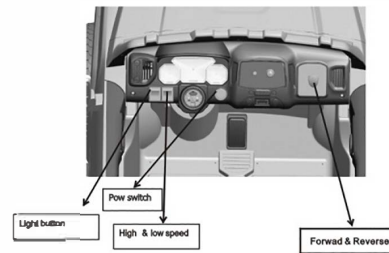

Trouble Shooting

| Problem | Possible Cause | Solution |
|--------------------------------------|----------------------------|--|
| Car does not move | Circuit breaker tripped | Circuit breaker may "trip" and stop the vehicle if it is overloaded or the driving conditions too severe. The breaker will automatically reset after approximately 10 seconds, and the vehicle will operate normally. To avoid repeated automatic shut downs, do not overload the vehicle by exceeding the weight limit of 40kg, or by towing anything behind the vehicle. Do not drive uphill or run into fixed objects, which can cause the wheels to stop spinning while power is still being supplied to the motors. |
| | Loose wire or connectors | Check all wires and connectors. Make sure that the motor harness connector is plugged in tightly to the battery, and that there are no loose wires around the motor. |
| | Dead battery | An old or improperly cared battery may be dead. |
| | Undercharged battery | A new battery should have been charged for at least 12 hours before using the vehicle for the first time. After that, it must be recharge the battery for at least 8-10 hours after each use .Never charge longer than 24 hours. Check all connectors; make sure the charger is plugged into the wall. Make sure the power flow to the outlet is on. |
| | Charger is not working | You must have a volt meter in order to tell whether the charger is working or not. |
| | Electricity switch damages | When exposed to water or moisture, electricity can become corroded, or can jam due to loose dirt, sand or gravel. |
| Car was running but suddenly stopped | Loose wire or connectors | Check all wires and connectors. Make sure that the motor harness connector is plugged into the battery tightly, and that there are no loose wires around the motor. |
| | Circuit breaker tripped | Circuit breaker may "trip" and stop the vehicle if it is overloaded or the driving conditions too severe. The breaker will automatically reset after approximately 10 seconds, and the vehicle will operate normally. To avoid repeated automatic shutdowns, do not overload the vehicle by exceeding the weight limit of 40kg, or by towing anything behind the vehicle. Do not drive uphill or run into fixed objects, which can cause the wheels to stop spinning while power is still being supplied to the motors. |

Trouble Shooting

12

| Problem | Possible Cause | Solution |
|--|---|--|
| Short operating time (less than 1 hour per charge) | Undercharged battery | A new battery should have been charged for at least 12 hours before using the vehicle for the first time. After that, it must be recharge the battery for at least 8-10 hours after each use .Never charge longer than 24 hours. Check all connectors; make sure the charger is plugged into the wall. Make sure the power flow to the outlet is on. |
| | Overcharge battery | Never charge battery longer than 24 hours. |
| | Old battery will not accept a full charge | Even with proper care, a rechargeable battery does not last forever. Average battery life is 1 to 3 years depending on vehicle use and use conditions. Replace the battery with a new 12 volt rechargeable battery. |
| Vehicle is sluggish | Undercharged battery | A new battery should have been charged for at least 12 hours before using the vehicle for the first time. After that, it must be recharge the battery for at least 8-10 hours after each use .Never charge longer than 24 hours.Check all connectors; make sure the charger is plugged into the wall. Make sure the power flow to the outlet is on. |
| | Battery needs charging | Be sure to charge the battery after each use. |
| | Old battery will not accept a full charge | Even with proper care, a rechargeable battery does not last forever. Average battery life is 1 to 3 years depending on vehicle use and use conditions. Replace the battery with a new 12 volt rechargeable battery. |
| | Vehicle is overloaded | Allow no more than 2 rider at a time, follow the 88 lbs. (40 kg) weight capacity and don't tow anything behind the vehicle. |
| | Driving conditions are too stressful | Use only on a generally level ground. |

Trouble Shooting

| Problem | Possible Cause | Solution |
|---|---|--|
| Intermittent vehicle operation | Loose wire or connector | Check all wires around the motors and all connectors to make sure they are tight. |
| When the go foot pedal is pressed, the vehicle won't run without a push | Loose wire or connector | Check all wires around the motors and all connectors to make sure they are tight. |
| Charger get warm during use | This is normal and should not be a concern. | No action required. |
| Battery makes gurgling or sizzling noise while charging | Some noise and swelling is normal and should not be a concern | No action required. If the battery does not make noise while charging. It does not mean it isn't accepting the charging. |

Parts Diagram

14

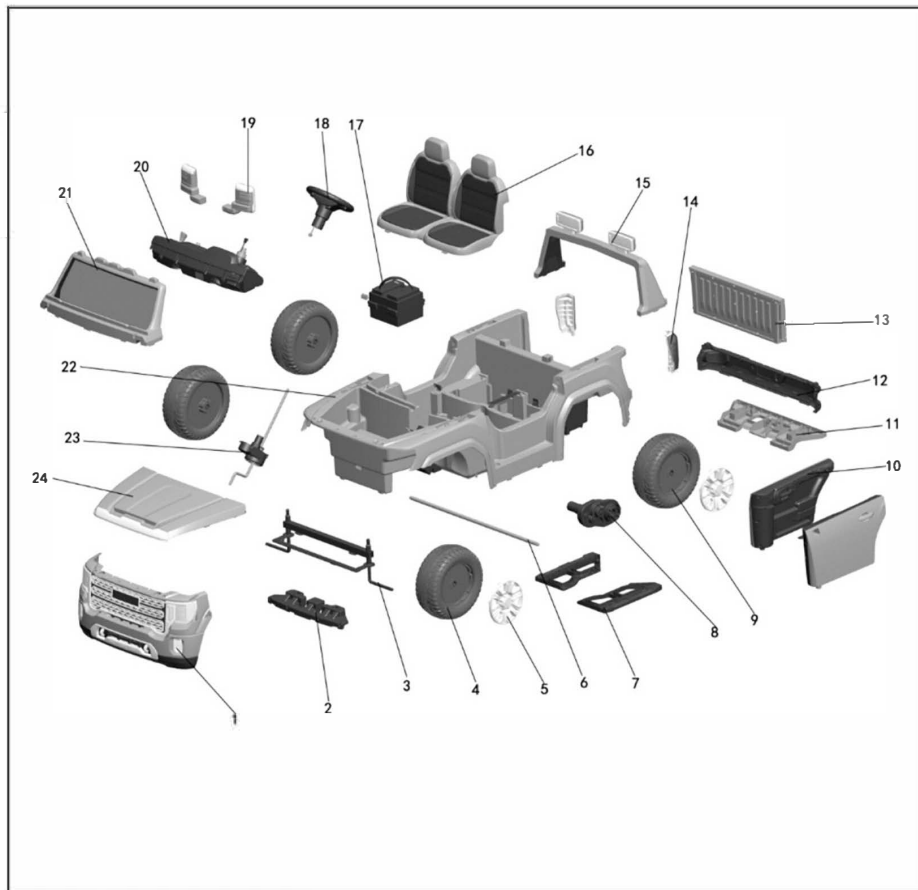

Note: Some parts shown are assembled to both sides of the vehicle.

| No. Part | Quantity | No. Part | Quantity | No. Part | Quantity |
|-----------------------------------|----------|-----------------------------------|----------|--------------------|----------|
| 1. Front Bumper | 1 | 9. Rear Wheel (size no.: 15 hole) | 2 | 17. Battery Box | 1 |
| 2. Front Support Frame | 1 | 10. Door | 2 | 18. Steering Wheel | 1 |
| 3. Front Axel Assembly | 1 | 11. Rear Bumper Support Frame | 1 | 19. Side mirror | 2 |
| 4. Front Wheel (size no.:12 hole) | 2 | 12. Rear Bumper | 1 | 20. Dashboard | 1 |
| 5. Wheel Cover | 4 | 13. Rear Door | 1 | 21. Windshield | 1 |
| 6. Rear Axel(Diameter:15mm) | 1 | 14. Rear Light | 2 | 22. Main Body | 1 |
| 7. Side Support Frame | 2 | 15. Rear Window | 1 | 24. Hood | 1 |
| 8. Drive motors | 2 | 16. Seat | 1 | | |

JR1602FCC Remote Control Manual

- (1). Supply Voltage---DC 3.0V , Battery 2*1.5V AAA (not included)
- (2). Frequency 2.407GHz-2.473GHz (Peak output power: 5dBm)
- (3). Instructions

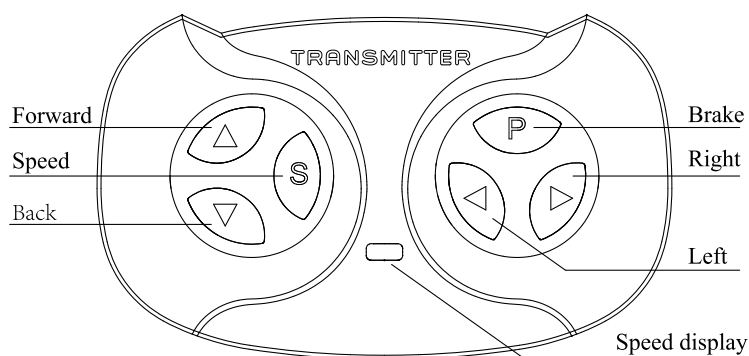

- a. First time use need to match code, this product has memory function
Replace battery is unnecessary match code
- b. Hold down “▲” & “▼” keys for 3 seconds start match code, The first LED flicker
- c. Turn on the car body power now , The first LED lit up, Match code Success
- d. Remoter 10 seconds not run will be standby ,Press any key wake up
- e. Keys caption : “▲” Forward,“▼” Back,“◀” Left,“▶” Right,“ S ”Speed,“ P ” Brake.
Press “ S ” key set up speed , 1 led lit up is low speed , 2 leds lit up is medium speed ,
3 leds lit up is high speed,
Press “ P ” key hold the brake, All LED flicker

※ The remote controller only can be used with adult's guidance

This device complies with part 15 of the FCC Rules.

Operation is subject to the following two conditions:

- (1) This device may not cause harmful interference, and
- (2) this device must accept any interference received, including interference that may cause undesired operation.

Note: This equipment has been tested and found to comply with the limits for a Class B digital device, pursuant to Part 15 of the FCC Rules. These limits are designed to provide reasonable protection against harmful interference in a residential installation. This equipment generates, uses and can radiate radio frequency energy and, if not installed and used in accordance with the instructions, may cause harmful interference to radio communications.

However, there is no guarantee that interference will not occur in a particular installation. If this equipment does cause harmful interference to radio or television reception, which can be determined by turning the equipment off and on, the user is encouraged to try to correct the interference by one or more of the following measures:

- Reorient or relocate the receiving antenna
- Increase the separation between the equipment and receiver.
- Connect the equipment into an outlet on a circuit different from that to which the receiver is connected.
- Consult the dealer or an experienced radio/TV technician for help.

Warning: Changes or modifications to this unit not expressly approved by the part responsible for compliance could void the user's authority to operate the equipment.

FCC Radiation Exposure Statement

The device has been evaluated to meet general RF exposure requirement.
The device can be used in portable exposure condition without restriction.