

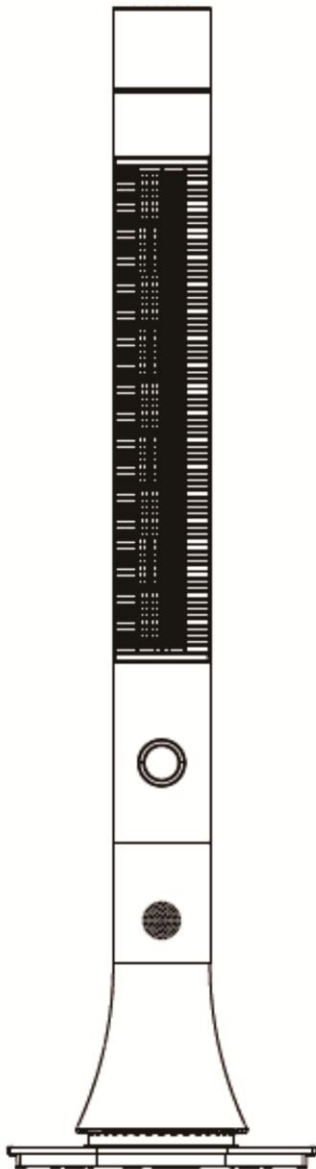

INcjh037\_US

**824-044V80**



**IMPORTANT, RETAIN FOR FUTURE REFERENCE: READ CAREFULLY**

# ASSEMBLY & INSTRUCTION MANUAL

## FUNCTIONS & OPERATION

Put the plug into the socket, products in standby mode, power lamp light on the display panel.

**ON/OFF button:** Push it to start working, fan works in middle speed. Display panel shows the room temperature. Indicator light shows on/off at the display panel.

**SPEED button:** Push this button to set from LOW-MIDDLE-HIGH.Indicator light shows on the display.

**SWING button :** Push it to oscillate the fan, push it again to stop the function. Indicator light shows on/off at the display panel.

**TIMER button:** Push it to set from 00-12 hours.Display panel shows the timer numbers and.Indicator light shows on/off at the display panel.

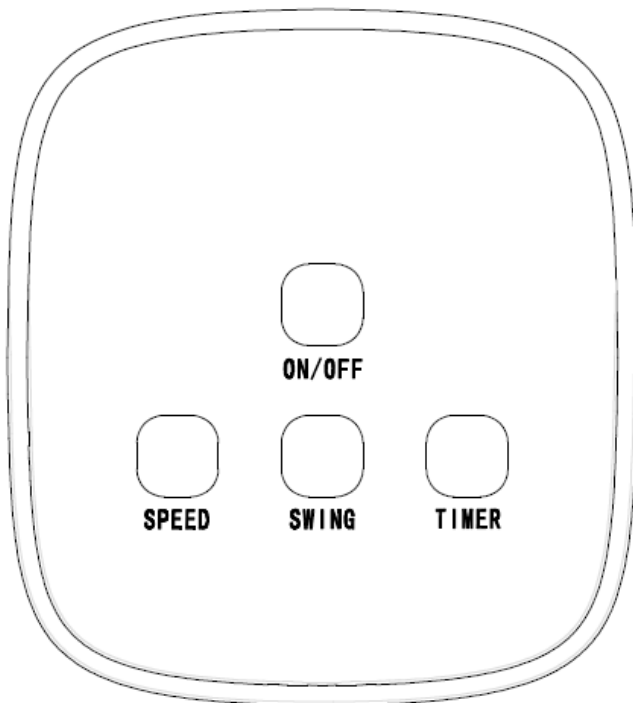

## REMOTE CONTROL

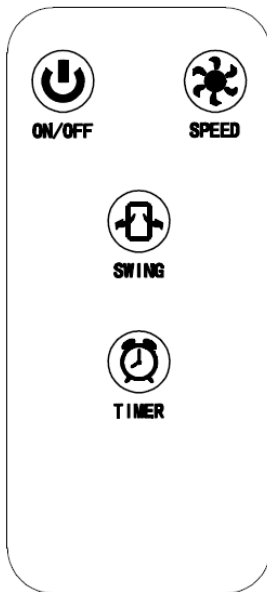

The function is same as on control panel

The remote control use one button cells, model No. CR2025 (3V). We recommend the use of Lithium type battery for longer use.

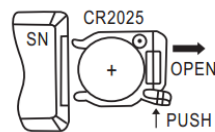
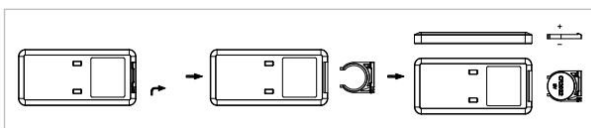

**Note:** Please follow battery disposal instruction on battery packaging, or contact your local councils for safely disposal of batteries.

## ASSEMBLING

Step 1 : Make sure four hole of front and back base in straight alignment, Put hole of back base insert to cylinder of front base.

Step 2 : Take out the power cord from the central of base

Step 3 : Assembled base of central have four pieces of screw hole which fix into the screw holes of body ,use 4 pieces of tapping screw, fix closely the body and base. Finally take the power cord into the line hole.

Step 4 : Put the fan flatly

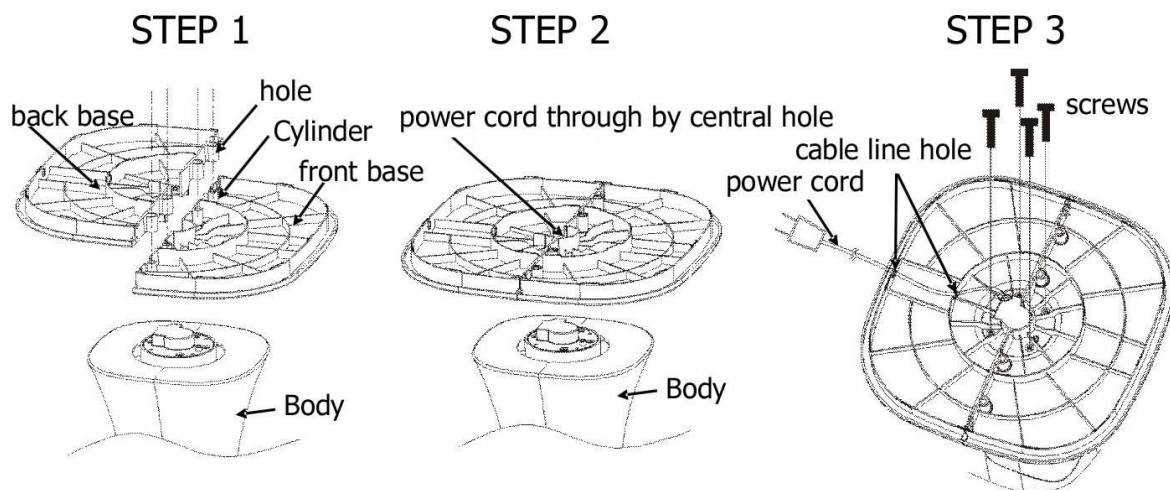

## CAUTION

1. Use as per the rating voltage.
2. Do not repair or remake the appliance by yourself, it should be repaired by the repairmen.
3. Do not operate the appliance with wet hands, in order to avoid damage.
4. If the supply cord is damaged, it must be replaced by a same cord from the manufacturer or its service agents.
5. When the appliance is not in use, switch it off and unplug it.
6. Do not insert things to air outlets and inlets, in order to avoid damage.
7. Do not use the appliance near explosive and combustible gas.
8. Use the appliance only on a flat surface.
9. Do not use outdoors.
10. Do not turnover the appliance. Unplug the power supply If it is toppled over and there have some water in the body. Dry the body before use.
13. Clean the appearance with a lightly damp cloth. It can clean with neutral detergents. Do not rinse with water.
14. Do not make air outlets and inlets near the wall or curtain.

15. Do not knock or shake the body when use, otherwise it may cause stop.

17. The appliance must not be located immediately below a socket outlet.

The rating current of socket should exceed 10A.

18. Do not use the appliance in the immediate surrounding of a bath, a shower or a swimming pool.

19. This appliance is not intended for use by persons including children with reduced physical, sensory or mental capabilities or lack of experience and knowledge unless they have been given supervision or instruction concerning use of the appliance by a person responsible for their safety.

20. Children should be supervised to ensure that they do not play with the appliance.

## **CLEANING AND MAINTENANCE**

Clean with neutral detergent and soft cloth.

Attention: unplug the power plug when clean the appliance, since there is high pressure in the body. Do not leave any water on the control panel.

## **ACCESSORY**

Screws for assemble the base ; Remote control