

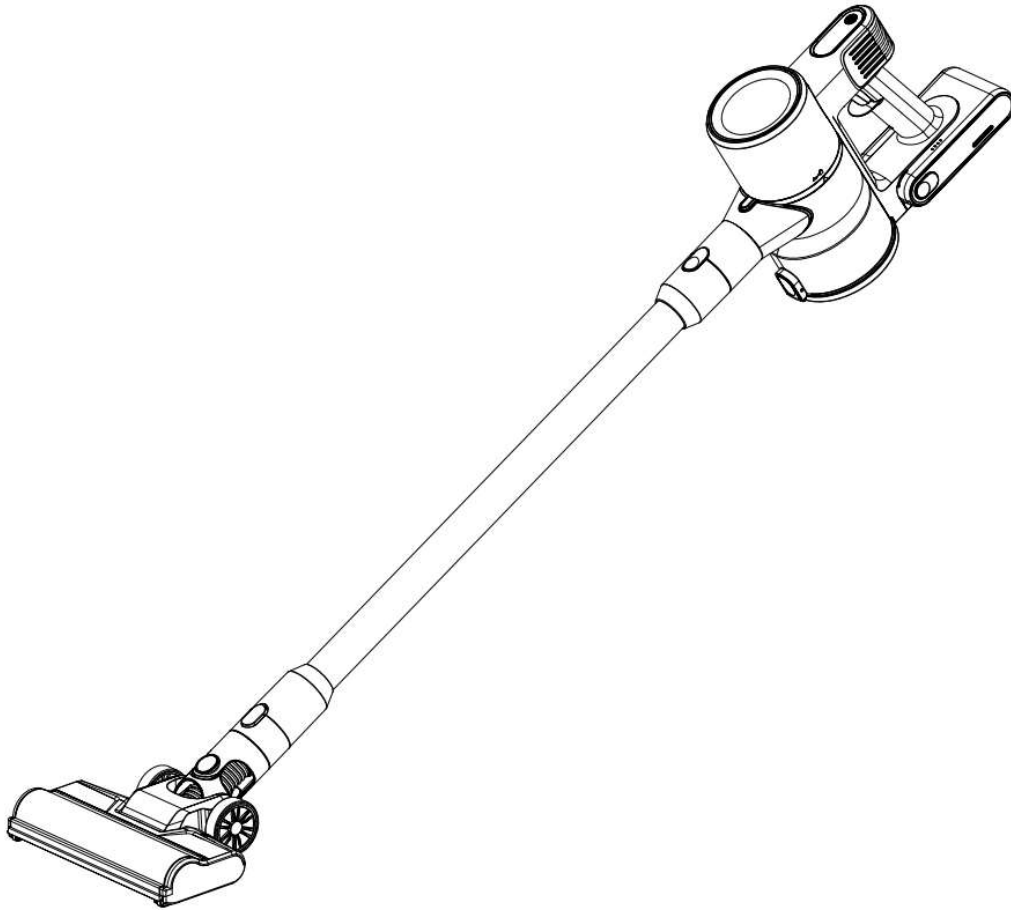

IN231100221V01\_UK

**852-020V70**



## **VC-6003 Manual for handheld vacuum**

AC 100V-240V 50/60Hz

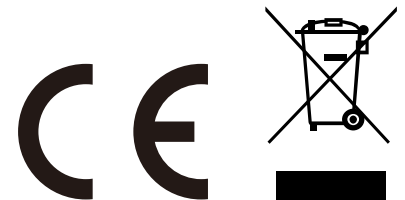

**IMPORTANT, RETAIN FOR FUTURE REFERENCE: READ CAREFULLY**

# **ASSEMBLY INSTRUCTION**

## Safety instructions

To avoid electric shocks, fires and other injuries caused by improper use, read this entire manual carefully.

- Under guided supervision, children aged eight years and above can use this appliance, provided they understand the potential risks and hazards. Under guided supervision, persons with disabilities or persons without experience can use this appliance, provided they understand the potential risks and hazards. Children must not play with this appliance.
- Do not use outdoors or in wet places. Use only on dry indoor surfaces. Do not touch the plug or any part of the product with wet hands.
- To prevent a fire, explosion or injury, check the lithium battery and power adapter for any damages before use. Do not use this vacuum cleaner with a damaged lithium battery or power adapter.
- The roller brush, battery, extension rod and host of the vacuum cleaner are live parts. Do not immerse in water or other liquids for cleaning. After daily cleaning, ensure that all filters are thoroughly dry.
- To protect users from the rotating brush head, close the host before cleaning the rolling brush. Do not turn on the host if the rolling brush, dust cup and filter are not installed correctly.
- Only use the power adapter provided by the manufacturer. Using an unofficial adapter, not recommended by the manufacturer, can cause the lithium battery to set on fire.
- Do not use absorbent, gasoline and other flammable or explosive liquids. Do not vacuum chlorine bleach, ammonia, sewer cleaner or other toxic solutions.
- Do not vacuum drywall ash, fireplace ash and ash. Do not vacuum smoking or burning objects, such as charcoal, cigarette butts or matches.
- To prevent damaging your vacuum cleaner, do not vacuum glass, nails, screws, coins or other hard or sharp objects.
- Keep hair, loose clothing, fingers and other body parts away from air passages and moving parts of the product. Do not point the suction tubes, tubular extension handles or tools at the eyes, ears or mouth.
- Do not place objects on the suction nozzle. Do not use the vacuum cleaner if the suction nozzle is blocked. Dust, cotton, wool, hair or other debris can weaken the airflow – ensure it is cleaned before using.
- To prevent damaging this vacuum cleaner, avoid placing it on chairs, dining tables or other unstable surfaces. If the vacuum cleaner falls, gets damaged or exhibits any other issues, promptly contact authorised service personnel for maintenance. Do not attempt to disassemble the vacuum cleaner yourself.
- Strictly follow the charging instructions in the manual. Charging the battery outside the specified temperature range can lead to battery damage.
- Only use company-recommended accessories and replacements.
- Before maintenance, cleaning or if the floor brush will not be used for long periods, ensure you turn off the power.
- When not in use for long periods, ensure the vacuum cleaner is fully charged, remove the battery, unplug the power adapter plug and store it in a cool, dry place. Avoid direct sunlight and humid conditions. To prevent battery damage, charge the vacuum cleaner at least every three months.
- Be extra careful when vacuuming stairs.
- Do not install, charge or use this product outdoors, in the bathroom or around the swimming pool.
- Warning: Do not use scented products on the filter of this device. The chemicals in these products are flammable and may ignite the device, posing a fire hazard.
- This product is designed for home use only.

## Product presentation

### List of accessories

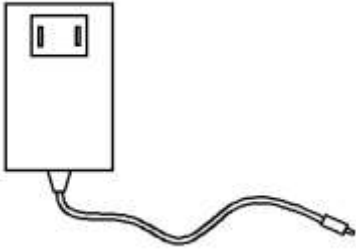

Power adapter

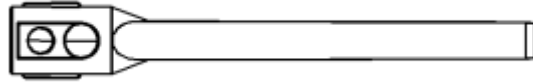

Long flat suction

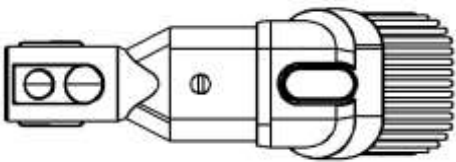

Two-in-one flat suction

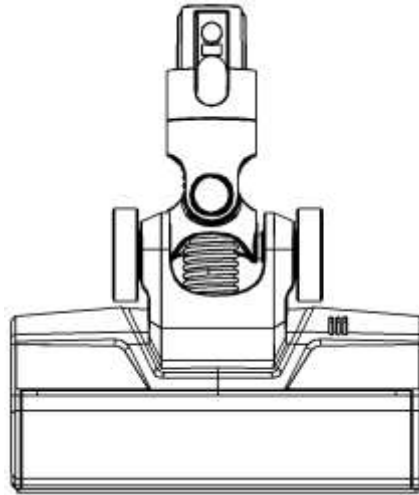

Electric floor brush

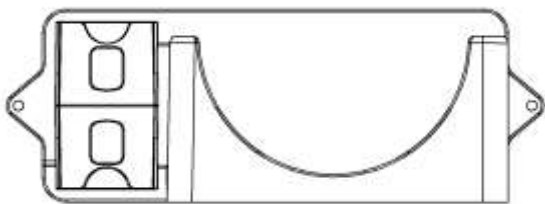

Host mount with screw \* 3 \* 3,  
expansion pipe



Extension tube

# Product presentation

## Host component description

Display indicates the following:

- Battery status with charge and discharge percentage.
- Alarm for the main motor plug.
- Alarm for a jam in the ground brush motor.

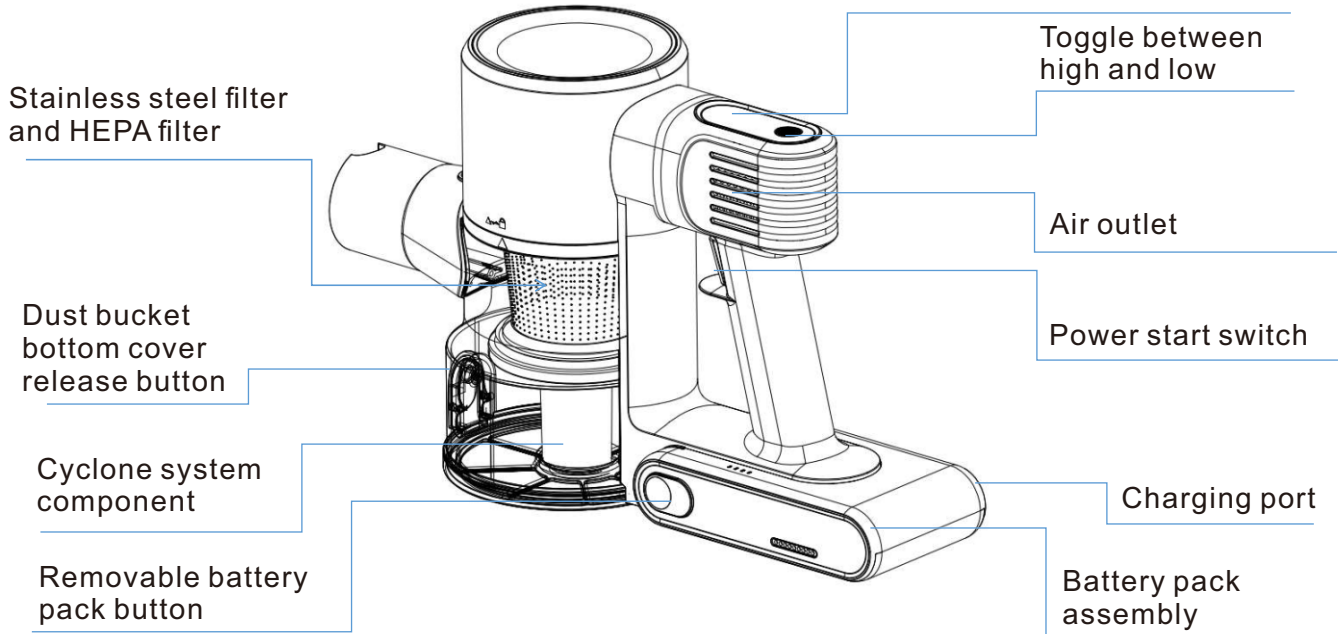

## Install

### Installation drawing of host and accessories

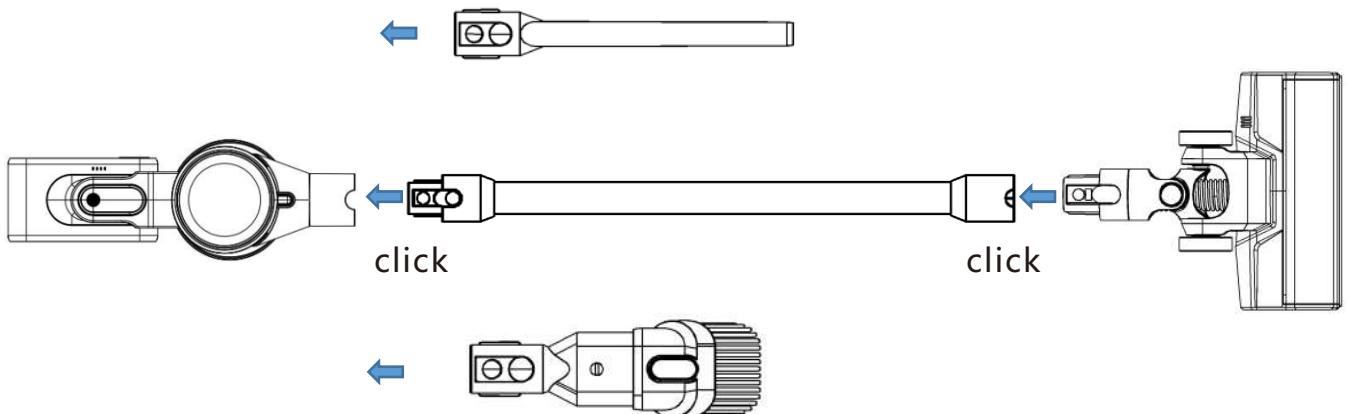

# Install

## Mounting the host

1. The host mounting base is optional. You can decide whether to install it based on your specific needs.
2. For installation, choose a cool and dry location with a nearby power supply. Avoid placing the support in areas prone to humidity, like the kitchen, or direct sunlight.
3. Use appropriate wall mounting hardware to securely install the base. Ensure there are no pipes (gas, water or ventilation), cables, wires or sewer lines directly behind the installation area.
4. It is recommended to seek the assistance of professional personnel for equipment installation. When necessary, use protective clothing, goggles and other safety gear.
5. Using an electric drill, start by drilling an 8mm diameter hole approximately 30mm deep in the wall. Then, insert an expansion tube into the hole and secure the host mounting base to the wall using screws.

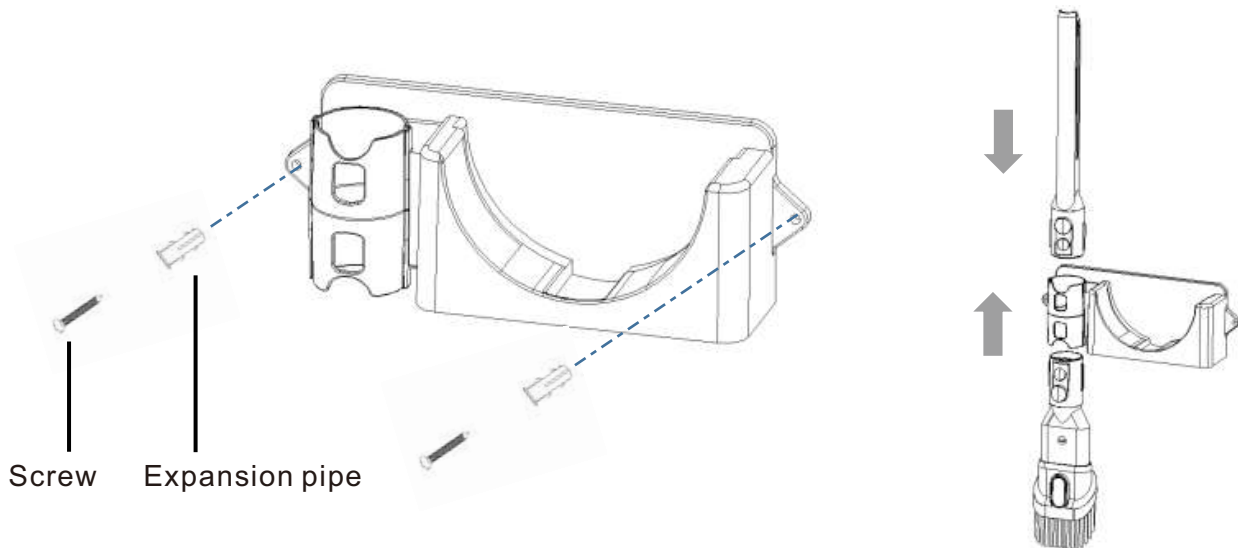

Recommended installation height: 1.06m above the ground, along the lower edge of the support.

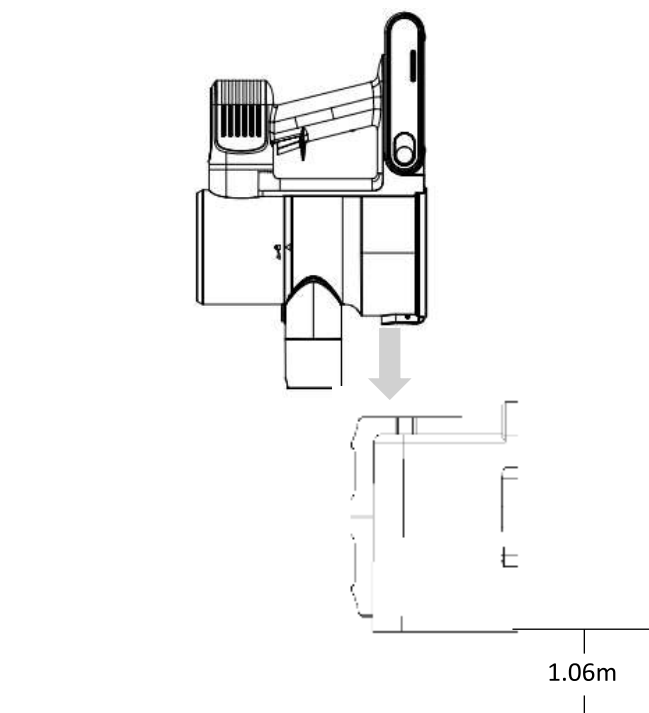

# Use

## Recharge

### Battery LED status indicator

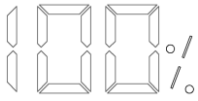

Means full charge

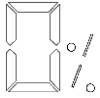

Means no electricity

(After 5 minutes of full charge, the host enters the power saving mode)

Before charging, read the 'Safety instructions' section in this manual.

### Reminder:

1. Before using for the first time, ensure the battery is fully charged. The charging time is approximately 4-5 hours.
2. While charging, do not start or use this vacuum cleaner.
3. After continuous usage in the strong mode, the battery temperature may rise, potentially leading to longer charging times. It is recommended to allow the device to cool down for 30 minutes before charging.
4. While charging, you can charge the entire device, including the battery module, or you can remove the battery module and charge it separately.
5. Only use the power supply included with the device.(CZH013270050EUWP)
6. Only use the battery pack provided with this appliance.  
(Model: VC-6003)
7. To remove the battery pack, press down on the battery pack release button, then slide the battery pack to the right, following the illustration.

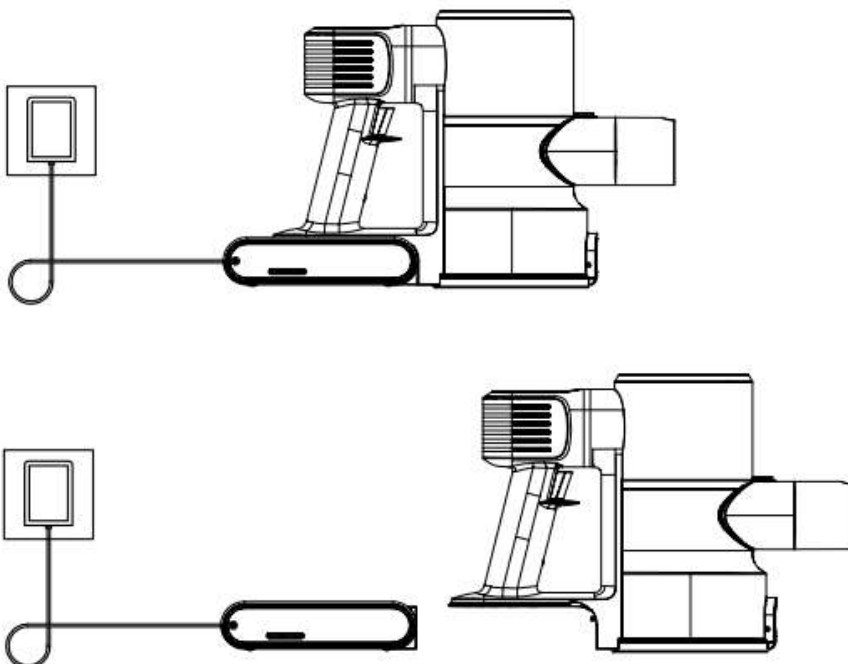

## Use

1. Two-in-one brush: Suitable for beds, sofas and other cloth materials, particularly for removing dust.

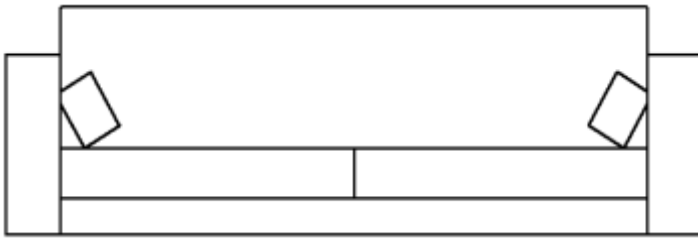

2. Flat brush: Suitable for cleaning narrow gaps, tight spaces and hard-to-reach areas like crevices, door and window corners, stairs and other confined spaces.

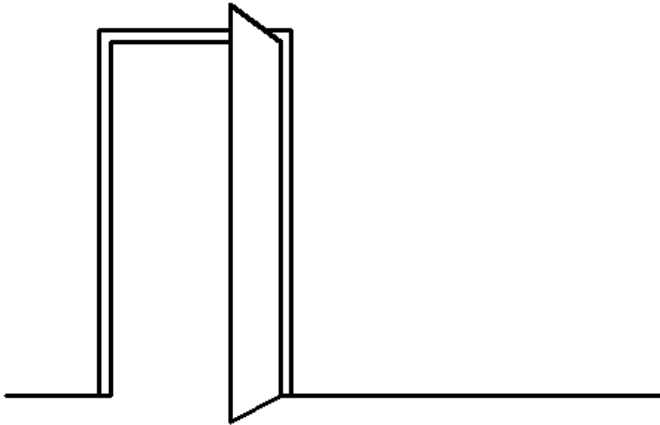

3. Fuzzy rolling brush: Suitable for cleaning floors, tiles, marble floors and other hard surfaces. It is particularly useful for removing larger particles of dust. You can also directly attach the fluff roller brush to the main unit.

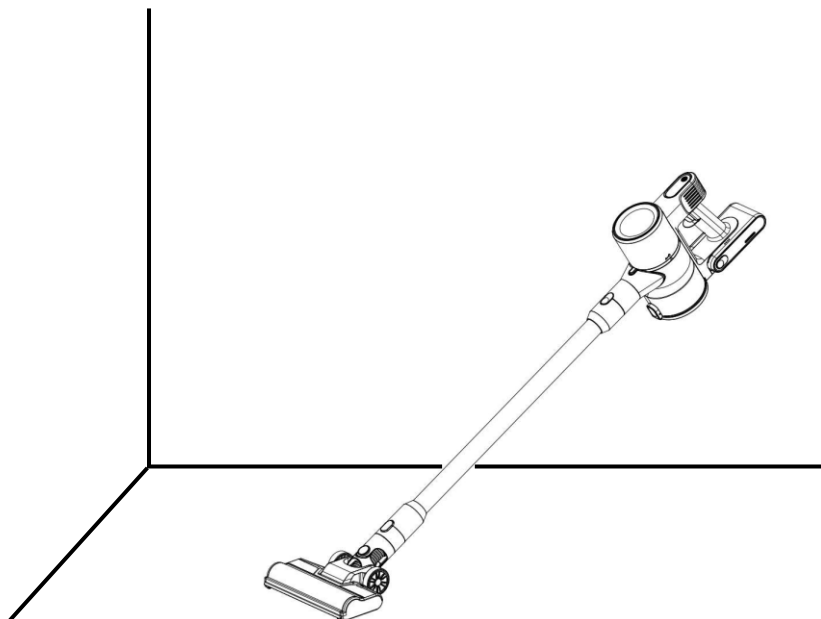

## Care and maintenance

Pay attention to product maintenance

1. Make sure you are using original parts, otherwise, you may void your warranty.
2. If the brush intermittently stops after a few working cycles due to the filter components becoming clogged, clean the filter components, starting with the first level. After cleaning, restart the host for normal operation.
3. If not in use for long periods, ensure the vacuum cleaner is fully charged, then unplug the power adapter and store it in a cool, dry place. Keep it out of direct sunlight and humid conditions. To avoid battery damage, charge it at least every three months.

### Cleaning the main engine

Wipe the host with a soft and dry cloth.

### Cleaning the dust bucket

Before cleaning the dust bucket, ensure the power adapter is disconnected – be cautious not to accidentally start the vacuum cleaner by touching the switch. It is important to clean the dust bucket promptly when it reaches the MAX mark. Excessive dust can affect the vacuuming efficiency. Here are the steps for cleaning:

1. For solid debris, press the dust bucket's bottom lid release button to empty the accumulated dust from the bucket.
2. Clean the inner walls of the dust-collecting barrel, using a soft cloth or paper towel to wipe away the dust.

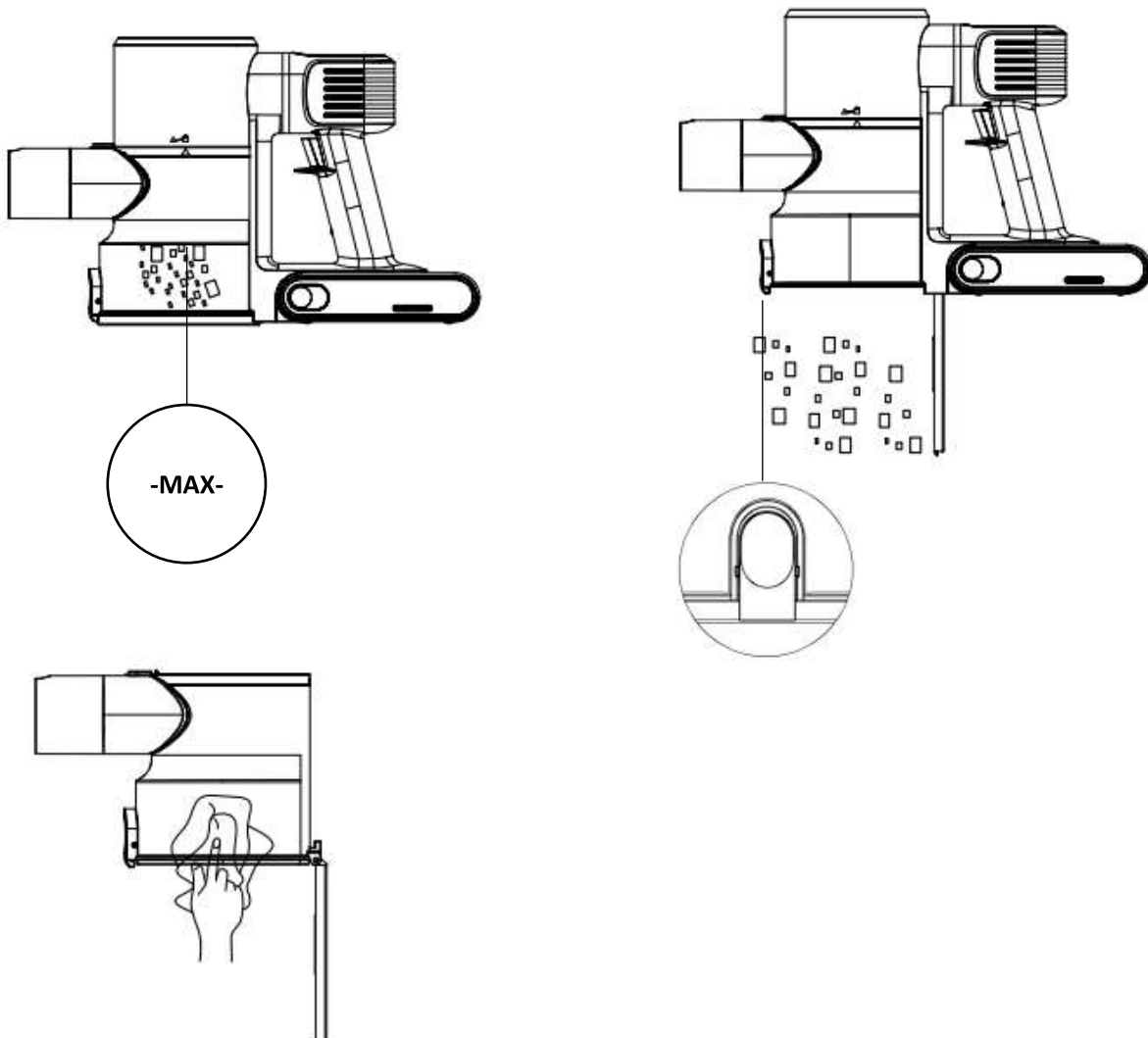



## Care and maintenance

### Cleaning the cyclone system and HEPA filter components

1. Press the button in the direction shown, turn the dust cup assembly to unlock, and then take out the dust cup filter assembly.

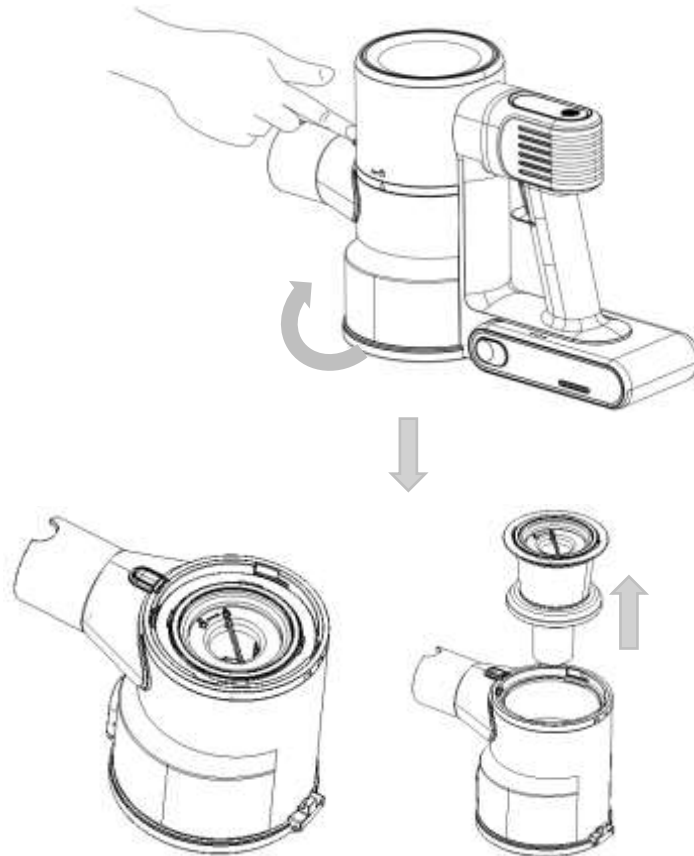

2. Rinse the cyclone system components until clean. After cleaning, let them dry for at least 24 hours. When cleaning the HEPA filter, rinse it with clean water and rotate it 360° to ensure all dust is removed from the crevices. Gently tap it against the sink to dislodge any remaining dust. Air the HEPA filter assembly for 24 hours until it is completely dry, then reinstall it into the filter system.

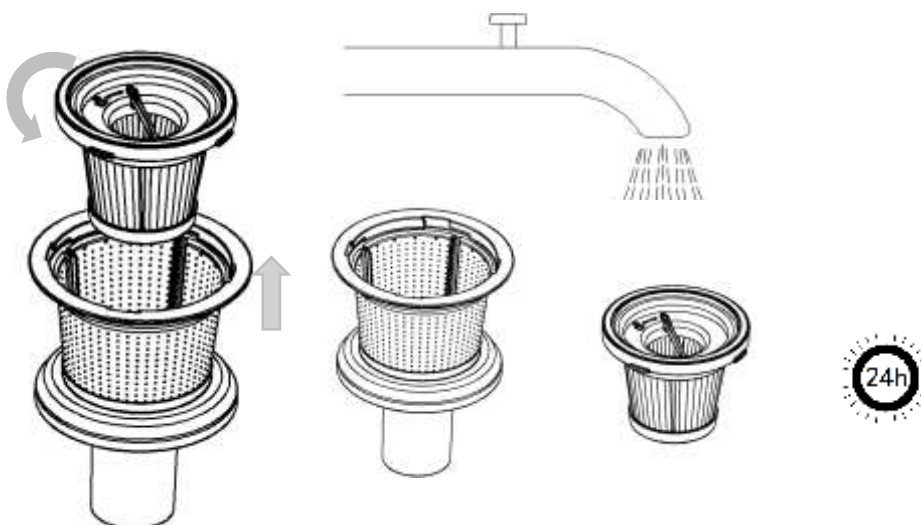

3. Allow to dry and then reinstall the selected air system assembly.

**Note:** Do not place cyclone or HEPA components in a dishwasher or washing machine for cleaning. Avoid drying them in a dryer, oven, microwave or near an open flame.

## Care and maintenance

### Cleaning floor brush

Note: Before removing the floor brush, ensure it is detached from the host machine to prevent accidentally turning on the vacuum cleaner and avoiding injury. Do not use water to clean the floor brush as it contains electrical components. Be cautious of sharp objects when removing debris entangled around the brush head.

### Cleaning roller brush

1. Press the release button on the brush head in the direction of the arrow. Remove one side of the brush head cover, then slide it off the notch to access and clean the brush head, as shown in the diagram.

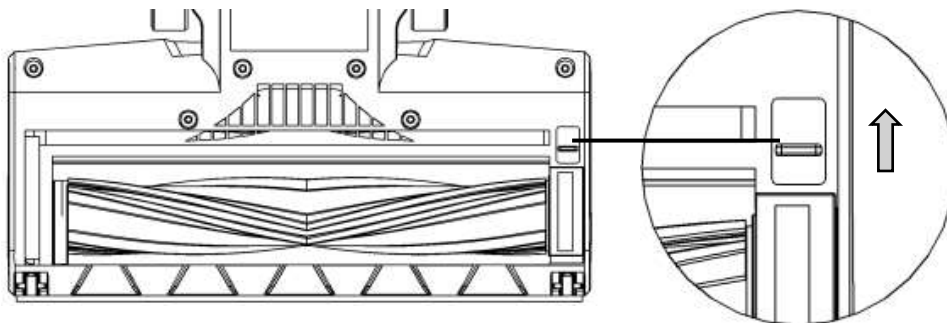
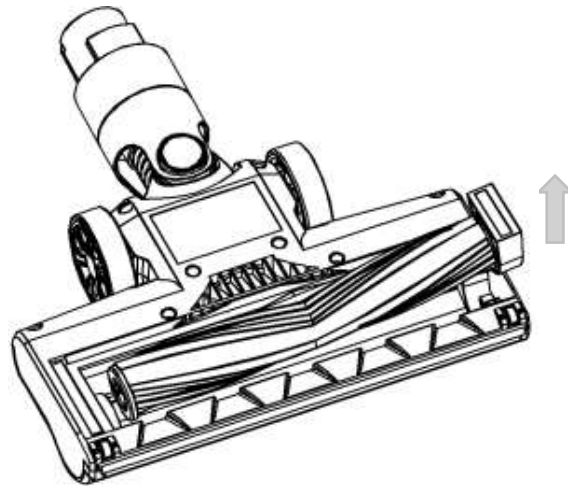

2. Use scissors to lift and cut off any hair and debris that are stuck to the brush head.
3. Once finished cleaning, reassemble the components.



## Basic parameter

### Master

<b>Model</b>	<b>VC-6003</b>
Shape size	345x118x210mm
Battery capacity	2200mAh
Net Weight	1.3kg
Dust cup capacity	0.5L
Nominal voltage	22.2V
Rated power	250W

<b>Electric floor brush</b>	
Model	FB-01
Nominal voltage	22.2V
Rated power	15W

Executive standard: GB4706.1 GB4706.7 GB4343.1 GB17625.1 IEC 62133-2:2017  
GB\_T 20291.1-2014

## The name and content of harmful substances in the product

Name of parts	Hazardous substance					
	Pb	Hg	Cd	Cr (VI)	PBB	PBDE
PCB	×	○	○	○	○	○
Metal parts	×	○	○	○	○	○
Shell	○	○	○	○	○	○
Battery	×	○	○	○	○	○
Another accessory	○	○	○	○	○	○

This form is prepared in accordance with the requirements of SJ/T11364.

○ Indicates that the materials in this part contain safe levels of hazardous substances according to GB/T26572.

×

Indicates that there is an excessive concentration of hazardous substances in at least one part of the material compared to GB/T26572 limits.

The number on this label signifies that the product has an environmental protection life of 10 years under normal use conditions.



The appliance contains rechargeable lithium batteries. Proper disposal is crucial to protect the environment. Before discarding the appliance, follow these steps:

- \* Ensure the appliance is powered off, and if possible, fully deplete the battery before removal. Then, unscrew the screws securing the bottom cover of the appliance.
- \* Carefully separate the battery components, taking care not to damage the battery shell to avoid potential hazards.
- \* The symbol on this appliance indicates it should not be treated as household waste. Instead, take it to a designated collection point for the recycling of electrical and electronic equipment. Disposal should comply with local environmental regulations of waste disposal. For more detailed information on how to treat, recover and recycle this appliance, contact your local city office, household waste disposal service or the shop where you purchased this appliance.



## Frequently asked question

If your vacuum cleaner displays an abnormal condition, refer to the following table for guidance on how to address the issue:

<b>Fault display code</b>	<b>Possible cause</b>	<b>Solution</b>
E0	The dust cup is full and has blocked the suction.	Clean the dust cup of accumulated debris or clear any foreign objects from the suction entrance or passage.
E1	Foreign objects are causing issues with the floor brush.	Clear foreign objects from the roller brush, then restart the appliance.
E2	Short motor test.	Please contact our after-sales service for repair.
E3	Brush short circuit.	Please contact our after-sales service for repair.
E4	Main motor overcurrent.	Please contact our after-sales service for repair.
E5	The battery discharge temperature is too high.	Wait until the battery temperature returns to normal.
E6	Cell damage NTC detection failure.	Please contact our after-sales service for repair.
EE	The charger voltage does not conform to the original configuration.	Replace the original charger.
EF	Overcurrent detection during charging, possibly caused by overdischarge of battery.	Please contact our after-sales service for repair.

## Frequently asked question

If the vacuum cleaner does not work properly, please refer to the following table to handle the abnormal situation.

Common faults	Possible cause	Solution
Vacuum cleaner not working.	The battery is dead or low.	Please charge the product.
	Automatic protection is activated due to overheating caused by blockage.	Allow the product to cool down for 30 minutes before restarting.
	The suction inlet or channel is blocked.	Remove any foreign objects from the suction inlet or channel.
The product suction is weak.	Dust cup is full and the HEPA filter assembly is clogged with dust.	Clean the dust cup and the HEPA filter assembly.
	Fittings suction is blocked.	Remove any foreign objects from the fittings suction.
The motor is making strange noises.	A blockage in the suction inlet, caused by hard objects, potentially leading to motor damage.	Clear obstructions from the suction inlet or channel, but do not attempt cleaning while the product is in use.
The host startup dust indicator light is red  , whilst the display screen shows 'E0' with blinking.	The dust cup is full and has blocked the suction.	Clean the dust cup.
The host startup bar indicator light is red  , whilst the display screen shows 'E0' with blinking.	The floor brush is not working because there is something tangled around the roller bar.	Clear obstructions from the roller brush, then restart the device.
'EE' blinks when the host is charging.	The charger voltage does not match the original specifications.	Replace the original charger.
The battery display light does not appear when charging.	The host is not connected to the adapter jack properly.	Ensure the power supply is properly plugged in.
The product is undercharged.	The battery temperature is low or high.	Wait until the battery temperature returns to normal before charging.

## Service

If issues mentioned above persist, even after attempting to address them, please contact our after-sales service.

**If you have any questions, please contact our customer care centre.  
Our contact details are below:**



0044-800-240-4004



[enquiries@mhstar.co.uk](mailto:enquiries@mhstar.co.uk)

IMPORTER ADDRESS:

MH STAR UK LTD

Unit 27, Perivale Park,

Horsenden lane South

Perivale, UB6 7RH

MADE IN CHINA

