

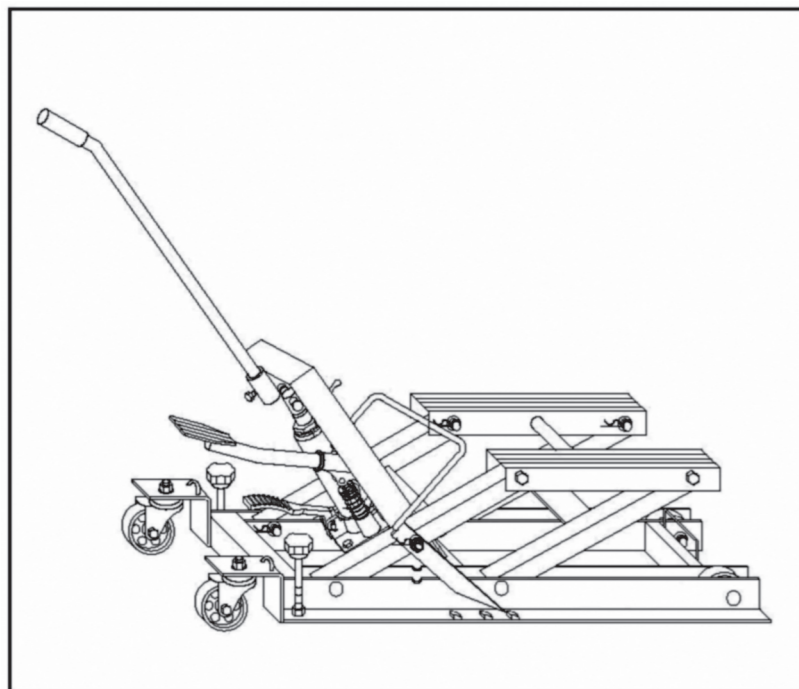

Motorcycle /ATV Jack

680KGS/1500LBS lift capacity

C30-010 EN C000000



Operating Instructions and Assembly Instructions

CAUTION: Before using this product, read this manual and follow all Safety Rules and Operational Instructions.

- (f) Immediately after lifting load, ensure lift mechanical load holding means is engaged
- (g) Before moving, lower the load to the lowest possible point
- (h) Secure load with appropriate restraint device
- (i) Failure to heed these markings may result in personal injury and/or property damage.

SAFETY MESSAGES

- (a) Use this product is limited to lifting, lowering, transporting, and storing in the lowered position, Loads consisting of a single motor vehicle whose lift points are compatible with the lift platform. Incompatibility is evident when the loaded vehicle wobbles, appears unstable, and /or does not securely engaged the lift platform.
- (b) Restraining an incompatible load will not make the load secure and may cause unexpected loss of load.
- (c) Never work on, around or under a load that is not secured and stable.
- (d) Keep operator's and bystander's head, hands and feet away from lift members when raising and lowering.
- (e) No alterations shall be made to this product.
- (f) Only attachment and/or adapters supplied by the manufacturer shall be used.

PARTS LIST

PART NO.	DESCRIPTION	QTY	PART NO.	DESCRIPTION	QTY
A	Base	1	1	Washer 8	2
B	Link	1	2	Spring Washer 8	2
C	Lift Saddle	2	3	Bolt M8x30	2
D	Connecting Rod	1	4	Bolt M8x25	2
E	Handle	1	5	Locking Rod 15x80	2
F	Locking Screw	2	6	Washer 16	2
G	Return Spring	1	7	Locking Pin	2
H	Hydraulic Ram	1	8	Bolt M5x25	1
I	Foot Pedal Assembly	1			
J	Release Pedal	1			
K	Swivel Caster	2			
L	Safety Lock	2			
M	Front Wheel Assembly	2			
N	Loops	1			
O	Clip Nut	1			

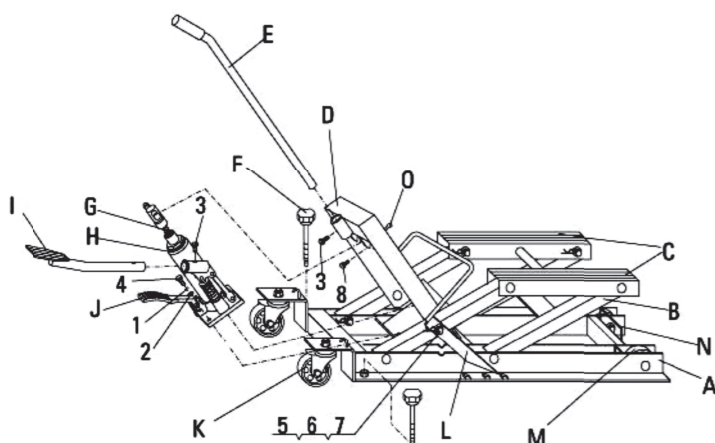

Owner and/or Operator Responsibility

The owner and/or operator shall study the product instructions and retain them for future reference.

Operation

The owner and/or operator shall have an understanding of the product, its operating characteristics, and safety operating instructions before operating the jack. Safety information shall be emphasized and understood. If the operator is not fluent in English, the product and safety instructions shall be read to and discussed with the operator in the operator's native language by the purchaser/owner or his designee, making sure that the operator comprehends their contents.

Maintenance

- The jack shall be maintained in accordance with the product instruction.
1. When jack is not in use, lifting arm should be in full down position.
 2. Always keep jack clean and keep the screw and bearings well lubricated.
 3. Keep moving parts clean; lubricate moving parts every 3 months.

Inspection

- (a) Visual inspection shall be made before each use of the jack by checking for abnormal conditions, such as cracked welds, leaks, and damaged, loose, or missing parts.
- (b) Other inspections shall be made per product operating instructions.
- (c) Each jack shall be inspected immediately if the device is believed to have been subjected to an abnormal load or shock. It is recommended that this inspection be made by a manufacturer's or supplier's authorized repair facility.
- (d) Owners and/or operators should be aware that repair of this equipment may require specialized knowledge and facilities. It is recommended that an annual inspection of the be made by a manufacturer's or supplier's authorized repair facility and that any defective parts, decals, or safety labels or signs be replaced with manufacturer's or supplier's specified parts. A list of authorized repair facilities is available from the manufacturer or supplier.

Damaged Equipment

Any jack that appears to be damaged in any way, is found to be worn or operates abnormally SHALL BE REMOVED FROM SERVICE UNTIL REPAIRED. It is recommended that necessary repairs be made by a manufacturer's or supplier's authorized repair facility if repairs are permitted by the manufacturer or supplier.

Alterations

Because of potential hazards associated with this type of equipment, no alterations shall be made to the product.

Attachments and Adaptors

Only attachments and/or adaptors supplied by the manufacturer shall be used.



- (a) Study, understand and follow all instructions before operating this device.
- (b) Do not exceed rated capacity.
- (c) Use only on hard, level surfaces.
- (d) Center load on lift platform
- (e) Lift only those areas of the automotive vehicle specified by its manufacturer

ASSEMBLY INSTRUCTIONS

1. Place hydraulic ram (# H) onto the base (#A) using (2) M8 X 25 hex bolt (#4) . (2) spring washer(#2). (2) washer (#1) .and using bolt M5 X 25 (#8)to fix ram to connecting rod (#D) then tighten.
2. Insert foot pedal (#I) to the hydraulic ram (#H), and secure using M8 X 30 bolt (#3).
3. Place safety lock operation rod (#L) insert to link (#B) using (2) washer (#6) , (2) locking pin (#7) and locking rod (#5).
4. Insert handle (#E) to connecting rod (#D) using bolt M8 X 30 (#3).
5. Ensure that all connections are tightened

OPERATING INSTRUCTIONS

See drawing on page 3 for location of parts. TO RAISE THE LOAD

1. Place jack on a hard level surface.
2. To avoid item from slipping during the raising operation. ALWAYS first determine the center of the weight load.
3. Place the jack under the item so that the Lift Saddle is positioned under the center of the weight load.
4. Pump the foot pedal until the lift saddle comes in contact with the load to be lifted: proceed to lock wheel casters. Always check to be sure that the saddle and the load are positioned correctly before raising the jack.
5. Use Foot Pedal to raise load: BE SURE that Safety Lock is secured in one of three stated lock positions once desired height is reached.
6. Apply tie-down straps (See page 5, Securing the Load) once load has been raised to desired height. Thoroughly tighten straps.
7. Stabilize loaded jack on a hard surface for maximum balance by adjusting locking screws.

MAINTENANCE

IMPORTANT: Before performing any maintenance of the bottle jack

ALWAYS detach from the frame and place on a level surface.

AIR PURGING INSTRUCTIONS

With the ram fully retracted, locate and remove the oil filler plug. Insert the foot pedal into the sleeve of Hydraulic Ram, then pump 6 to 8 strokes. This will help release any pressurized air which may be trapped in the reservoir. Be sure that the oil level is just below the oil filler plug hole. Reinstall the oil filler plug. Sometimes during shipment and handling, air may become trapped in the hydraulic system causing poor or no lifting.

OIL LEVEL

IMPORTANT: When adding or replacing oil, ALWAYS use a good grade of hydraulic jack oil. NEVER use brake fluid, alcohol, glycerine, detergent motor oil or dirty oil of any kind. Improper oil usage will cause serious internal damage to jack

ADDING OIL

With ram fully lowered and jack on level ground, remove oil filler plug. Add oil if level is more than 1/2" below hole.

REPLACING OIL

Oil should be replaced at least once every year. To drain oil, remove oil filler plug and release valve. BE VERY CAREFUL to not allow dirt or any foreign matter into the system.

LUBRICATION

Put grease in fitting on base and lubricate lifting arm spindle with oil when need

RUST PREVENTION

Clean and wipe with an oily cloth, the piston ram and pump piston every 3 months or when signs of rust or corrosion appear. When not in use, always leave the saddle and pump piston in the completely down position.

TROUBLE SHOOTING CHECK LIST

TROUBLE	CAUSE	REMEDY
Jack will not lower completely	1. Air in hydraulic system 2. Release valve stuck	1. Purge air from hydraulic system 2. Transfer weight load and clean valve
Jack will not hold weight	1. Release valve in open position	1. Close release valve tightly
Jack will not lift to full height	1. Oil level low 2. Air in hydraulic system	1. Fill to recommended level 2. Purge air from hydraulic system
Weak lifting	1. Air in hydraulic system 2. Dirty oil 3. Release valve not completely closed	1. Purge air from hydraulic system 2. Change oil. Use SAE 5W 3. Close release valve tightly
Jack will not lift load	1. Excessive weight 2. Release valve in open position 3. Oil level low	1. Decrease weight or change to higher capacity jack 2. Turn valve clockwise and tighten 3. Fill to recommended level



0044-800-240-4004
enquiries@mhstar.co.uk