



# **GARDEN TROLLEY INSTRUCTION MANUAL**



**For correct usage, please read these instructions carefully before use and keep in a safe place for future reference.**

## **Introduction**

This handy garden trolley is a really versatile garden accessory. It is durable and waterproof with a load capacity of 250kg. It can be used for transporting virtually anything around your garden. The 4 large wheels ensure smooth travel and the dual purpose handle allows the trolley to be pushed or pulled making it easy to manoeuvre when fully laden.

## **Important Safety Instructions**

- Do not load the garden trolley with more than 250kg. Do not use the dumping feature with more than 120kg.
- Always distribute the load evenly.
- Do not overload the garden trolley so items spill over the top edges of the plastic tub.
- If any parts become damaged, broken, or misplaced, do not use the garden trolley until the replacement parts are obtained.
- Do not operate or use on objects that can cause damage to the tyres or the tubes. Do not inflate the tyres to more than 30PSI/2.1BAR.
- Do not allow children to use the garden trolley unsupervised. The garden trolley is not a toy.

## **Features**

- Tip up facility
- Load capacity: 250 Kg
- 4 Large wheels
- Plastic tub dimensions: L103cm x W55cm x D27.5cm
- Dual purpose handle used to push or pull the trolley

## **Unpacking your Garden Trolley**

When unpacking your garden trolley check you have the following items included:

- 1x Instruction Manual
- 1x Plastic Tub
- 1 x Handle
- 4 x Wheels
- 1 x Lock
- 1 x Front Axle
- 1 x Front Frame
- 1 x Rear Axle
- 1 x Right Rear Strut
- 1 x Left Rear Strut
- 1 x Small Spanner
- Hardware - bolts, lock nuts & washers for assembly (Hardware list on page 4)

## Description of Parts

- |  |                   |
|--|-------------------|
| A. Plastic Tub (1)   | E. Front Axle (1) |
| B. Lock (1)  | F. 10 inch Wheel  |
| C. Front Frame (1)   | G. Handle (1)     |
| D. Rear Axle (1) (includes left & right rear struts and rear axle frame) |                   |

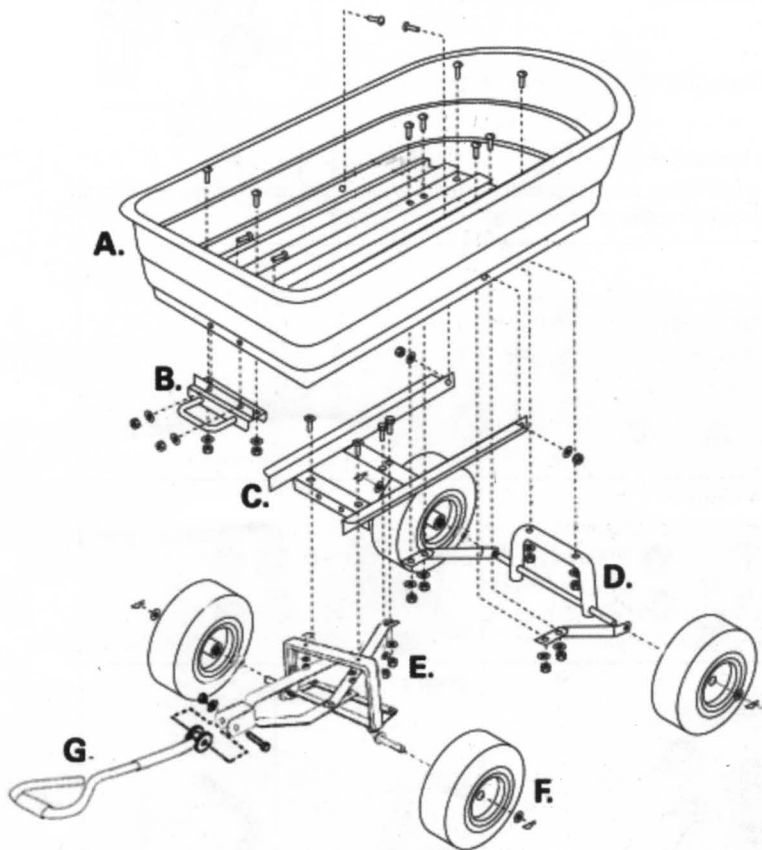

## STEP 1

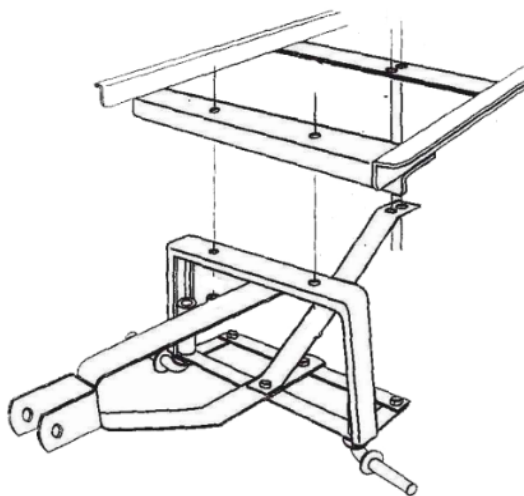

## STEP 2

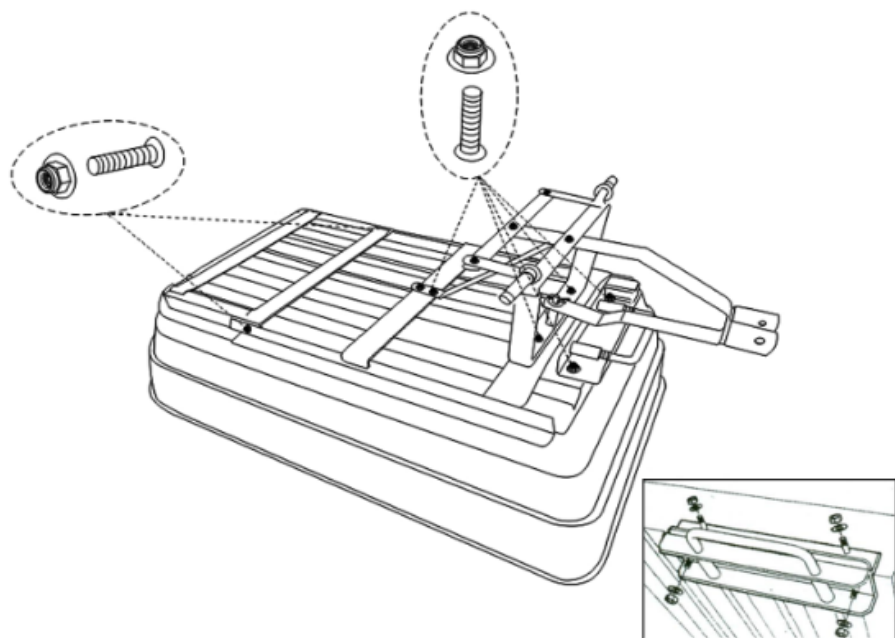

### STEP 3

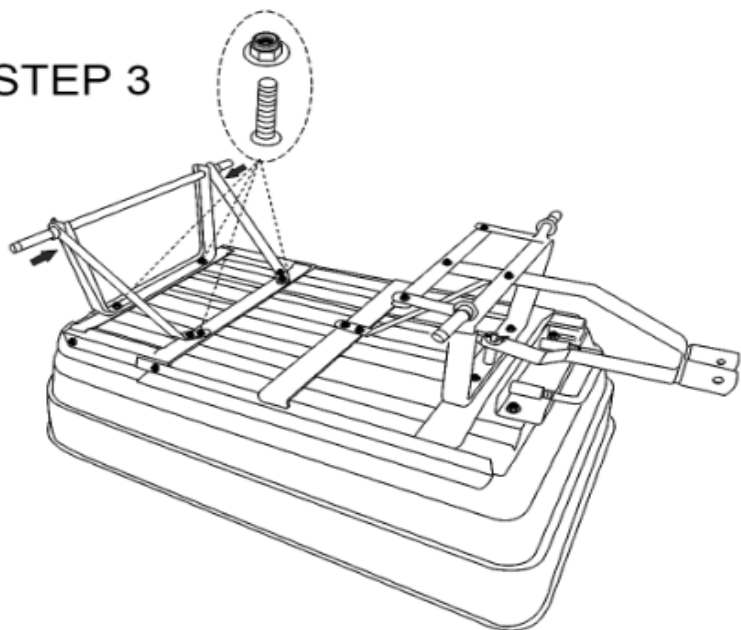

### STEP 4

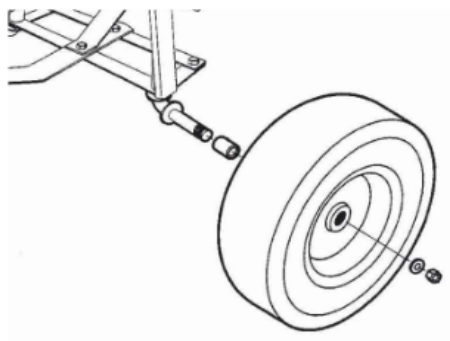

### STEP 5

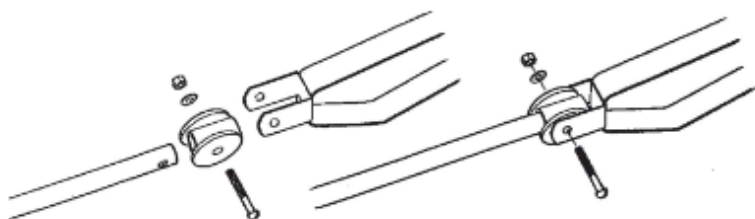

### Using the Dumping Feature

To use the dumping feature, pull the dumping release handle outward to release the plastic tub from the locking mechanism. (See figure 1.)

Lift up the release handle to rotate the garden trolley upward into the dumping position. (See figure 2 & 3.)

Figure 1.

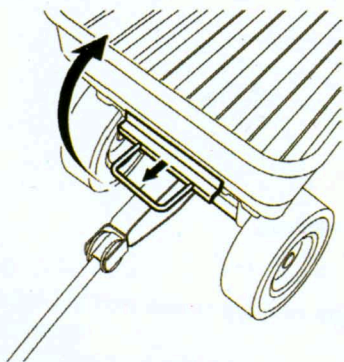

### Returning the Plastic Tub to the lowered position (See figure 4.)

Rotate the plastic tub back down to the lowered position.

Make sure the dumping release handle is locked into place when the garden trolley is in the lowered position.

Figure 4.

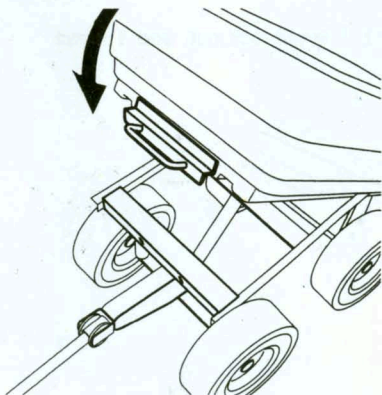

Figure 2.



Figure 3.

