



INbma066\_UK

**845-340**



Unfolded size (approximately):

L107\*W51\*H91.5cm

**Bearing capacity in use: about 80KG**

READ AND SAVE THESE INSTRUCTIONS FOR FUTURE USE

**ASSEMBLY INSTRUCTION**

Thank you for purchasing this product. In order to use this product safely, please read this instruction manual to the end before use, keep this instruction manual and use the product correctly. We hope you can understand that our company is not responsible for the failure and accident caused by the use outside the original purpose.

## **WARNING**

The elderly, people who are physically inconvenient, pregnant women and people who are prone to damage their body balance due to drinking and other reasons should not use this product, because they may fall down and get hurt.

## **POINTS FOR ATTENTION**

- This product is a wagon for luggage handling for travel and other activities. Even if it is within the range, please do not carry animals or people.
- Please be careful not to pinch your fingers, hands and other body parts in the movable part of this product. This product is designed for temporarily carrying luggage. Please do not use it for other purposes.
- The load resistance is 80KG during driving (approximately). Please do not overload the wagon and do not run while using it.
- Do not press the direction lever while using it.
- Do not put valuables, perishables, high temperature items, or items that may catch fire in the wagon.
- Please use it on a stable ground.
- Be careful not to use it in an inclined place. In addition, please do not use in places with steep slopes, on wet or icy grounds that are easy to slip, and prevent users from falling or being injured.
- Do not use it on soft ground such as mud, swamps, etc.
- If it is used and placed in direct sunlight for a long time, it may cause partial thermal deformation, which may cause cloth deterioration or burning loss. Therefore, please do not place it in direct sunlight or near the fire for a long time.
- When water, sand and soil are attached on the wagon, please wipe the wagon carefully and keep it.
- When the dirt is obvious, please apply diluted neutral detergent to the cloth and wipe it.
- Please do not use the power of car or motorcycle to drive.
- When the wagon moves with heavy objects on, it requires a lot of force when it is stopped. Therefore, attention should be paid.
- Please do not use on the driveway or sidewalk
- Please check before use. In case of deformation and damage of structural parts, and cracking, fading and aging of cloth, please do not use.

## **STORAGE AND MAINTENANCE**

- After use, please wipe the dirt carefully and make the wagon completely dry. Please store the wagon in a dry environment to avoid open fire and direct sunlight. Wet environment may cause discoloration and corrosion of the bracket.
- Please keep the wagon out of the reach of children.

Common problem;  
The bending of the pipes crossed in front of and behind the wagon is to make the unfolding and folding space smoother instead of damaging the pipes, so please feel free to use.

If the folding form needs to be moved, please use it as shown on the right.



## Unfolding

- Please unfold this wagon in a stable place.
- Please read the steps carefully to make sure there is no danger before unfolding.
- Please be careful not to pinch your fingers, hands or other body parts or parts of clothes at the intersection of the frame.

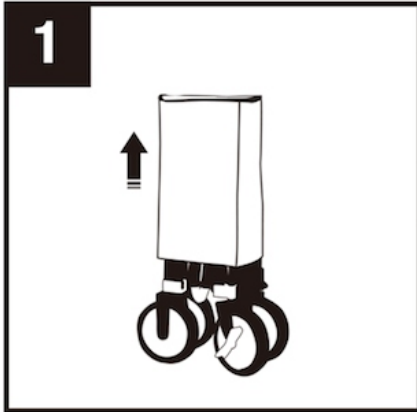

1  
Unzip and remove the cloth cover.

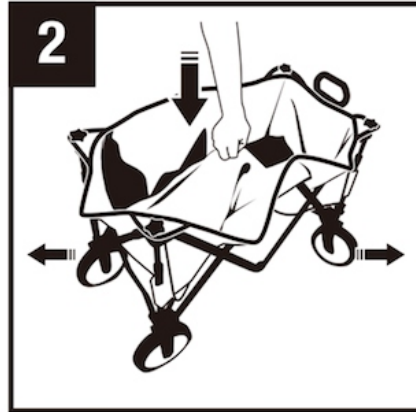

2  
Press down on the center of the wagon and the four corners will unfold.

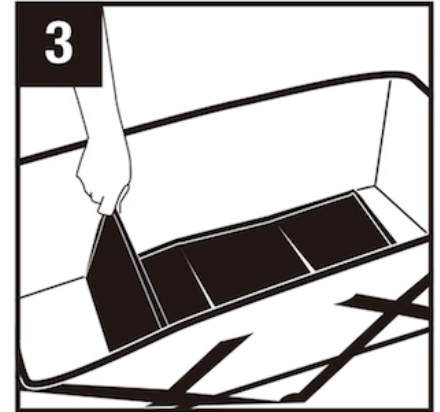

3  
Please spread the mat on the bottom and place it on the bottom of the wagon.

## Storage

- Please fold and store the wagon on a stable place.
- Please read the steps carefully and make sure that there are no dangers before folding.
- Please be careful not to pinch your fingers, hands or other body parts or parts of your clothes at the intersection of the frame.

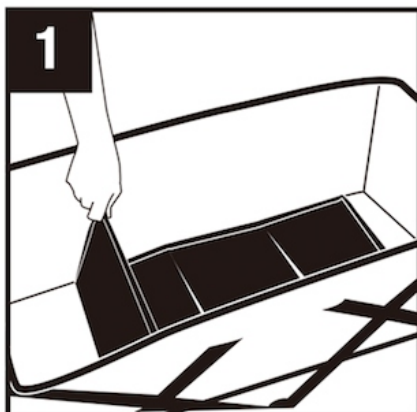

1  
Remove the mat for the bottom from the bottom of the wagon and fold it up.



2  
Pull the handle in the middle of the bottom to lift it up, the wagon will be folded, and the corners on four sides of the wagon will be leaned inward against one side with one hand.

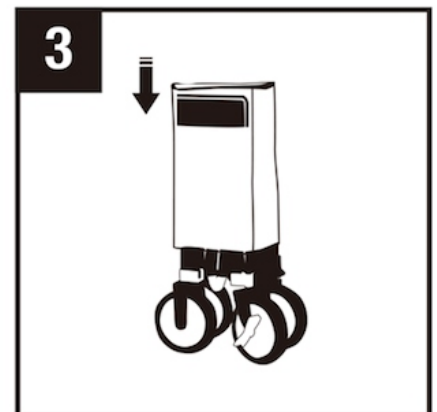

3  
Take care to align the tyre steering. Put on the cloth cover and insert the mat into the storage bag.

## Other Detachable Parts

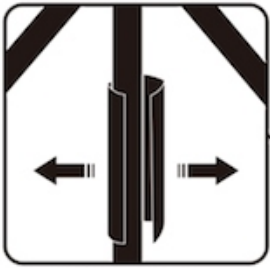

When removing the wagon cloth, it is necessary to tear off the velcro fixed at the four corners and the bottom.

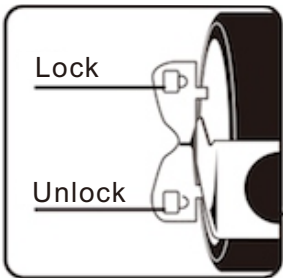

The front wheels have brakes.

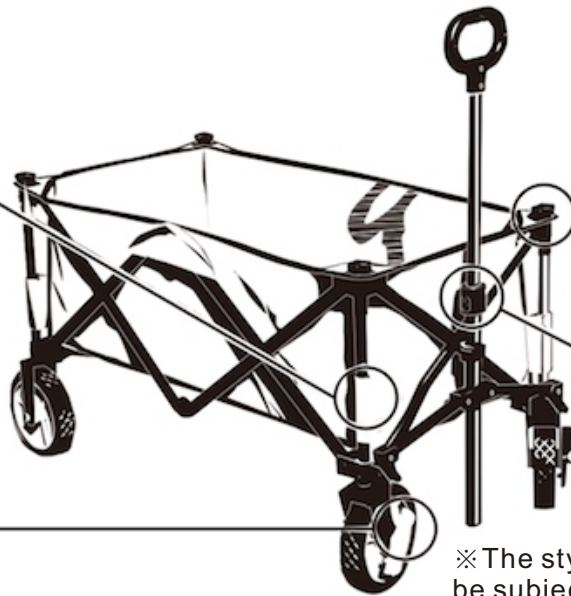

※ The style should be subject to the real object

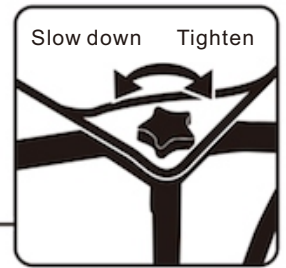

When extending and retracting the pull rod, please press the button on the pull rod to unlock it.

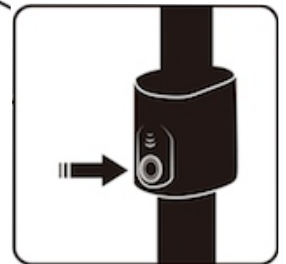

Before removing the wagon cloth, screw out the plastic parts that are used for the bottom of the valley.

US



001-877-644-9366  
customerservice@aosom.com

CA



001-855-537-6088  
customerservice@aosom.ca

UK



0044-800-240-4004  
enquiries@mhstar.co.uk

DE



0049-(0)40-88307530  
service@aosom.de

FR



0033-1-84166106  
contact@aosom.fr

ES



0034-931294512  
atencioncliente@aosom.es

IT



0039-0249471447  
clienti@aosom.it