

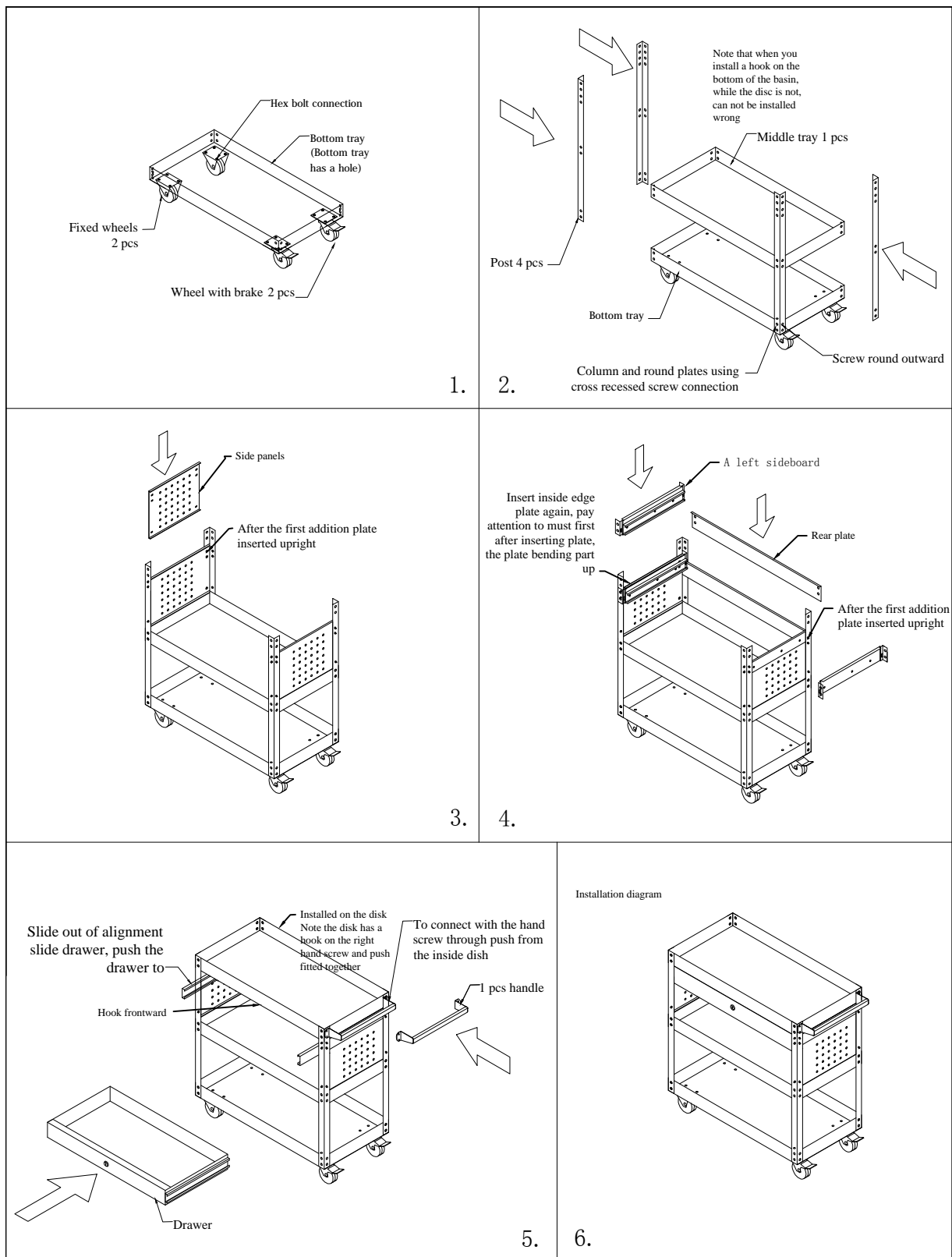

B20-065

	parts drawing	Part name	Quantity
		pillar	4
		hanging wall	2
		chassis	2
		drawer	1
		Side panels	2
		handle	1
		A left sideboard	2
		Rear plate	1
		Wheel with brake	1
		rotating rubble wheel	1
		Fixed wheels	2
		M6 Philip's head screw	48
		M8 Hexagon	16



parts assembly sequence:

- 1 First casters with chassis connection at the bottom of the chassis with casters hole, directional casters with casters on both sides can not be on the same side. Using a hex bolts
- 2 groups turn column, the column with the intermediate plate using a round head screw connection; the difference between the plate and on the disc, there is a hook on the bottom of the dish, the dish did not. Simply install the first disc
- 3 Install the left and right panels according to figure
- 4 assembly left and right side panels and the rear plate, note the installation order and direction of the side plate as shown
- 5 fixed around the side plate and the rear plate, and then the upper plate installation, do not install screws on the right and the need to install push hands together. Then pull the rails, and slide the drawer and insert aligned, push the drawer in place to complete the assembly.