

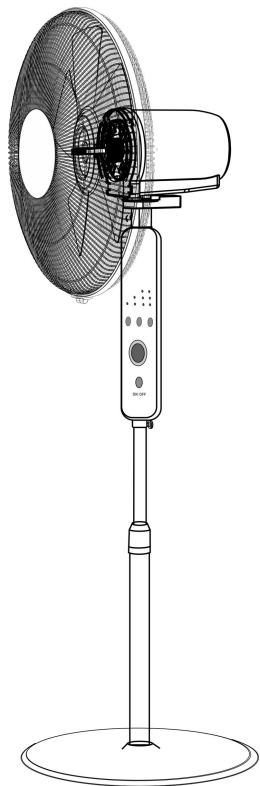

INTRODUCTION MANUAL

FAN
VENTILATUR
VENTILATOR
VENTILATION



MODEL: 824-013V70

MADE IN CHINA
STAND FAN, 220-240V~ 50Hz 45W

NOTE: Please read the manual carefully before using

IMPORTANT SAFETY INSTRUCTIONS



When using electric devices, basic safety precautions

must be observed. To avoid the risk of burns, electric shocks, fire, and/or personal injury, please read the instruction manual carefully before using the device, and observe all of the instructions during the operation of the device.



GENERAL GUIDELINES

- Electronic devices are not toys! Keep children away from the device!
- Only use the devices for its intended purpose.
- The device is only suitable for use in private households and not for commercial use.
- Do not leave the device unsupervised while in use or connected to the mains.
- Switch off the device if it is not in use, in the event of malfunctions and for cleaning, and also remove the power plug.
- Do not carry the device by the power cord.
- Keep the device clean and dust-free.
- Never use the device outdoors.
- Check the device regularly for signs of visible damage. Do not use the device if you have determined damage, if the device has fallen down or if it does not function properly. Do not attempt to repair the device yourself.
- Repairs are only allowed to be carried out by qualified specialists.
- The power point must be located near to the device so that the plug can be removed easily in an emergency.



HAZARDS DUE TO ELECTRIC CURRENT

- The voltage stated on the name plate of the device must agree with the voltage of your mains electricity network.
- Only connect the device to a power socket that has been installed properly. Do not use a power strip or an extension cable.
- Never operate the device using a timer or another remote control device.

- Never touch the device, the power cable and the plug with damp or wet hands or if you are standing on wet ground.
- Do not place the power cord in the sink.
- Do not immerse in water.
- Immersing the device in water or other fluids leads to a risk to life of electric shock!
- Keep the device, the power cable and plug away from hot surfaces, naked flames, direct sunlight and sharp edges. When using the device make sure that the cable is not jammed (e.g. in doors).
- When you pull the plug out of the power socket, always pull on the plug and never on the cable.
- If the power cable of this device is damaged it has to be replaced by a correspondingly qualified person to prevent hazards. The same applies to the plug.

OVERVIEW OF APPLIANCE

1. Front Grill
2. Blade Lock Nut
3. Blade
4. Grill Lock Nut
5. Rear Grill
6. Motor
7. Motor Cover
8. Grill Ring Lock Nut
9. Grill Ring
10. Control Panel
11. Fixed Screw
12. Power Plug
13. SS Holder
14. Holder Lock Nut
15. Main Holder
16. Base
17. Gasket
18. Fixed Screw

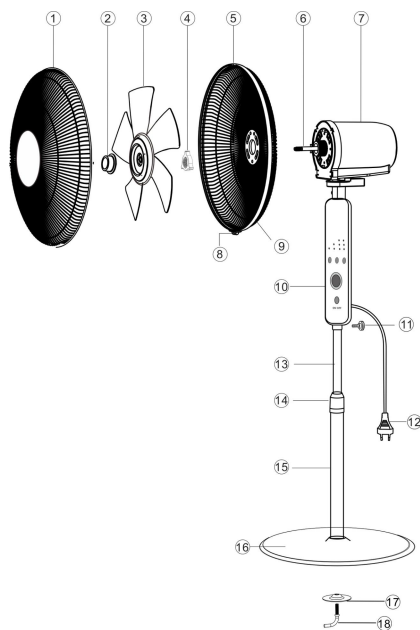

Control Panel

Remote Control

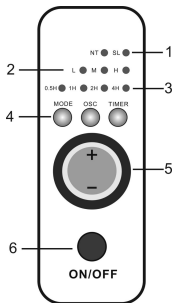

1. Mode : Nature / Sleep/Normal

2. Speed: Low/Mid/High

3. Speed: Low/Mid/High

4. Button

5. Speed select

6. Power

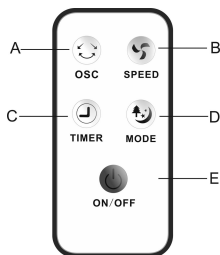

A. Oscillation

B. Speed

C. Timer

D. Mode

E. Power

Installation

1. Insert the main holder (15) into the base (16), and tight up by the holder fixed screw (18).
2. Turn up the SS holder (13), and tight up by holder lock nut (14)
3. Insert the control panel (10), into the SS holder (13), and tight up by fixed screw (11)
4. Put the rear grill (5) on the motor cover (7), and tight up by the grill lock nut (4)
5. Put the blade (3) on the motor (6), and tight up by blade lock nut (2)
6. Put the front grill (1), to match the rear grill (5), and tight up the grill ring, fixed by grill ring lock nut.

HANDLING THE APPLIANCE

POWER

- Press the button of ON/OFF (6), to select power on / off the appliance.

SPEED

- Press the button of ON/OFF (6) , to power on the appliance.
- Press the button of Speed (5), to select the fan speed.
- 3 speed for select: (Low - Mid - High)

MODE

- Press the button of ON/OFF (6) , to power on the appliance.
- Press the button of MODE , to select the fan mode.
- 3 mode for select: (NATURE / SLEEP/ NORMAL).
- The default mode is NORMAL, and the SLEEP/NATURE mode with the indicator

TIMER (0.5 - 7.5 HOURS)

- Press the button of ON/OFF (6) , to power on the appliance.
- Press the button of TIMER to the desired time period (0.5-7.5 Hours)
- It will now remain in operation until the selected period of time runs out.
- After the timer runs over , the device will turn off.

OSCILLATION

- Press the button of ON/OFF (6) , to power on the appliance.
- Press the button of OSCILLATION, appliance will swing from Left to Right.

REMOTE CONTROL

- All the function above can be setting by remote control

CLEANING AND MAINTENANCE

Before cleaning the appliance always disconnect the power plug from the receptacle.

- The appliance, the power cord and the power plug should not be immersed in water or other liquids when you are cleaning them. Clean them with a dry cloth.
- If it is very dirty, the outside of the appliance can be wiped carefully with a moist cloth and then dried carefully. Make sure that no moisture penetrates into the interior of the appliance.
- Do not use any harsh cleaners, steel brushes, scouring powder or other hard objects to clean the appliance as these can cause scratches on the surfaces.
- Clean the appliance regularly.
- Never use solvents, benzene or oil-based cleaners as these can damage the housing.
- Re-tighten visible screw connections on the appliance regularly in order to ensure that the device is functioning properly.

DISPOSAL



Used electric household devices

1. If you do not want to use your electrical appliance any longer, return it free of charge to a recycling depot for used electric appliances.
2. Used electric devices do not belong in the household garbage (see symbol).

Further disposal instructions

1. Return the electrical appliance in such a condition that its later re-use or recycling is not adversely affected. Batteries must be removed in advance and the destruction of parts which contain fluids must be avoided.
2. Electrical appliances can contain harmful substances. Improper handling or damage to the appliance can lead to health problems or water or ground contamination, when the appliance is recycled later.

SPECIFICATION

PRODUCT: STAND FAN

MODEL:824-013V70/013V90

POWER:45W

VOLTAGE/HEIZ: 220-240V~ 50Hz



Made In China

All images serve as illustrations only and do not always show exact representations of the device.

All rights reserved.



0044-800-240-4004
enquiries@mhstar.co.uk