

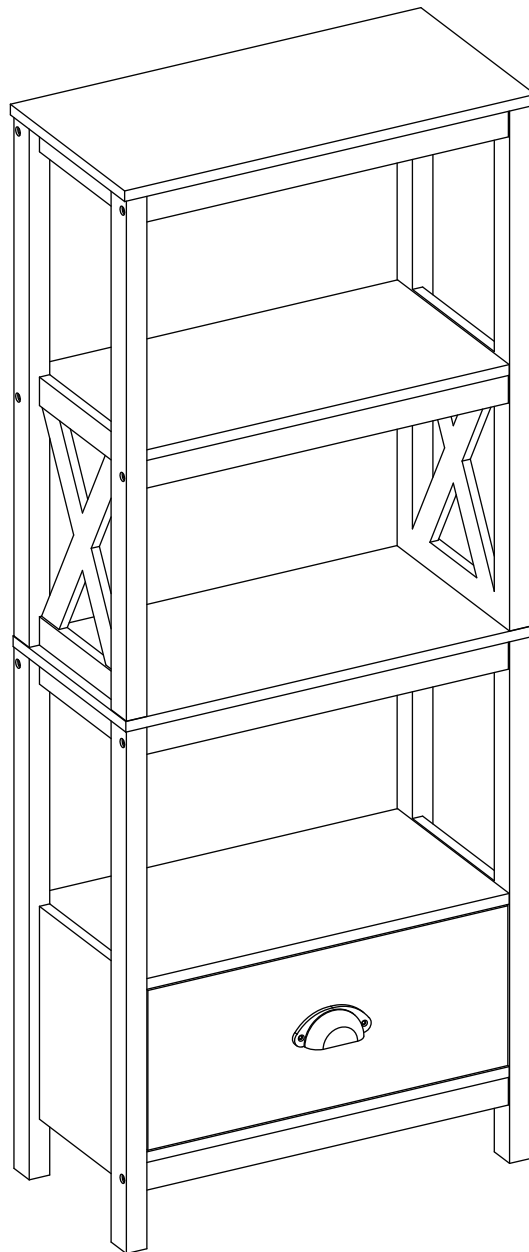

INcpb028_US_CA

838-104



IMPORTANT, RETAIN FOR FUTURE REFERENCE: READ CAREFULLY

ASSEMBLY & INSTRUCTION MANUAL

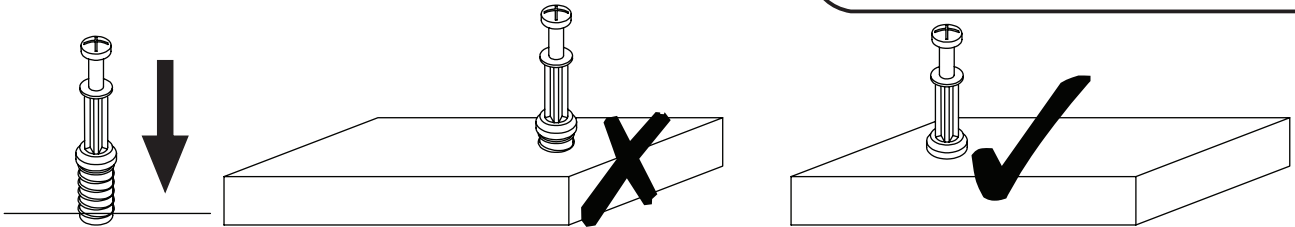

EN_QUICKFIT: Tighten quickfit until shoulder is flush with panel. Do not overtighten or undertighten.

FR_RACCORD RAPIDE: Faites serrer le raccord rapide jusqu'à ce que l'épaulement soit parfaitement encastré dans le panneau. Il ne faut ni trop serrer ni insuffisamment serrer.

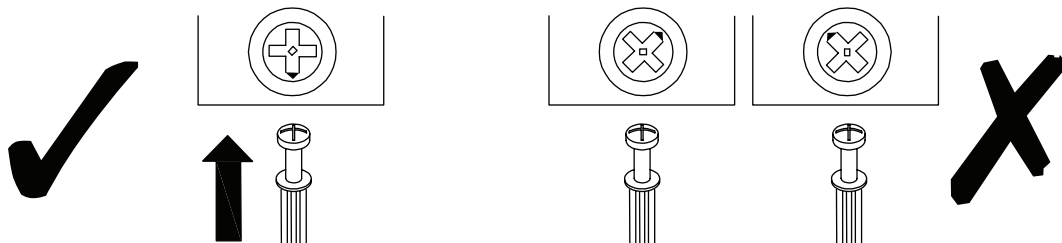

EN_CAM LOCK: When fitting cam lock, ensure starting position is correct before you insert connecting quickfit.

FR_SERRURE BATTEUSE: Avant d'insérer la serrure batteuse, veillez à la bonne orientation avant d'insérer le raccord rapide.

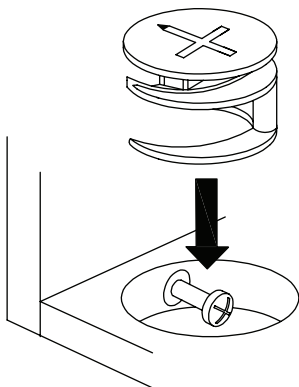

EN_Quickfit head should be in the centre of the cam lock when the two panels are joined.

Cam lock should be inserted before quickfit.

FR_Lorsque les deux panneaux sont assemblés, la tête du raccord rapide doit reposer au centre de la serrure batteuse.

Il faut insérer la serrure batteuse avant le raccord rapide.

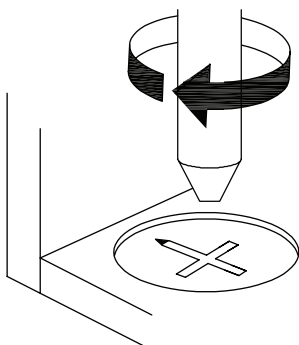

EN_Turn cam lock clockwise to tighten.

FR_Faites tourner la serrure batteuse dans le sens des aiguilles d'une montre pour la resserrer.

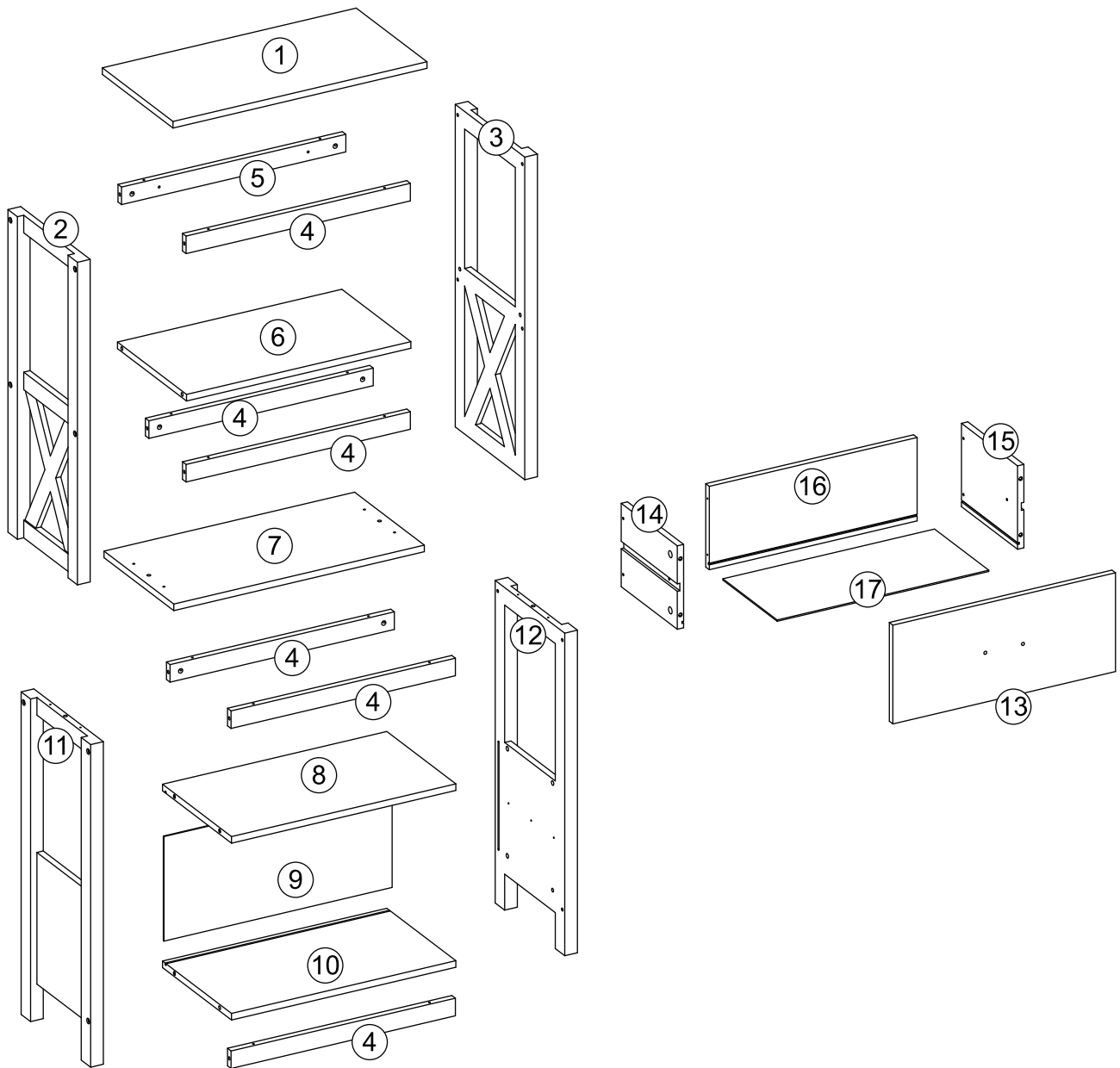

A x10
+1 (spare)

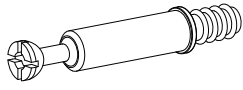

B x10
+1 (spare)

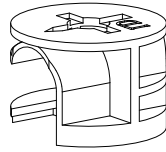

C x06
M8*30
+1 (spare)

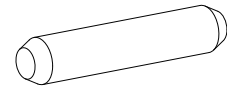

D x02
M8*60

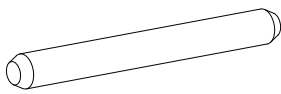

E x06
M3*12
+1 (spare)

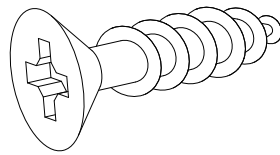

F x04
M4*35
+1 (spare)

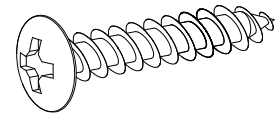

G x16
M4*45
+1 (spare)

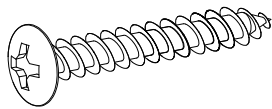

H x04
M4*65
+1 (spare)

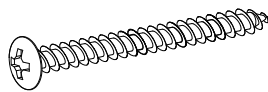

I x02

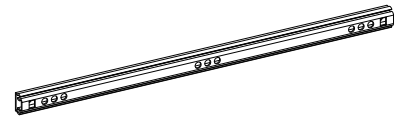

J x04
M4*12
+1 (spare)

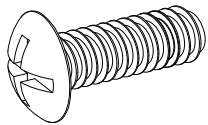

K x14
M6*60
+1 (spare)

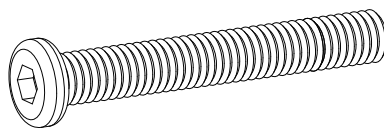

L x14
+1 (spare)

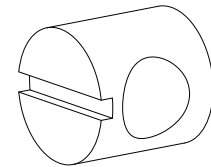

M x01

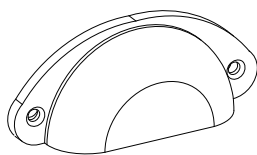

N x02
+1 (spare)

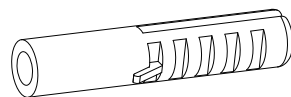

O x01

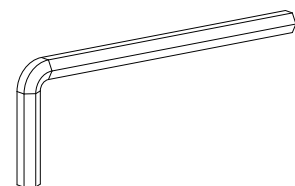

G x04
M4*45

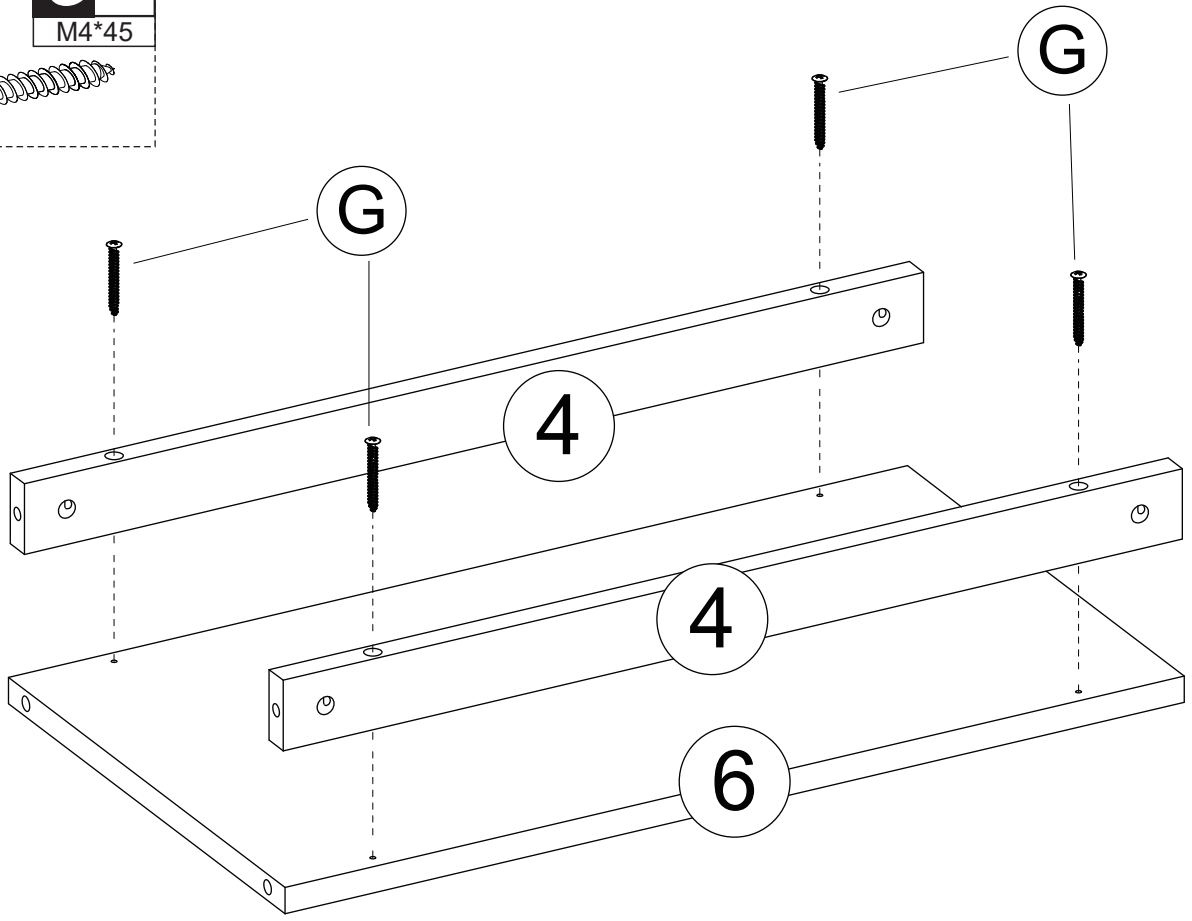
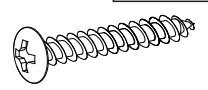

C x04
M8*30



K x08
M6*60

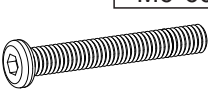

L x08

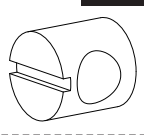

O x01

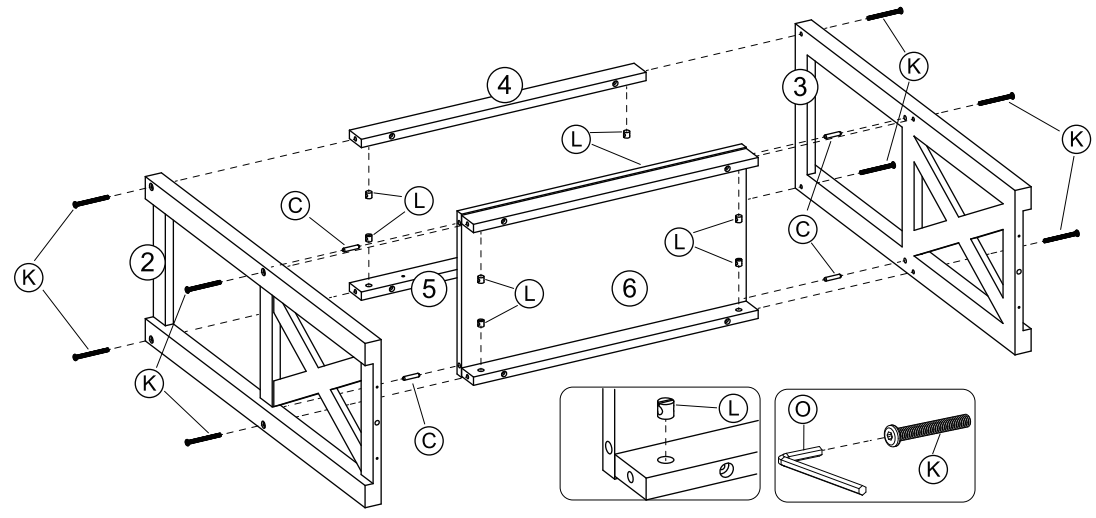
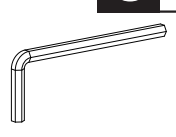

A x06

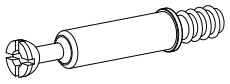

E x06
M3*12

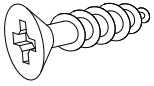

I x02

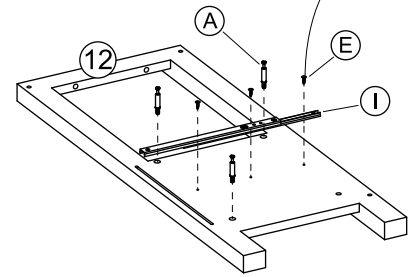
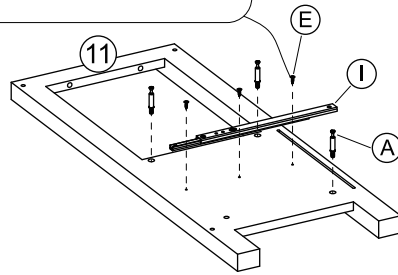
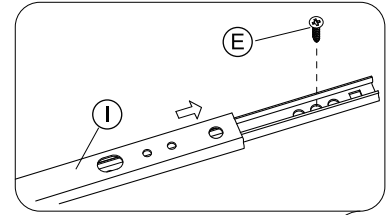
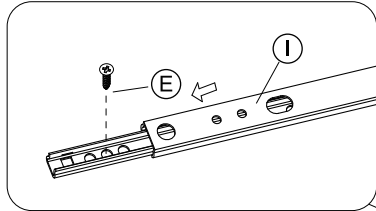

G x02
M4*45

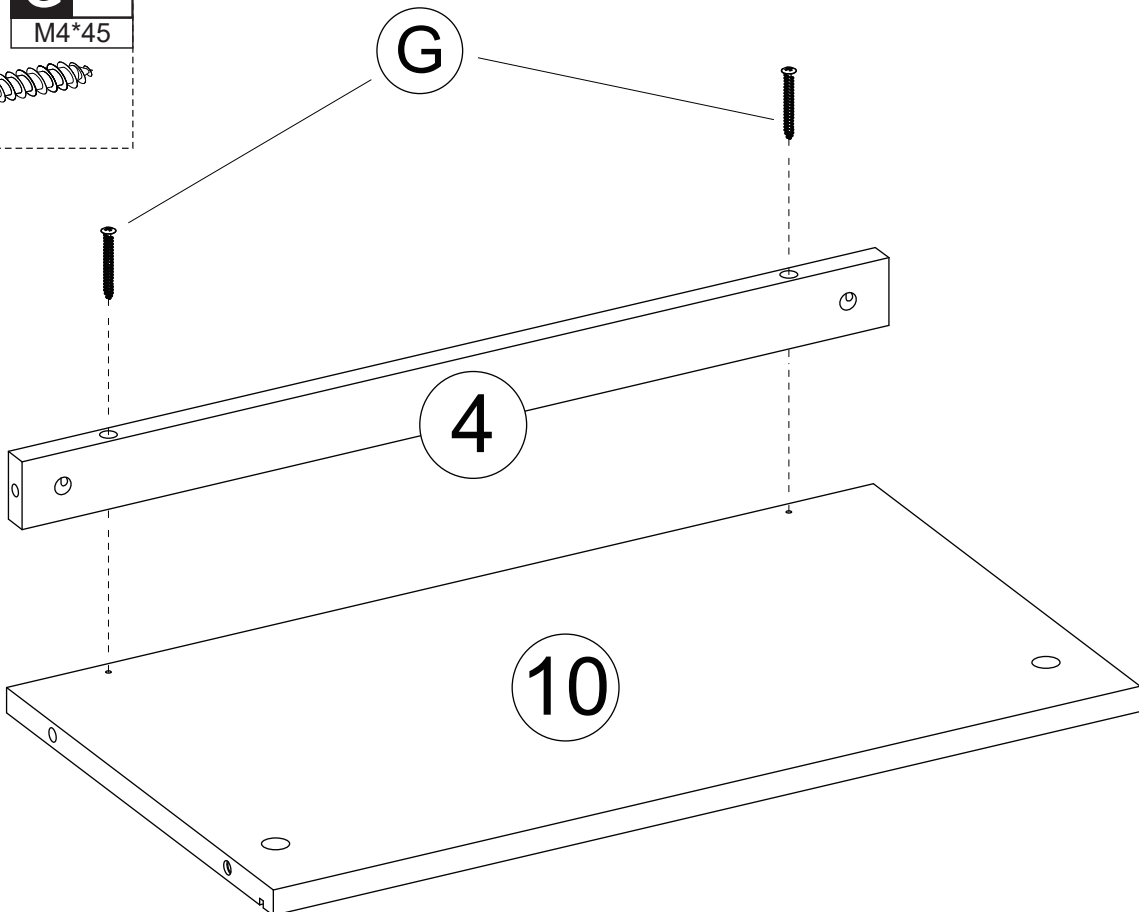
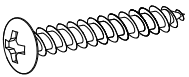

B x03

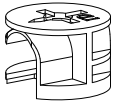

C x01
M8*30

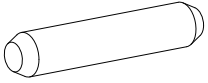

K x03
M6*60

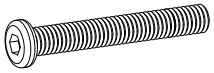

L x03

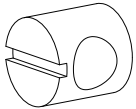

O x01

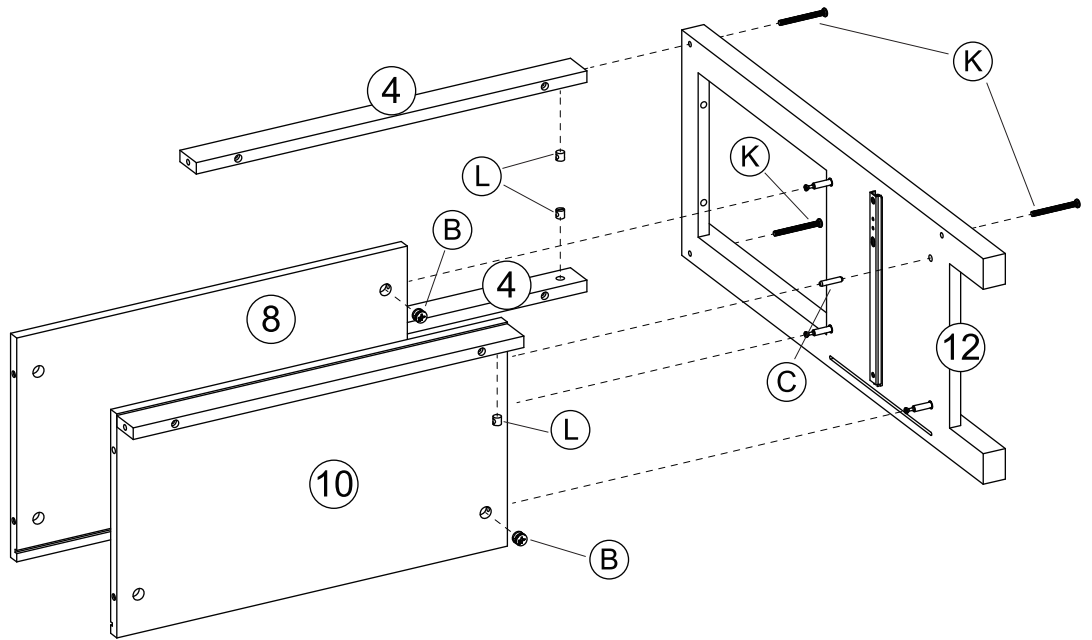
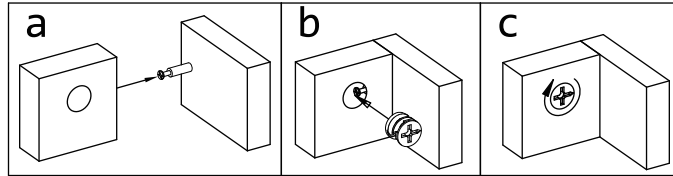

B x03

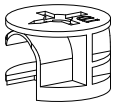

C x01
M8*30

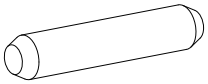

K x03
M6*60

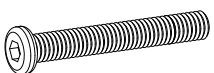

L x03

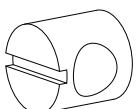

O x01

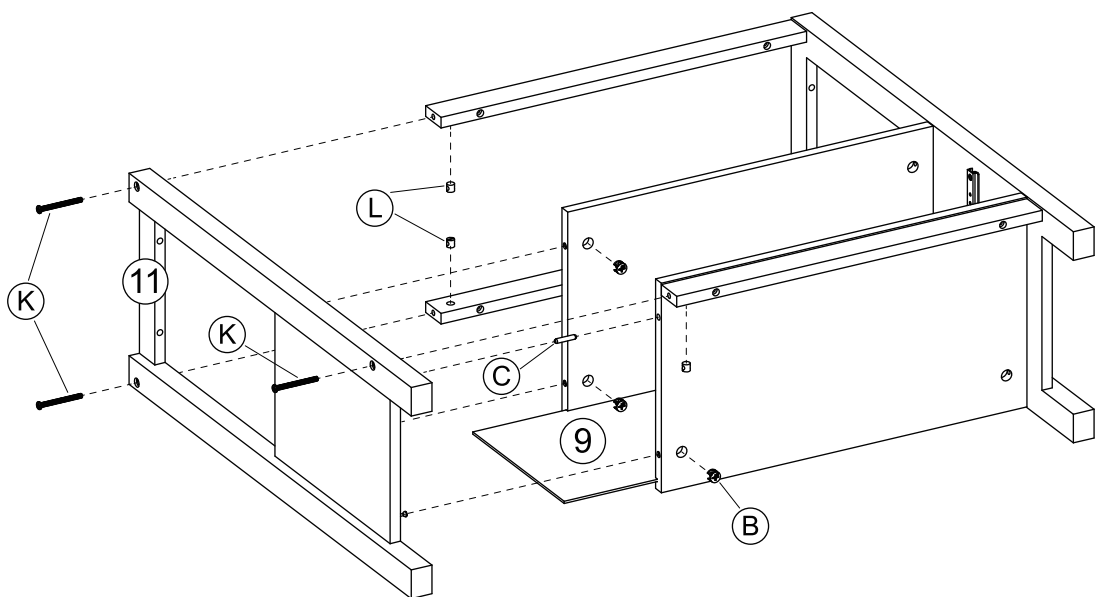

D x02
M8*60

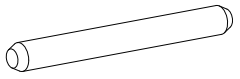

G x04
M4*45

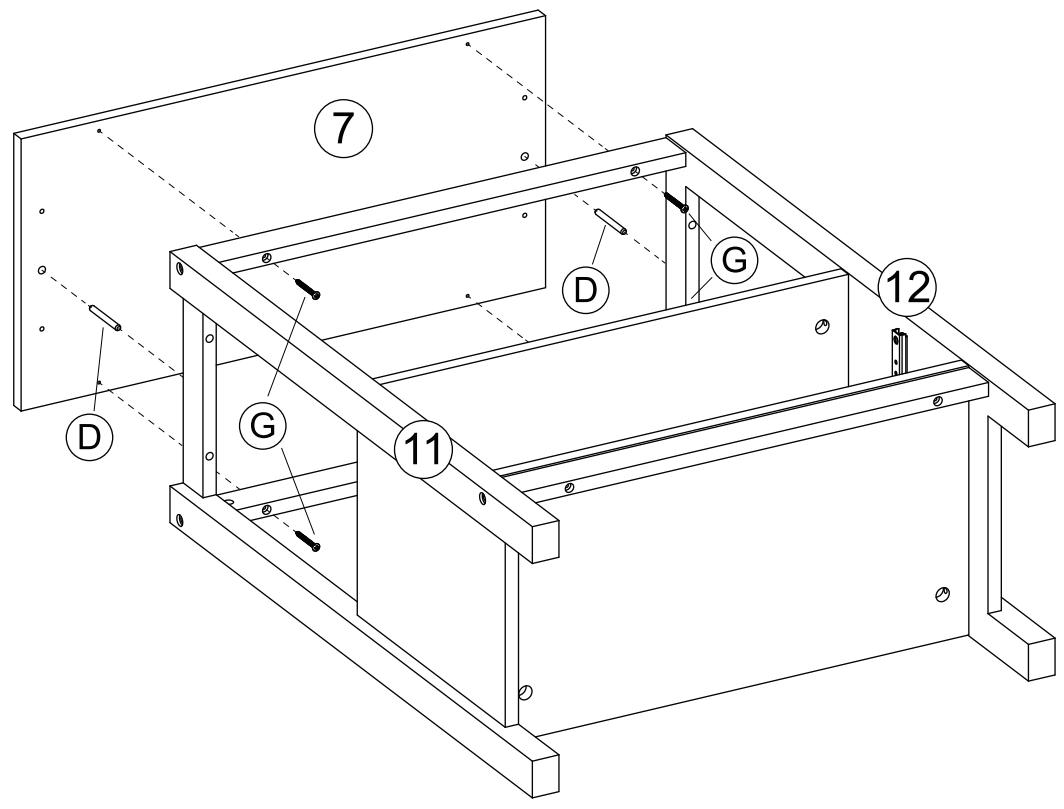
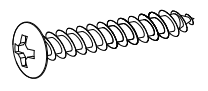

H x04
M4*65

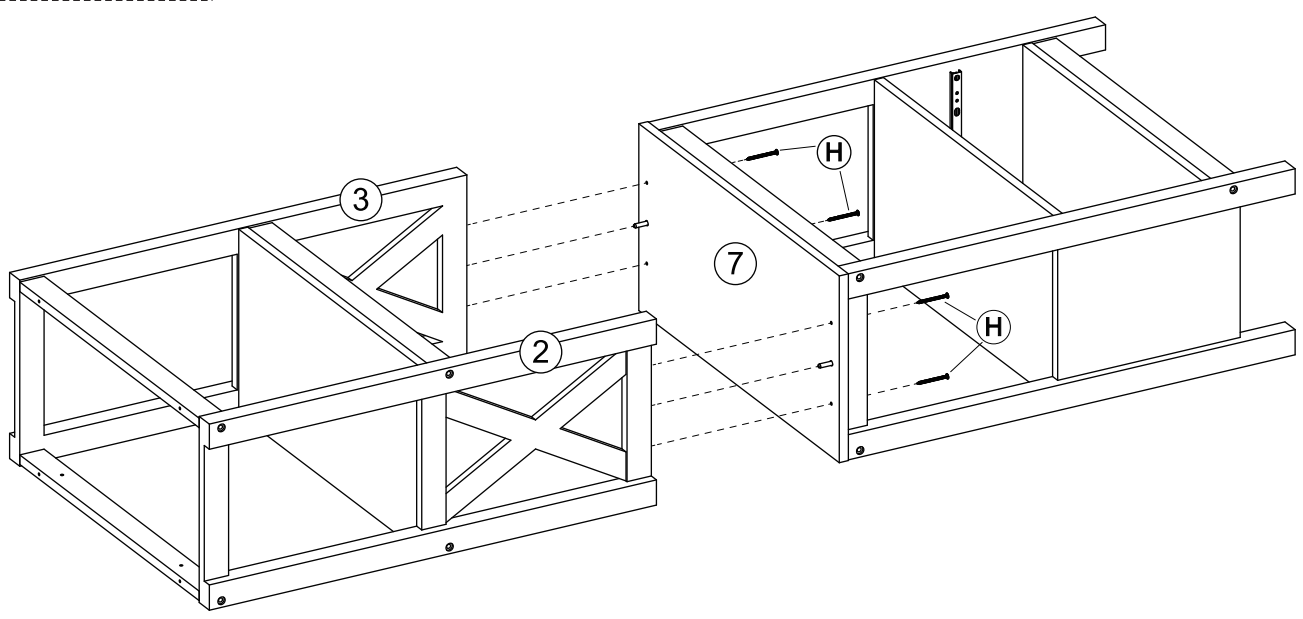
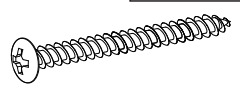

G x04
M4*45

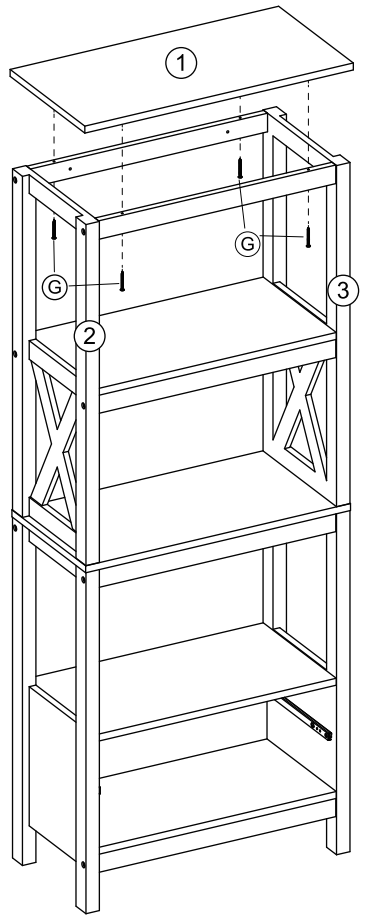
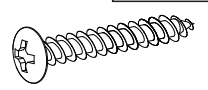

F x04
M4*35

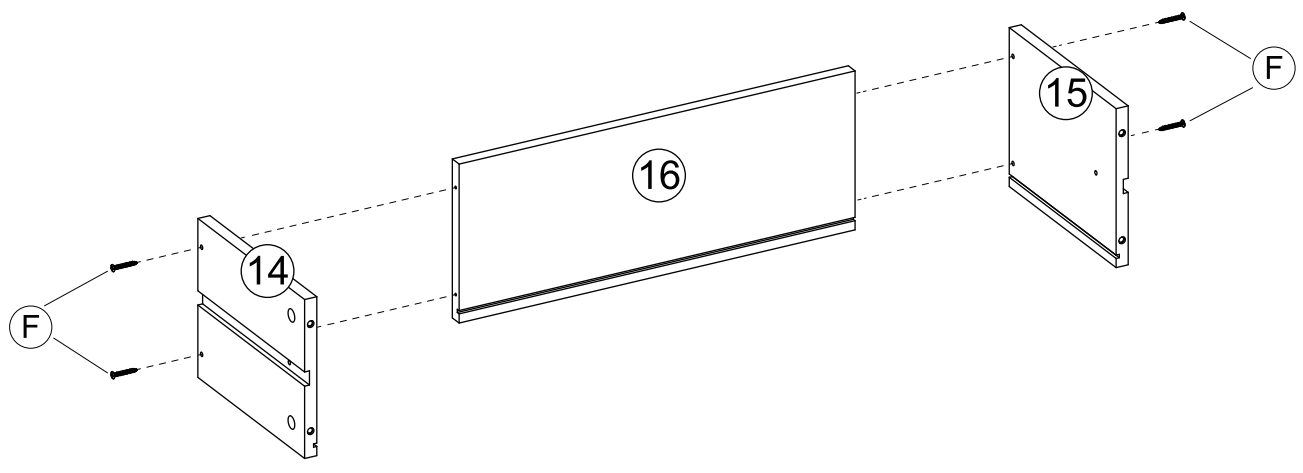
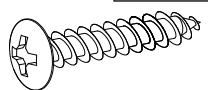

A x04

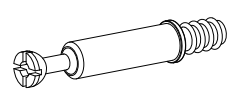

J x02
M4*12

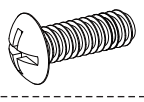

M x01

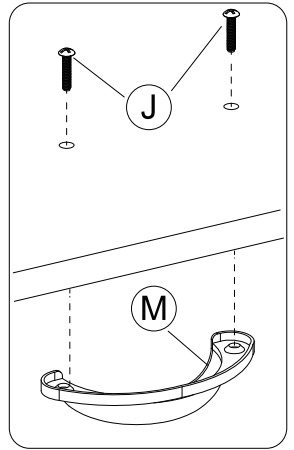
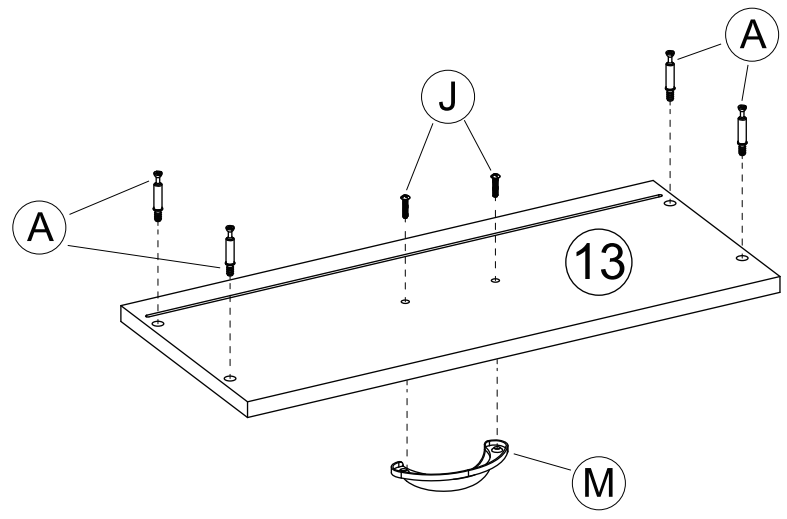
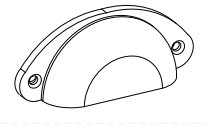

B x04

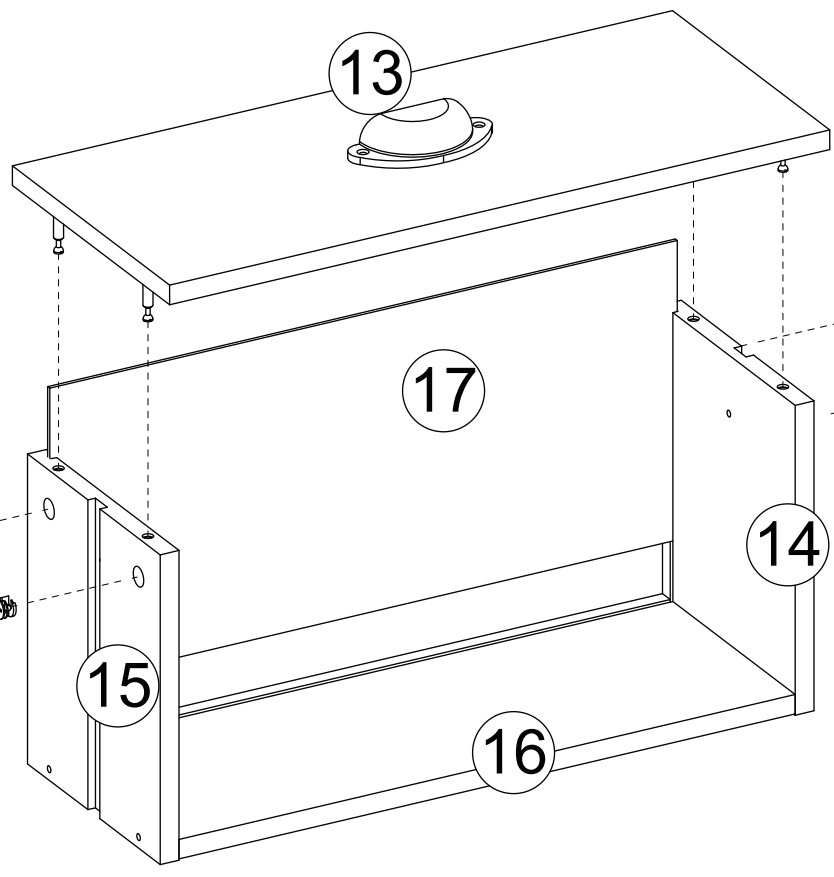
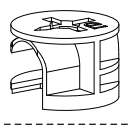

J x02
M4*12

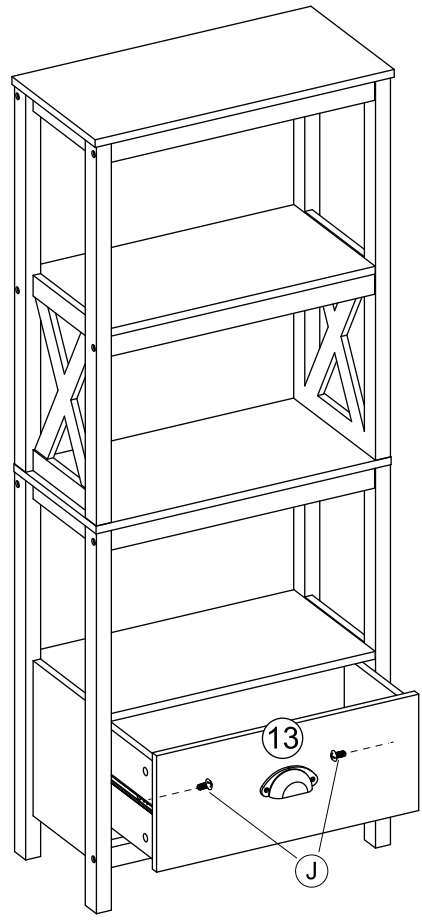
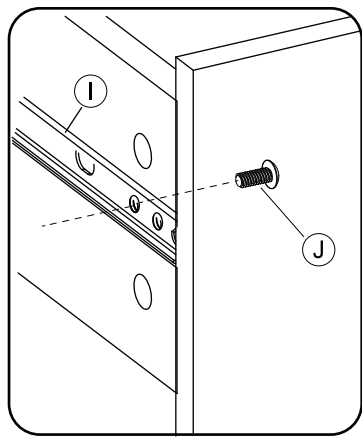
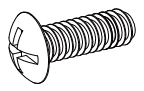

G x02
M4*45

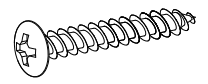

N x02

