

# Electric Shoe Warmer

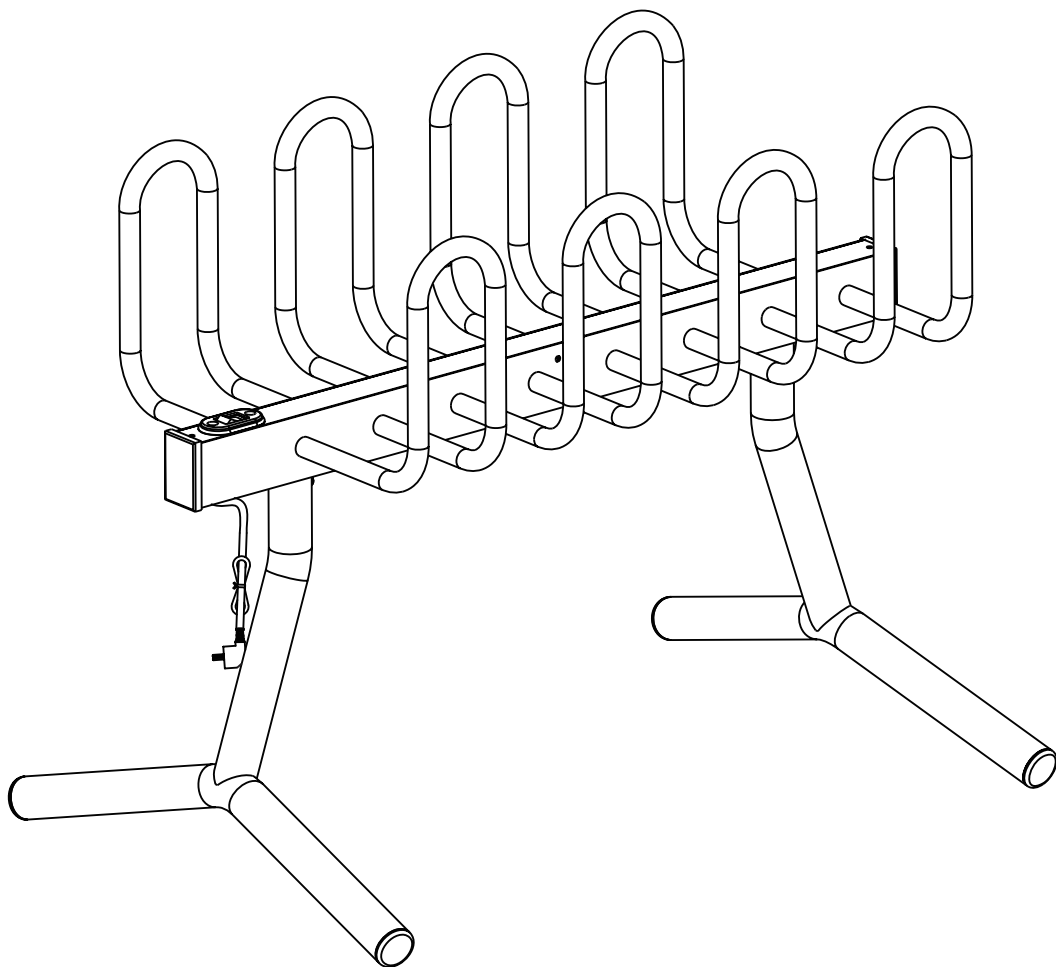

IMPORTANT, RETAIN FOR FUTURE REFERENCE: READ CAREFULLY

## USER'S MANUAL

# INSTRUCTION

Please read the entire instruction manual before use and save it for future reference. We reserve the right for any errors in text or images and for making any necessary technical changes to this document. If you should have any questions concerning technical problems please contact our Customer Services.

## SAFETY AND CAUTIONS

1. Please hang the shoes on the shoes rack properly.
2. Do not put the dripping shoes on the rack directly.
3. Where install the product, the power should totally according to the product label says.
4. Stop using when the product cover or heating tube damaged.
5. Product provides with earthing to avoid security risks and dangers.
6. Start power only after the clean and installation finishes.
7. If the power cord need to be changed, and a damaged wire need to be repaired, it must be replaced by the manufacturer or replaced by the manufacturer's authorized service agent to avoid injury.
8. If external electrical wiring needs to be repaired, the power should be completely cu off.
9. Do not operate this appliance with a damaged cord, plug, or after the appliance malfunctions or has been dropped or damaged in any manner. Return to a qualified electrical person for examination, electrical service and repair.

This appliance is not suitable for person with defect in physical senses, intelligence or person lack of experience (include the children), except when they are supervised by their guardians or with right guidance before using the appliance.

This appliance should be provided with a fixed cabling and all-pole disconnection power off.

# INSTALLATION

Components:

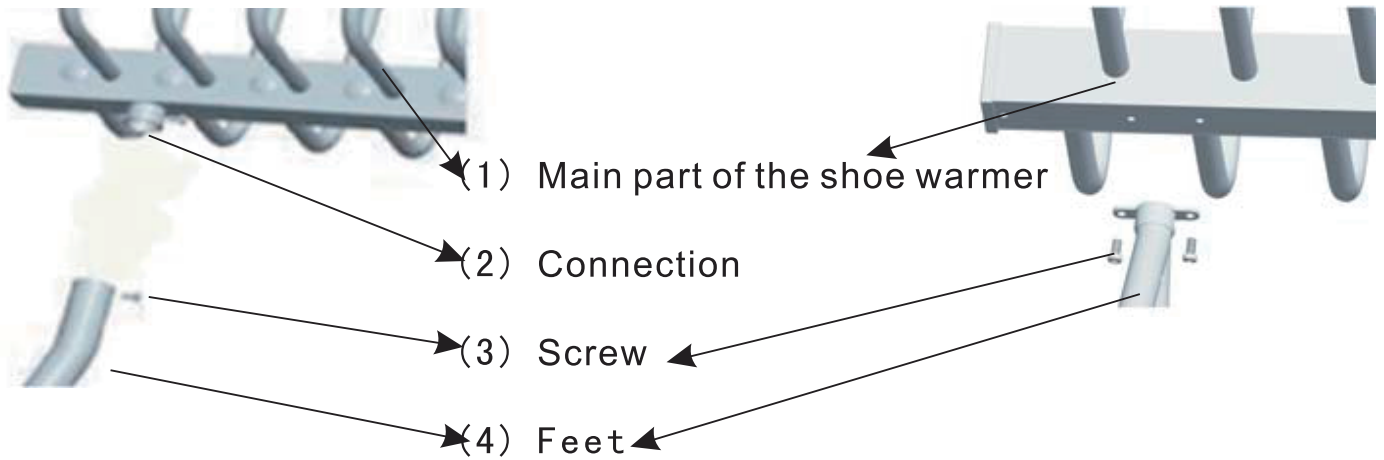

Installation Steps

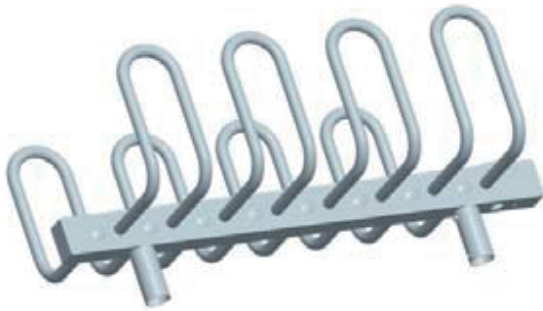

1. Upside down the main part of the electric shoe warmer in a cloth or other soft objects.



2. Insert the connection bush (2) into the feet (4), screw the feet (4) to the connection bush (2) tightly, adjust the balance of the product, set up the electric shoe warmer. Switch on it to work.