

STEP 1

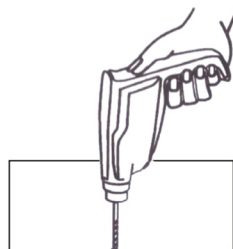

Drill positioning hole

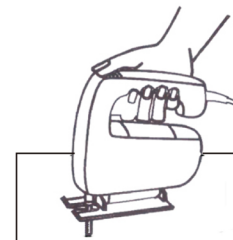

Cutting

Please cut the marble according to the cutting line paper (was provided with products), if missing the cutting line paper, please refer to the basin dimensions in the instruction.

kleanpin

INcvc089_US
834-250

STEP 2

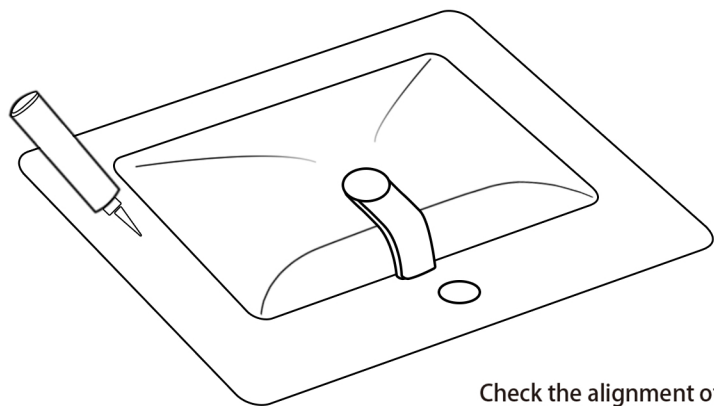

Check the alignment of the sink to the opening in the counter-top. Use a bead of clear silicone (or preferred adhesive) around the underside of the sink.
Carefully place sink on the counter-top align, and press firmly.
Allow sealant to set for 30 – 60 minutes

CABINET BASIN	16-9/10" [430mm]
19-2/3" [500mm]	