



## All Terrain Knee Walker

### Instruction Manual



712-034 EN C000000

Please read the instruction carefully before using.

#### NOTICE FOR USE

1. Do not install or use this equipment without first reading and understanding this instruction sheet. If you are unable to understand the cautions or instructions, please contact a healthcare professional or technical personnel before attempting to install this equipment.

2. Before using the knee walker, you should be trained by a healthcare professional or dealer until you have practiced with someone and you feel confident you can maneuver by yourself.

3. Please consult with your physician or therapist to determine proper adjustment and usage.

#### PRODUCT INFORMATION

Knee walker is delivered in the box. After unpacking. Please keep the box for future storage. If the package or product is damaged, please contact us.

#### Product Overview



Product images only for reference purpose, so please check the subject produce with "Package Content"

#### Package Content

1. OS-HCT9125C	x1 set (Pink or Blue)
2. Instruction Manual	x1
3. Accessories	x1 Basket x1 Knee Pad x1 Ring

1. Basket
2. Front Wheel
3. Back Wheel
4. Quick Release Clamp
5. Adjustment Screw for Pad
6. Foam Pad
7. Adjustment Screw for Handle
8. Armrest
9. Brake with Parking Locker

#### QUICK USING GUIDE

##### INSTALL

##### Step 1. Install the walker frame

Rotate the lever clockwise to tighten the quick release clamp and pull it down to point towards the frame tubing to lock it securely. **Double check it is firmly installed.**



##### Step 2. Raise the tiller

Push the steering tiller upward until it's fully in the straight position. Lock the clamp like step1. **Double check it is firmly installed.**



##### Step 3. Adjust the height of the handlebars

-Remove star screw.  
-Extend handlebars up to desired height, align holes in tiller.  
-Insert star screw through the steering tiller.  
-Tighten Knob securely.  
**Handlebars should be set at wrist level to keep your back straight.**

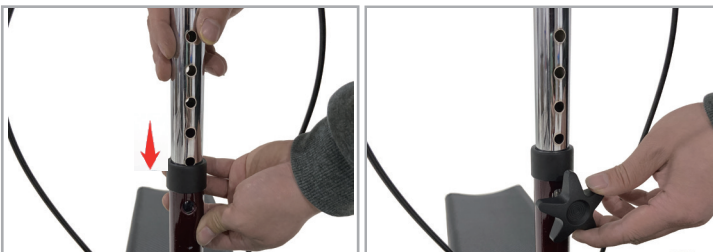

##### Step 4. Install the knee platform

Insert the knee platform to desired height. Insert star screw and tighten knob securely. **Double check it is firmly installed.**



##### Step 5. Install the basket



##### Step 6. Check the brake

Squeeze the hand brake lever and push down the parking brake lock, and the Knee Walker will be locked. Squeeze the hand brake lever again to release the parking brake lock.



##### Storage

To fold and storage the knee walker, you just operate the install step oppositely.

#### READY TO GO

- Place your hands on the handlebars.
- Place the injured leg comfortably resting on the center of the knee platform.
- Release the brake to move yourself forward or backward slowly with small steps with your other leg, keeping the knee of your injured foot centered on the knee platform.
- The knee walker can make turns by simply moving the handlebars with a minimum amount of effort. Turns should only be performed while at a slow rate of movement. To turn left, rotate handlebars to the right. To turn right, rotate handlebars to the right.
- With practice, you should be able to move forward without deviating to the opposite side.

**ATTENTION: When you pump it, control within 2 pa. Such as: When gas completely discharged, pump 20 times in front wheel, 12 times in rear wheel.**

#### CARE AND MAINTENANCE

- Clean with damp cloth and non-abrasive cleanser.
- Clean wheels with warm water and a mild cleanser. Dry with a clean rag.
- Ensure that all attached hardware and seat lever are secure at all times.
- Inspect the Knee Walker periodically to ensure the brakes, seat lever, steering, and wheels are functioning properly and that all parts are secure.
- Replace any broken, damaged or worn items immediately.
- If handgrip is loose, DO NOT USE. Replace it or contact us immediately.
- Ensure that the brakes are working correctly.

Over time the brake cables may stretch with use, they can be adjusted by a qualified dealer. Failure to do this may result in injury to the user.

#### SAFETY INSTRUCTIONS

- DO NOT exceed the maximum weight capacity, including basket contents. Maximum weight capacity for the knee walker basket is 5lbs.
- DO NOT use the knee walker on stairs, curbs, obstacles, etc. Watch out for: cords, thrown rugs, toys on the floor, spilled water or oil.
- DO NOT use the knee walker if the brake system is not working properly.
- DO NOT use the knee walker unless make sure that all parts are secure and moving parts are in good working order.
- DO NOT lean forward, backward, or to either side while using.
- DO NOT use the knee walker unless seat lock lever is securely locked into place.
- DO NOT lean forward while applying the brakes.
- DO NOT perform any adjustments to the knee walker while it is in use.
- DO NOT use the seat to transport people or objects.
- DO NOT sit on the knee walker while it is being loaded into a vehicle or while it is being transported in vehicle.
- DO NOT hang anything from the Knee Walker handles or frame at any time. This may cause the Knee Walker to tip, resulting in bodily injury or Knee Walker damage. Items should be placed in the basket.
- DO NOT attempt to reach objects while using the knee walker. Reaching for these objects will cause a change of the weight distribution and may tip over, resulting in injury or damage.
- DO NOT walk backwards while using the knee walker. All wheels must be in contact with the floor at all times during use. This will ensure the knee walker is properly balanced.
- Always keep both hands on the handle grips when in use.
- When turning the knee walker, exercise caution and only turn while at a slow rate of movement.
- The knee walker is for individual use only.
- DO NOT attempt to push the knee walker while someone is seated on it.
- The knee walker is not to be used as a transportation device.
- A physical/occupational therapist should assist in the height adjustments of the Knee Walker for maximum support and correct brake activation.

#### PRODUCT SPECIFICATION

Size and Weight	
Knee Pad Size	15.35 x 7.48 x 3.93 in
Pad height	18.9-23.6 in
Total width	17.7 in
Total length	32.6 in
Total height/Height of handle (adjustable at 9 levels)	33-41.3 in
Empty weight (include Basket)	23.3 lb
Walker weight Capacity	300 lb
Basket weight capacity	5 lb
Folding size	21.6 x 18.1x17.3 in
Wheels	
Front wheels	12 x 1.37 in
Back wheels	10 x 1.37 in
Materials	
Frame	Steel (corrosion protection)
Seat	Nylon, black
Seat Inner	Foams
Tire	Rubber
Operating Conditions	
Temperature	0 - 122°F
Humidity	20 - 80 %
Storage Conditions	
Temperature	-4 bis + 140 °F
Humidity	45 - 60 %



001-877-644-9366  
customerservice@aocom.com