

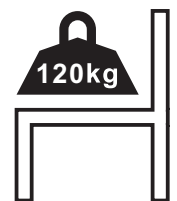

INcxa047_US

713-127V80

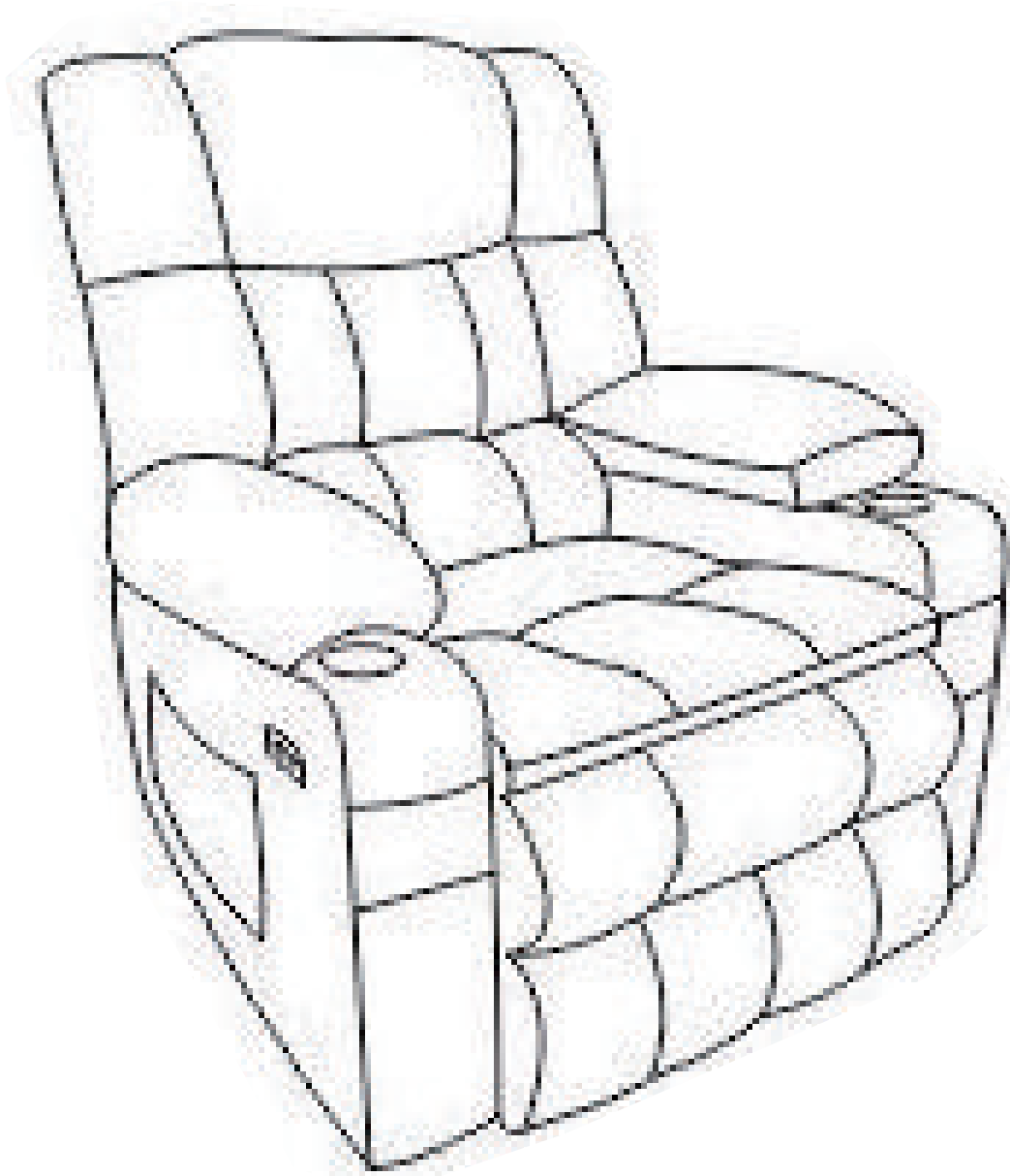

IMPORTANT, RETAIN FOR FUTURE REFERENCE: READ CAREFULLY

ASSEMBLY & INSTRUCTION MANUAL

BOX
1-2

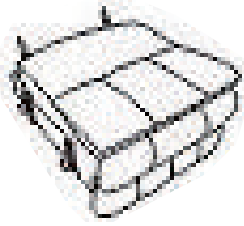

B x 1

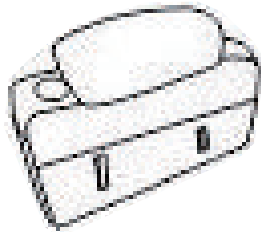

D x 1

BOX
2-2

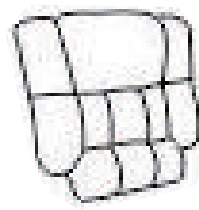

A x 1

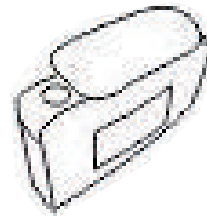

C x 1

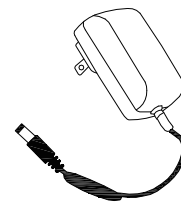

E x 1

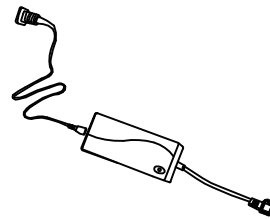

F x 1

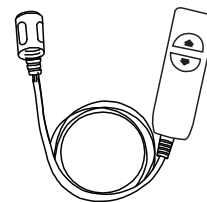

G x 1

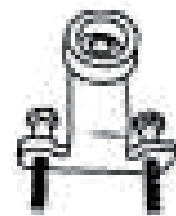

H x 2

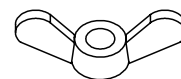

I x 4

Chairs

IMPORTANT, RETAIN FOR FUTURE REFERENCE: READ CAREFULLY

Only for domestic use

Instructions for use:

- *Put the chair stably on a flat floor.
- *Building the chairs in good condition.
- *Stay away from open flames.
- *Avoid the overload at the chair.

Precautions before assembly:

- *Prepare a clean and dry mounting area.
- *Verify that the product is not damaged.
- *Check that none of the pieces are missing.

Maintenance:

- *Clean with a soft fabric.
- *Regularly remove leaves and / or water collected on the canvas.
- *Check the seating regularly.

Storage conditions:

*The fabric should be stored completely dry, in a clean and dry place to avoid the risks of mold.

Beware of crushing and cutting hazards during assembly.

The manufacturer declines all responsibility in case of damages due to a bad installation or withering.

If the seating is fitted with powered seat height adjustments, only trained personnel may replace or repair those components.

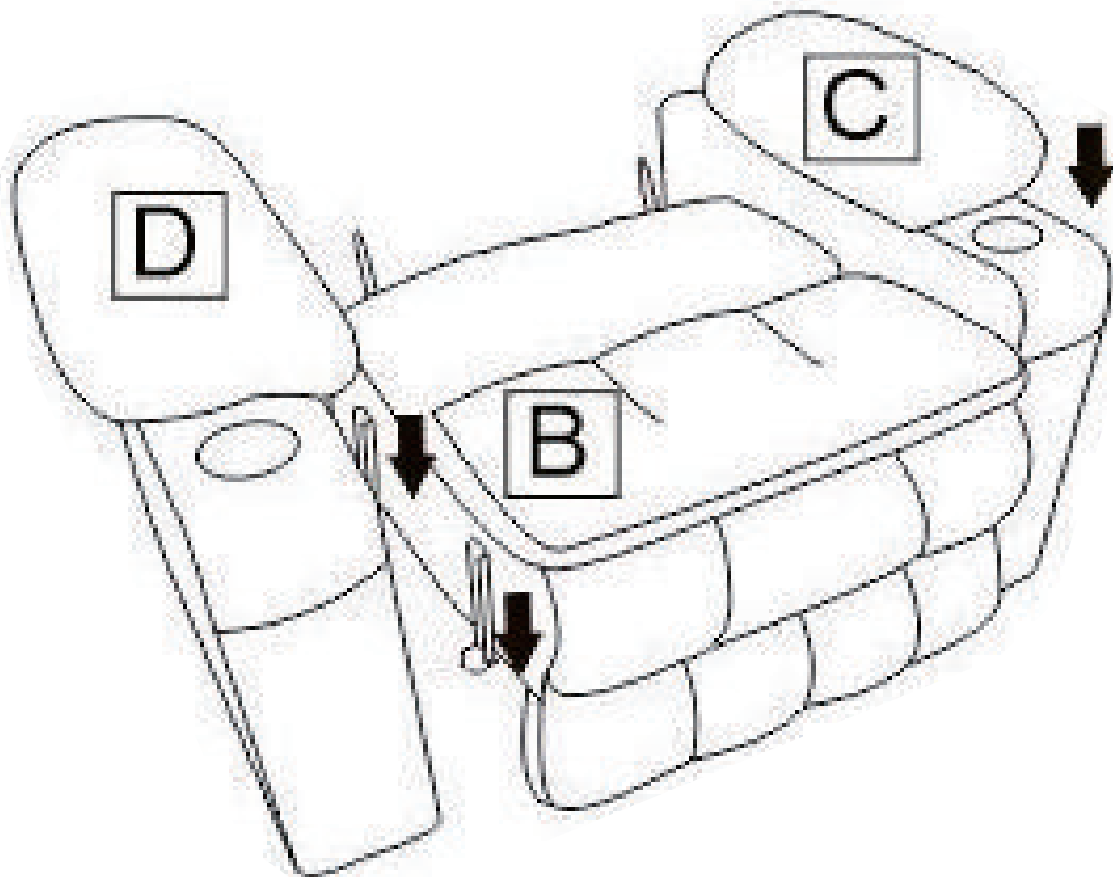
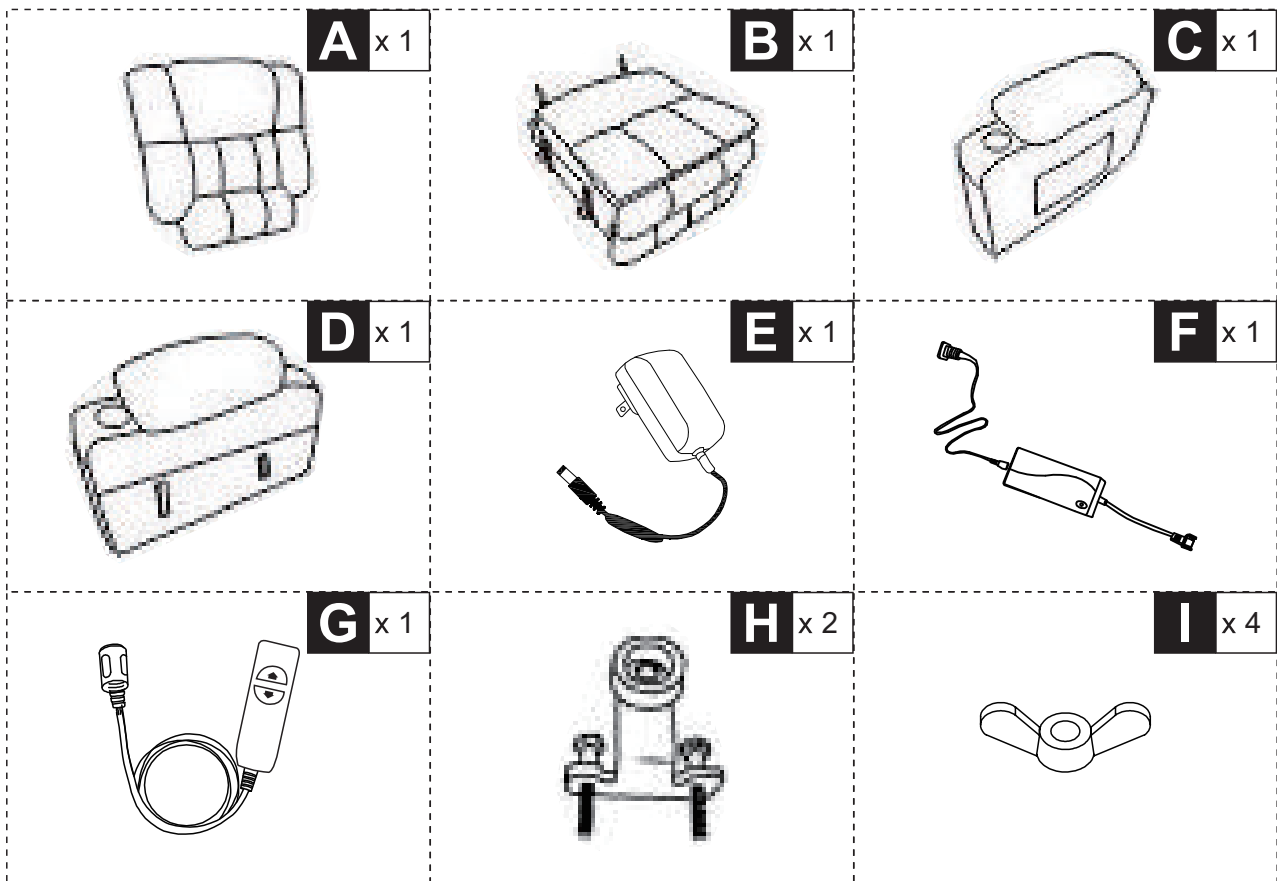

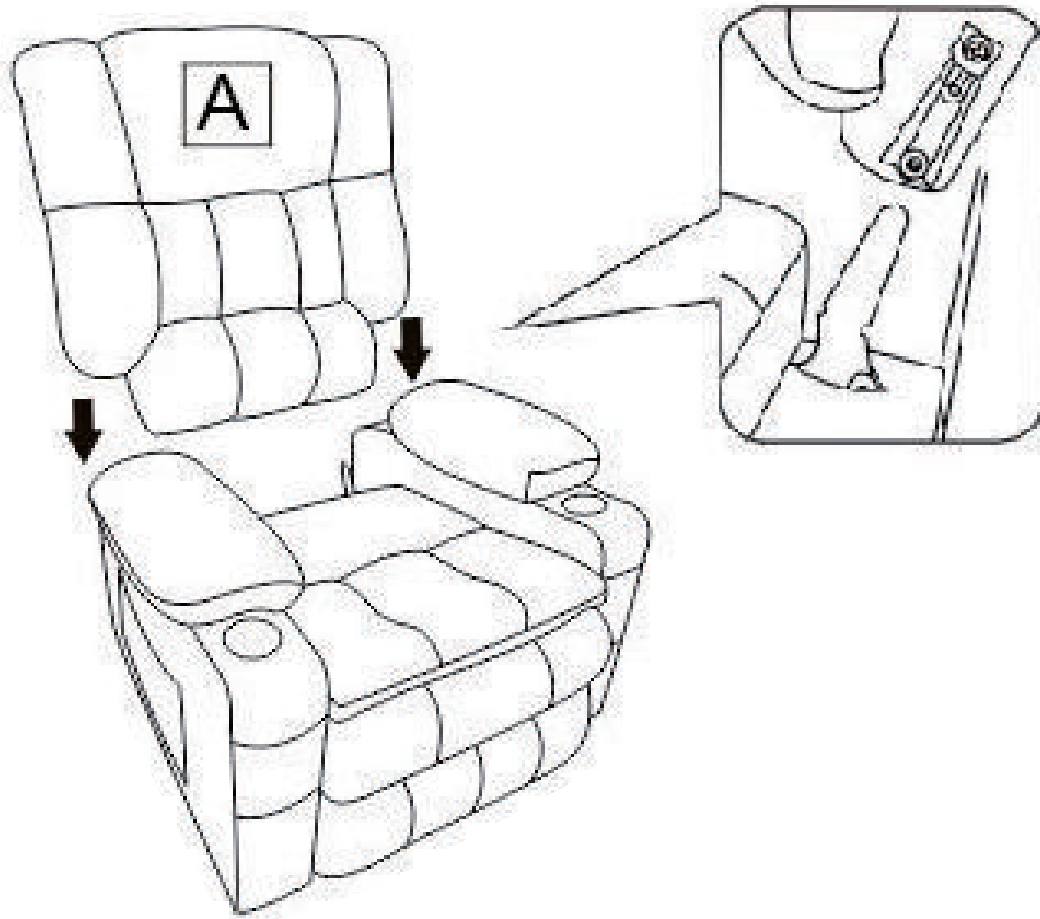

Input voltage	100-240 V
Input AC frequency	47-63 Hz
Output voltage	29 V
Output current	2 A
Output power	58 W
Average active efficiency	≥ 88 %
Efficiency at low load (10 %)	%
No-load power consumption	0.15 W

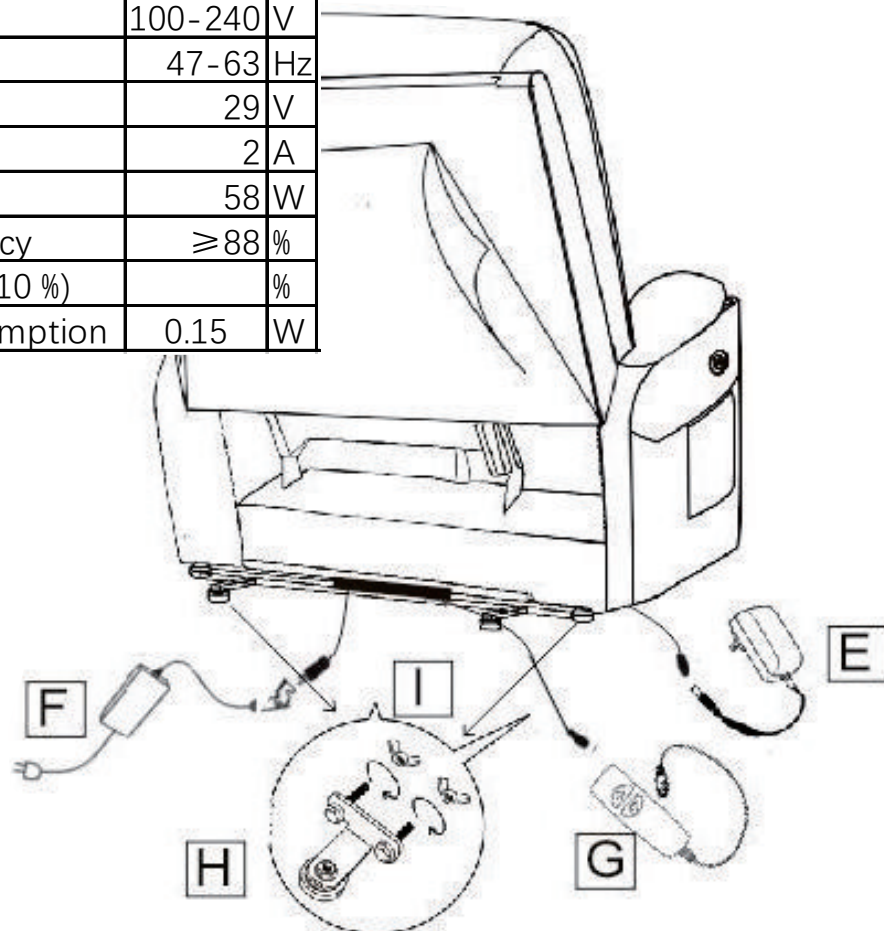

EN How do you use the remote control for the sitting/lying position?

FR Comment utiliser la télécommande en position assise/couchée ?

ES ¿Cómo se utiliza el control remoto para ajustar a la posición para sentarse/acostarse?

DE Wie verwendet man die Fernbedienung für die Sitz-/Liegeposition?

IT Come si usa il telecomando dalla posizione seduta/sdraiata?

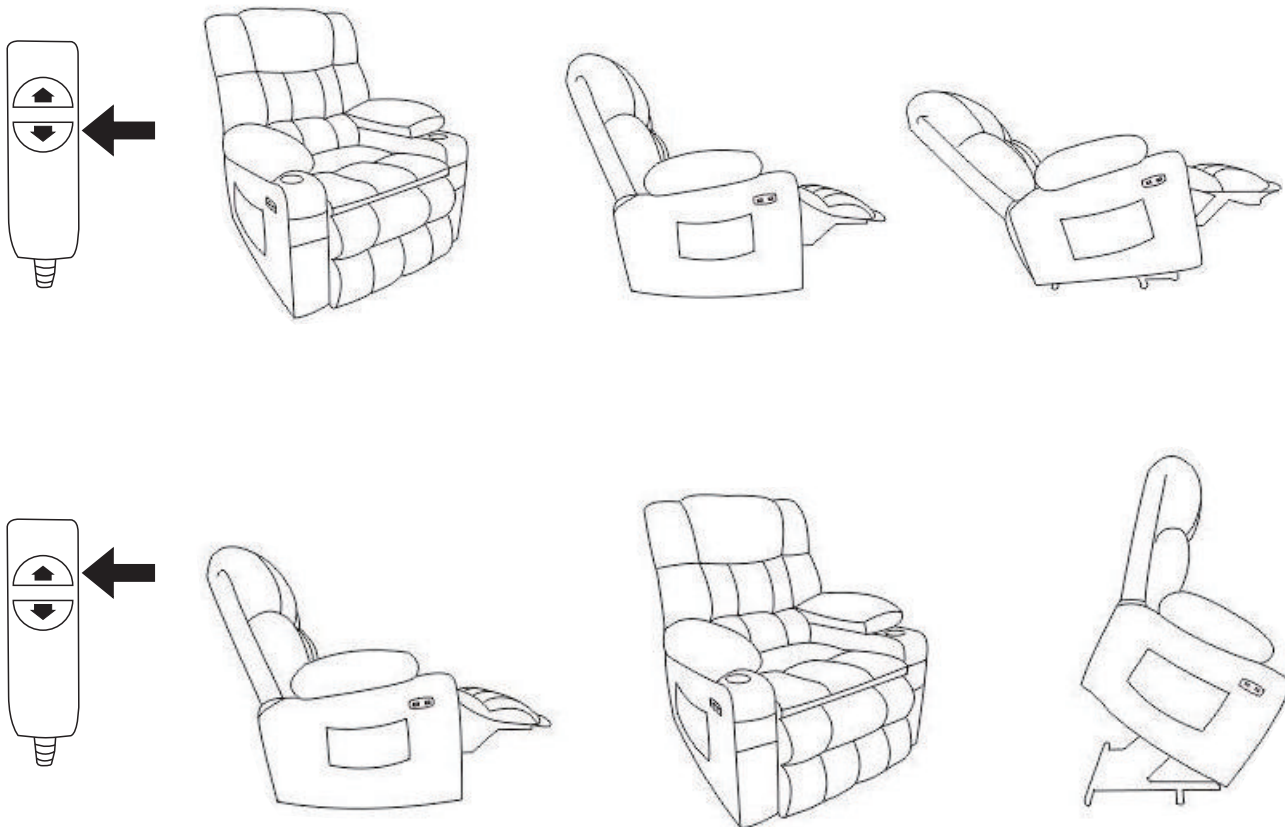

EN Backrest down and footrest up. (reclining position)

FR Dossier abaissé et repose-pieds relevé. (position allongée)

ES Para descender el respaldo y elevar el reposapiés. (Posición reclinada)

DE Rückenlehne nach unten und Fußstütze nach oben. (Zurückgelehnte Position)

IT Schienale abbassato e poggiatesta rialzato. (da sdraiati)



EN Backrest straight and foot section down. (sitting position)

FR Dossier droit et repose-pieds vers le bas. (position assise)

ES Para poner el respaldo en posición vertical y descender el reposapiés. (Posición para sentarse)

DE Rückenlehne gerade und Fußteil nach unten. (Sitzposition)

IT Schienale dritto e poggiatesta abbassato. (da seduti)