



INdab014_US_D00-116

PRODUCT ASSEMBLY STEPS

Assemble the cart as follows and confirm that the parts are fixed before use.
IMPORTANT, RETAIN FOR FUTURE REFERENCE: READ CAREFULLY

01 Understand all parts of the product



02 Front wheel assembly and disassembly

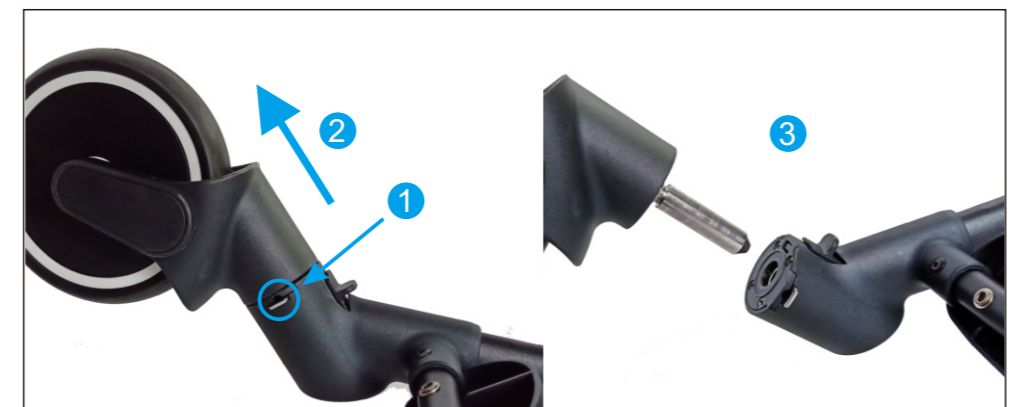

Assembly
Press and remove the telescopic with your left hand and pull the wheel out,

Assembly
Insert directly into the front wheel hole.

03 Pull Rod Function (Easy Carry)



Pull the rod up on the top of the stroller after fold up. Then change into travel box mode. (Notice: the front wheel have to face inside)

04 Frant Wheel Direction Key & Braking System



Frant Wheel Direction Key
Pull the button down, then the direction fixed.

Braking System
Step down the brake, then the stroller can be locked.

05 Fold Up The Stroller



Pull the button 1 to the left and press the button 2 as shown in the figure, press the whole car down, then push from the both side lock the stroller, and finally the front wheel have to face inside, then finish folding up the stroller.

06 Unfold The Stroller



Pull the button 1 to the left and press the button 2 as shown in the figure, pull the whole car up, then hold the handle with one hand and the other hand push the stroller like step 3 shows.