

# PawHut

INdccc040\_UK\_

**D51-155**



**ASSEMBLY INSTRUCTION**

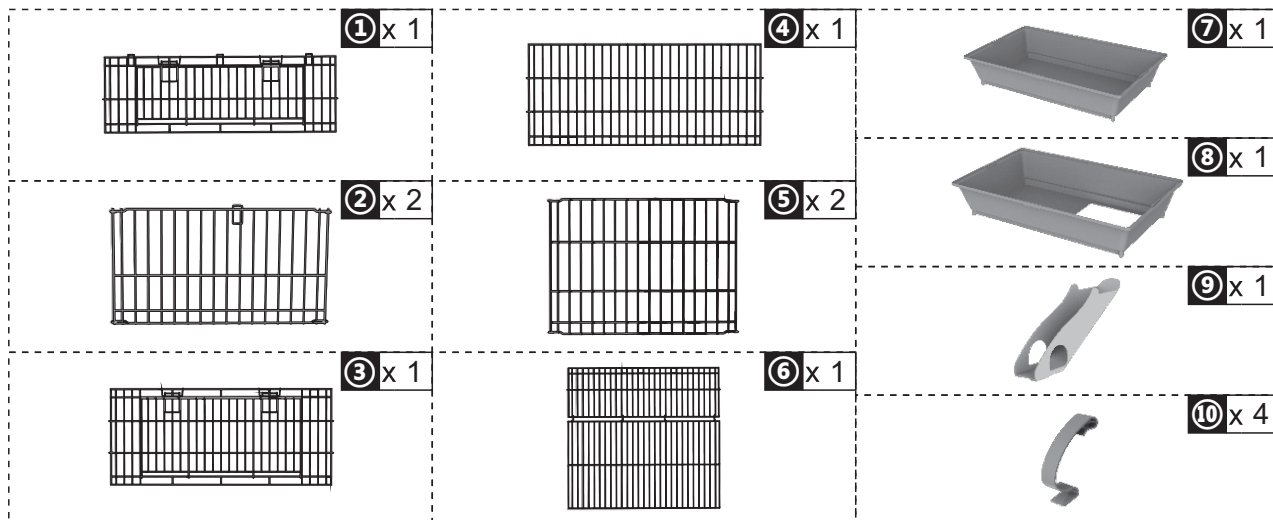

① x 1

⑤ x 2

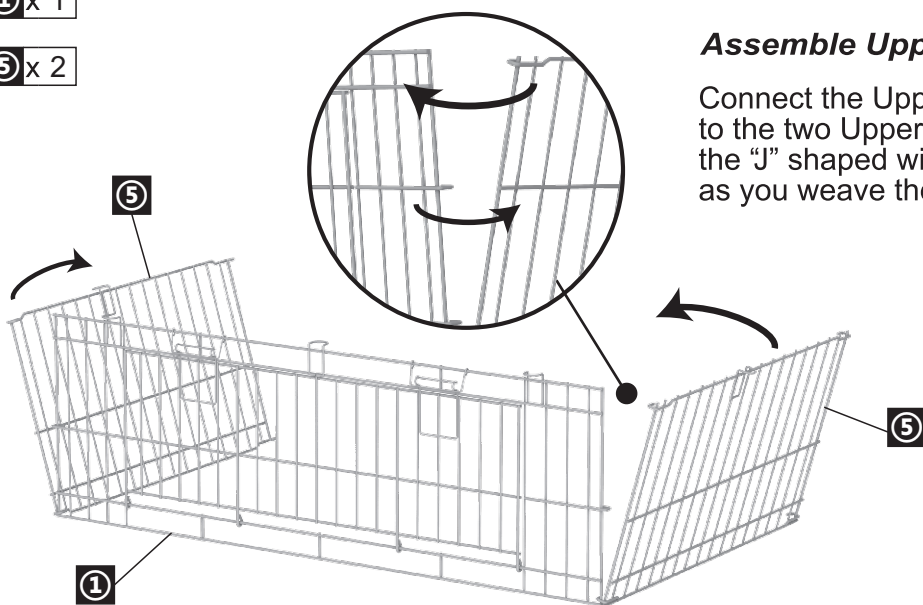

**Assemble Upper Level Cage**

Connect the Upper Section Front Wire Panel to the two Upper Section Side Panels using the "J" shaped wire hooks. Alternate the hooks as you weave the wire connection.

⑥ x 1

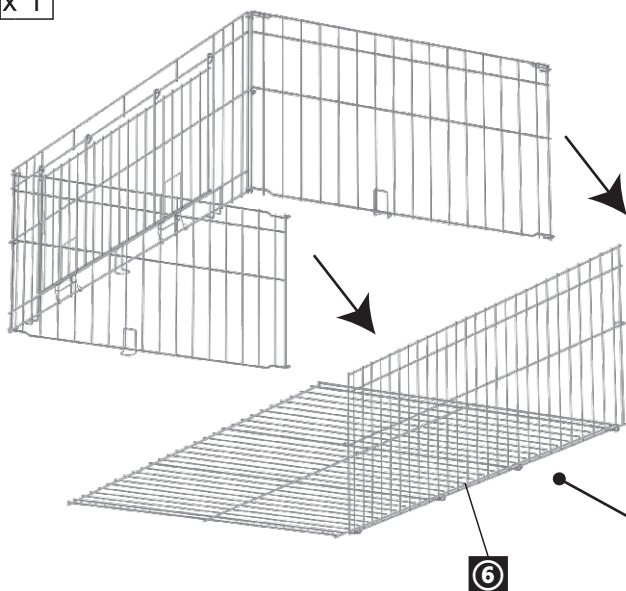

Connect the Upper Top and Back Panel to the connected Upper Section Front and Upper Section Side panels by placing the Upper Top and Back Panel onto a flat surface and connecting the back panel to the Side Panels using the "J" shaped wire hooks.



**Place Upper Top Panel onto a flat surface to connect to the Front and Side Panels.**

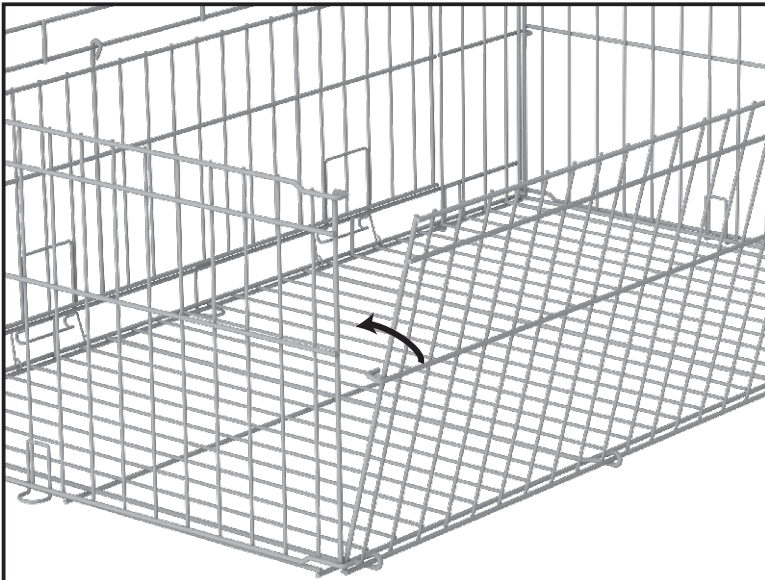

Weave the Back Panel and the Side Panels together using the "J" Shaped Wire hooks.

③ x 1

② x 1

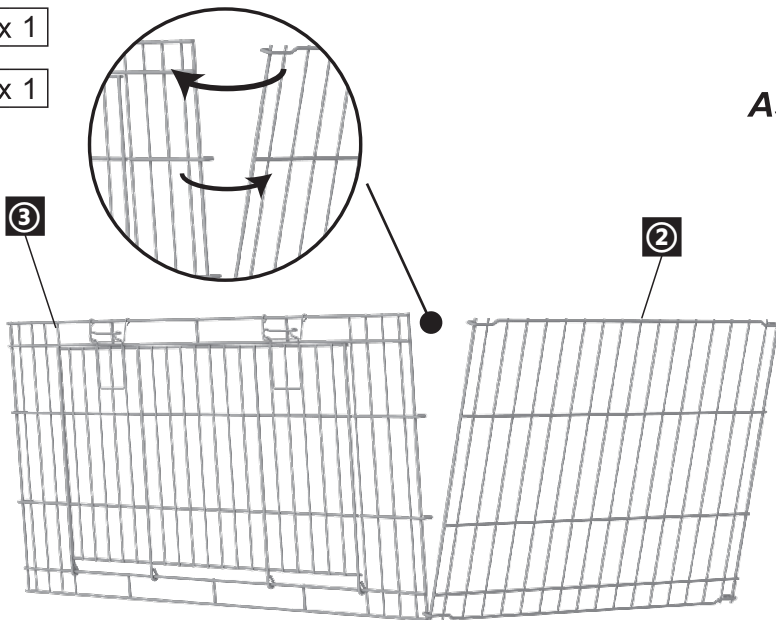

### Assemble Lower Level Cage

Connect the Lower Section Front Wire Panel to one of the Lower Section Side panels using the "J" shaped wire hooks.

These hooks are designed to create a woven connection point.

Start at the bottom and alternate hooks as you weave the wire connection.

④ x 1

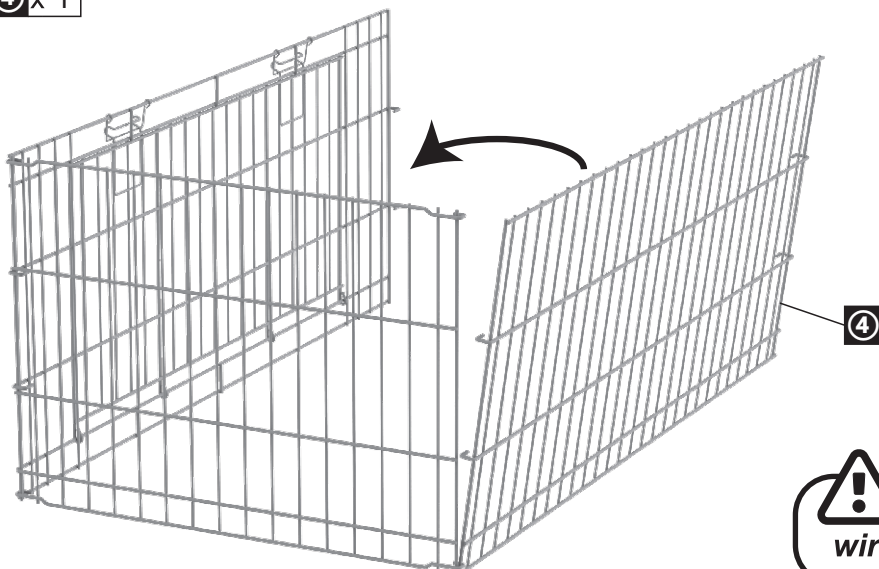

Connect the Lower Section Back Wire Panel to the Lower Section Side Panel using the "J" Shaped wire hooks.



**Make sure the horizontal wires face towards the outside**

② x 1

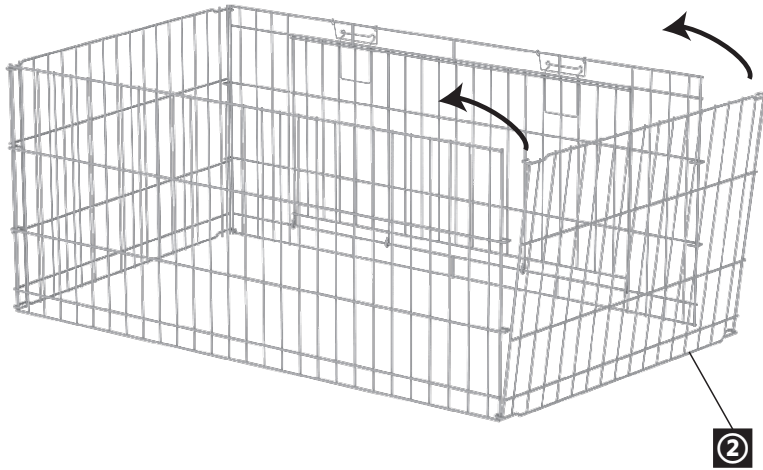

Connect the remaining Lower Section Side Panel to the Lower Section Front and Back Wire Panels using the "J" shaped wire hooks.

⑦ x 1

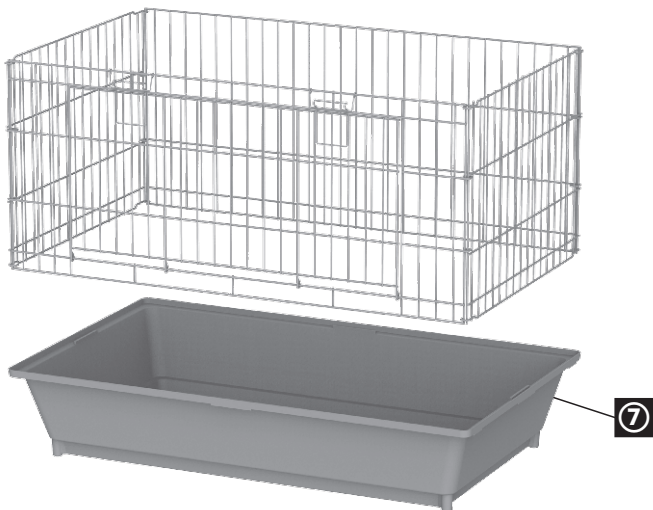

Place the assembled Lower Cage onto the Bottom Base with door facing forward.



**The Bottom base does not have a hole**

⑧ x 1

⑩ x 4

Place the Top Base onto the Lower Cage.

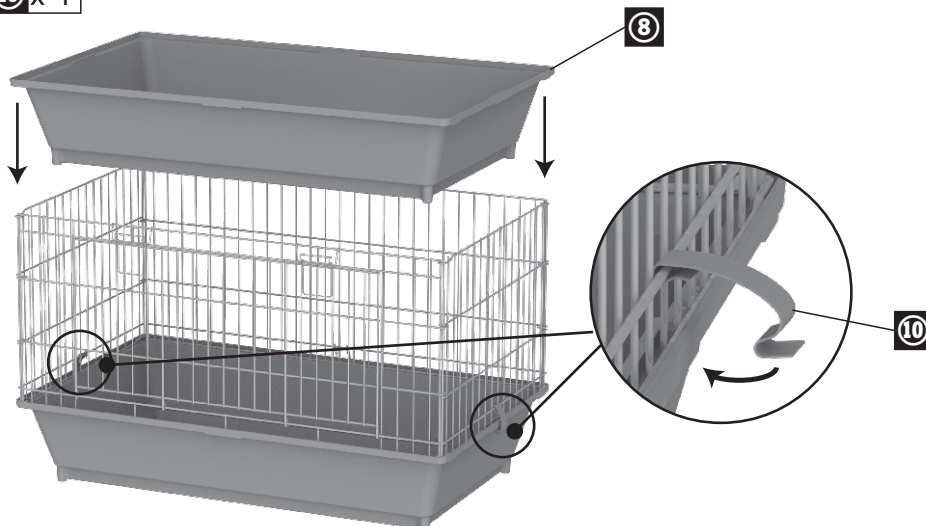

Connect the Cage Connectors centered on the short sides of the cage as pictured. Clamp the Cage Connectors to secure the Wire to the Base.



⑨ x 1

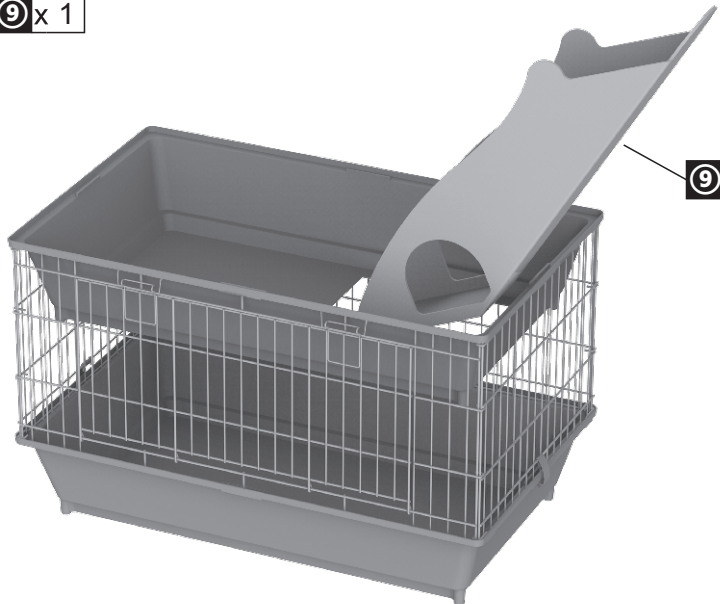

Slide the Ramp into the cage through the hole in the Top Base.

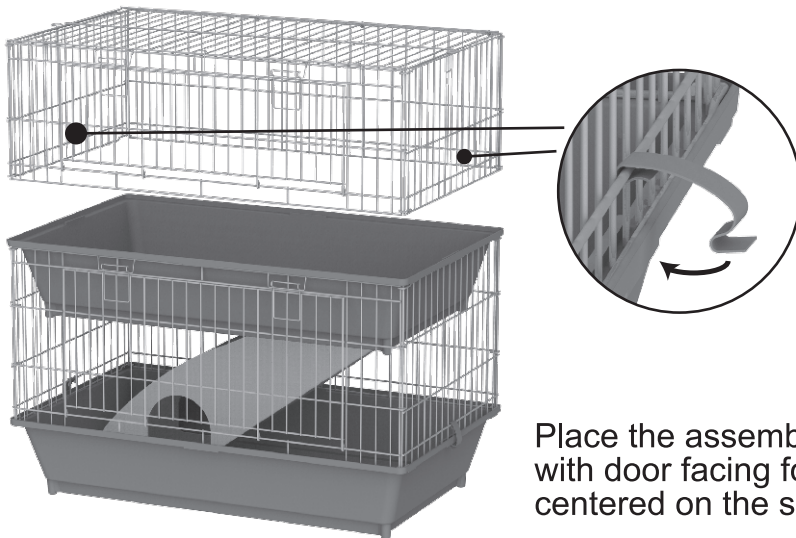

**!** Make sure all of the Cage Connectors are secure before moving your assembled cage.

Place the assembled Upper Cage into the Top Base with door facing forward. Connect the Cage Connectors centered on the short sides of the cage

Clamp the Cage Connectors to secure the Top Wire to the Base.

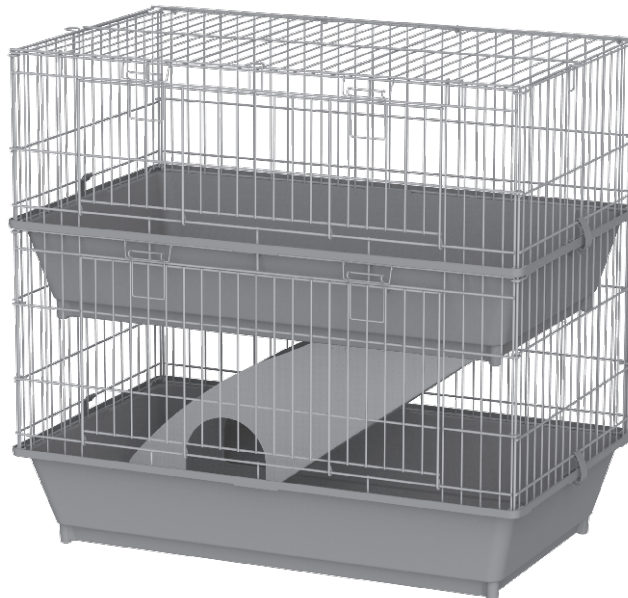

US



001-877-644-9366  
customerservice@aosom.com

CA



001-855-537-6088  
customerservice@aosom.ca

UK



0044-800-240-4004  
enquiries@mhstar.co.uk

DE



0049-(0)40-88307530  
service@aosom.de

FR



0033-1-84166106  
contact@aosom.fr

ES



0034-931294512  
atencioncliente@aosom.es

IT



0039-0249471447  
clienti@aosom.it