

PawHut

Indcc041V01_US_UK

D51-153



IMPORTANT, RETAIN FOR FUTURE REFERENCE: READ CAREFULLY

ASSEMBLY & INSTRUCTION MANUAL

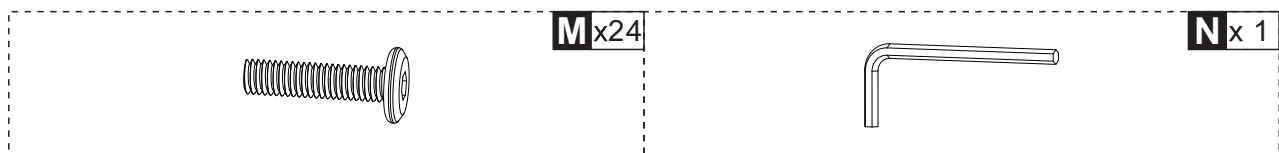
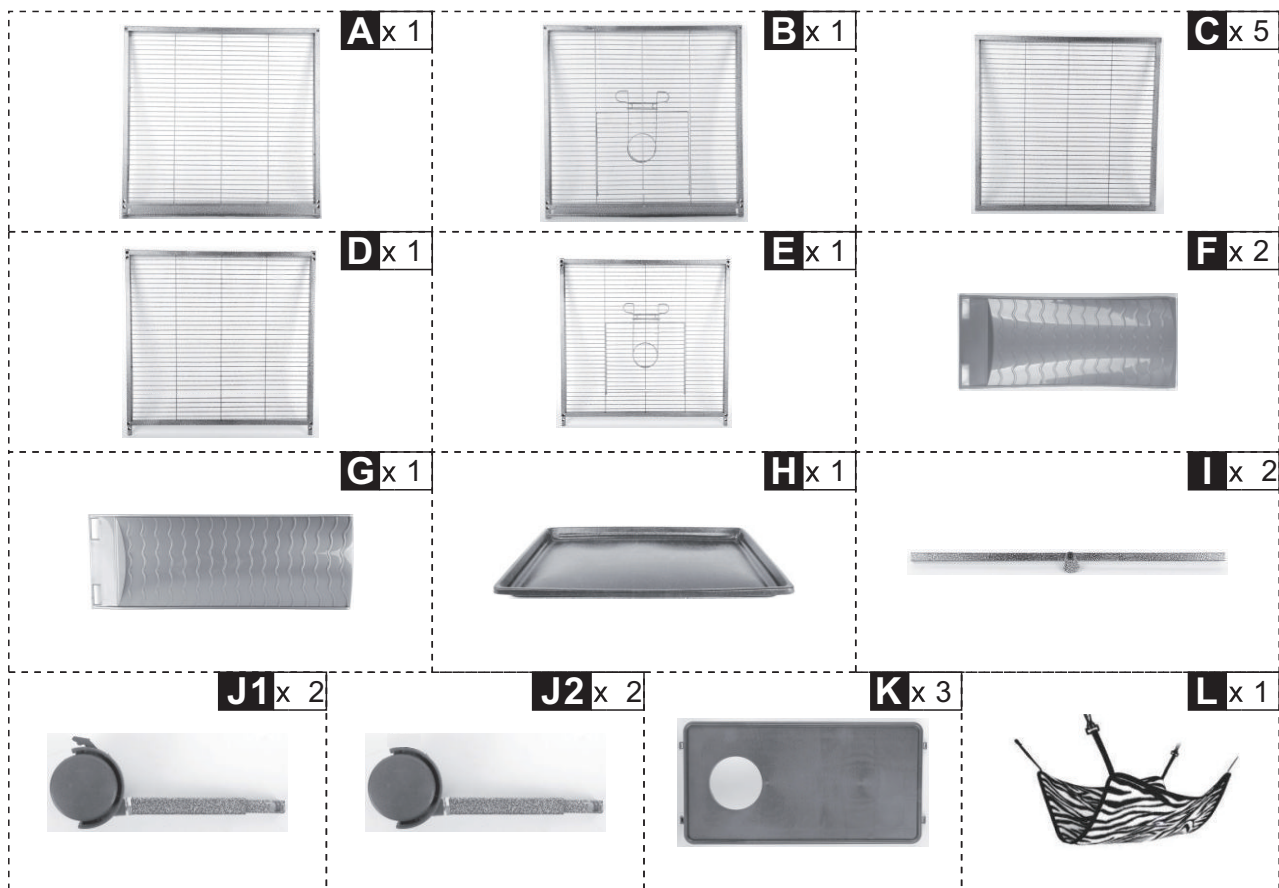

Ax 1 **B**x 1 **C**x 2 **M**x 8 **N**x 1

Note: Cage is upside down for this step.

01

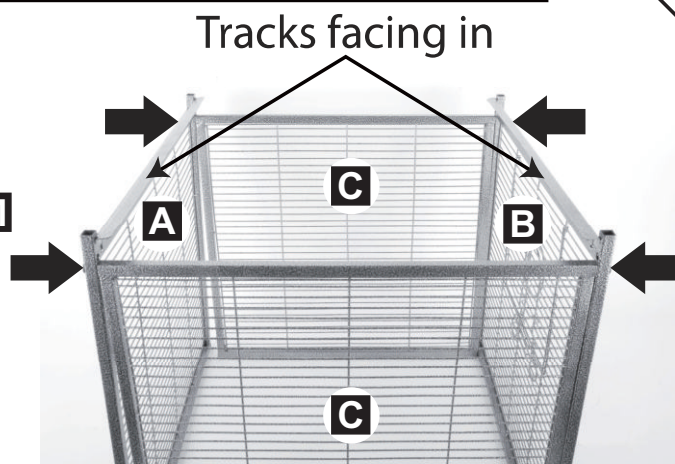
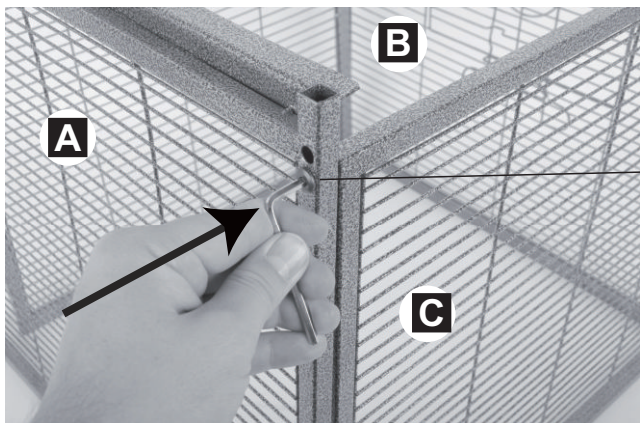

Connect the Bottom Back Wire (A) and the Bottom Front Wire (B) to the Side Wire (C) with the tracks facing up and towards the inside of the cage. **Tip: Do not fully tighten bolts until all panels are in place.**

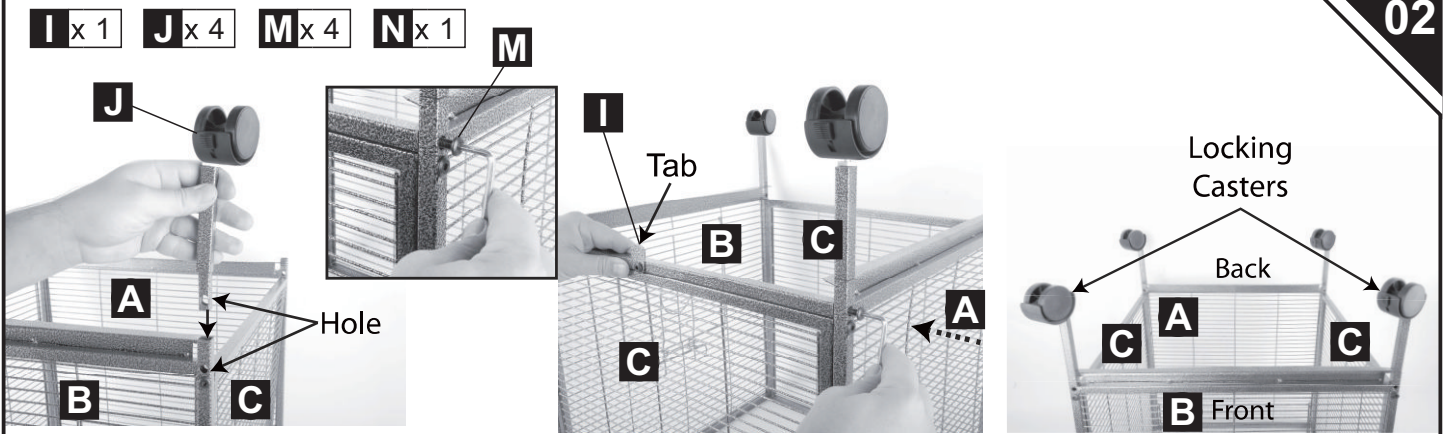

Insert the Casters into the Bottom Front (A) and Back (B) Wires, then connect both by screwing in bolts on each side(see inset image). Place the locking casters in the holes at the cage front. **Flip the cage so the wheels are on the ground. Tip: the tabs on the support bars should be facing towards the outside.**

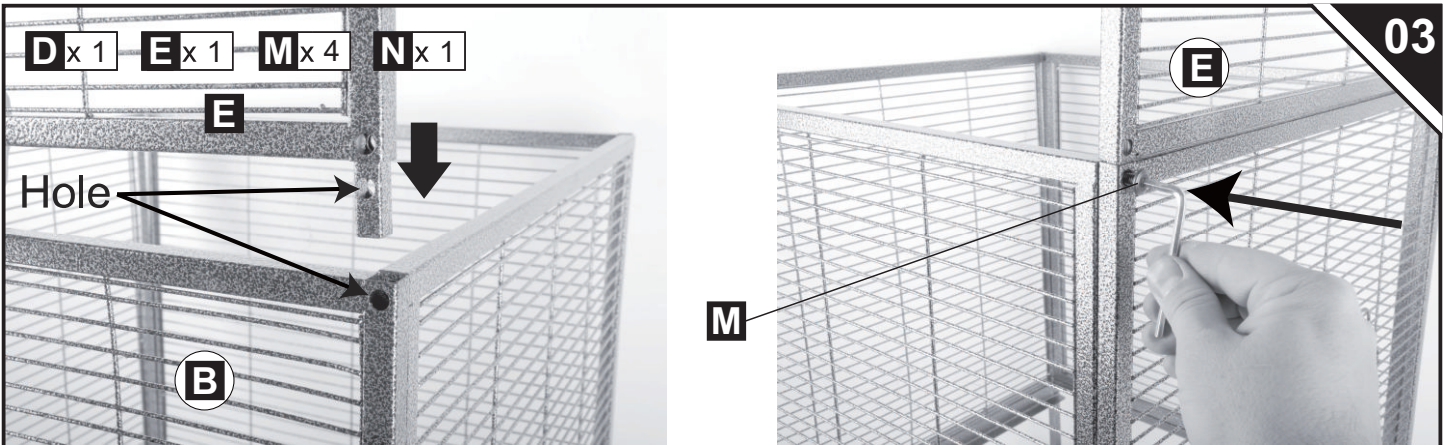

Add the Top Back Wire (D) and Top Front Wire (E) to the lower portion of the cage by inserting each panel into the slots provided. Then screw in the top bolts into the Lower Side Panels to connect upper and lower wires.

Note: Make sure that the panels with the doors are placed on same side.

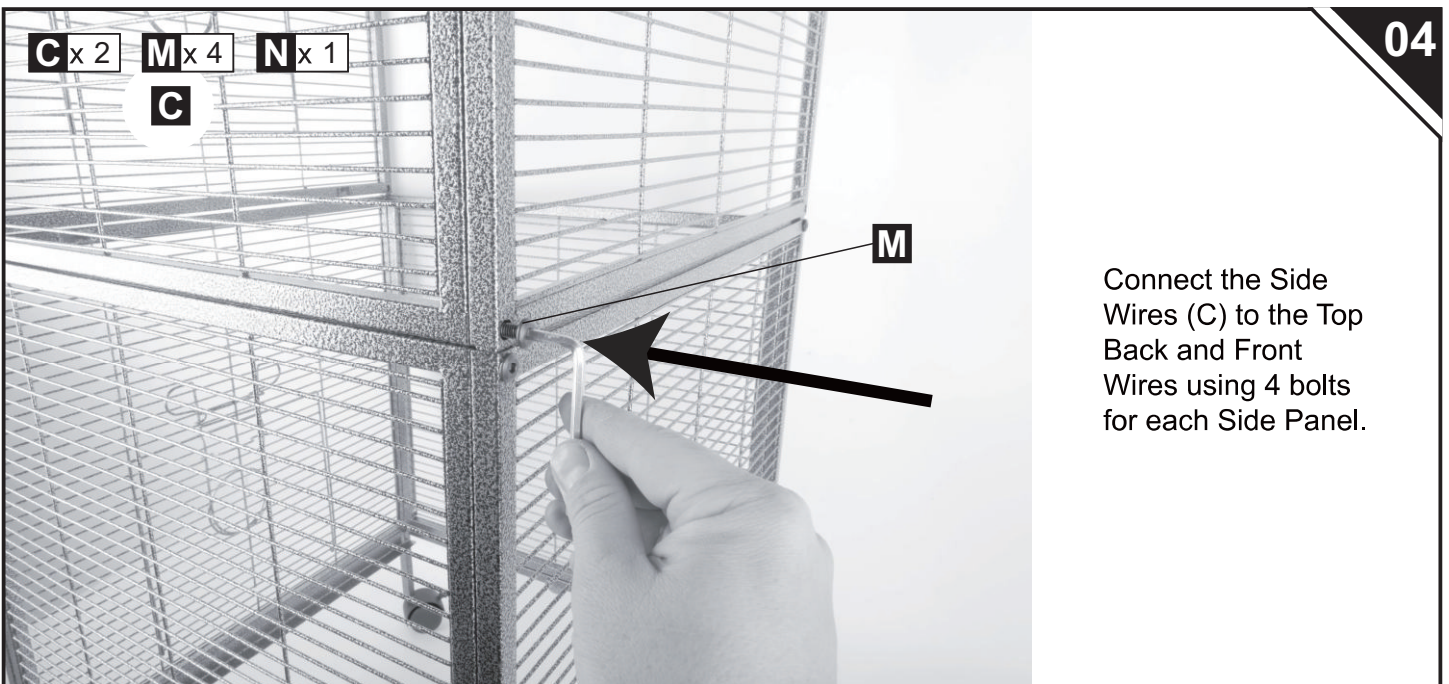

Connect the Side Wires (C) to the Top Back and Front Wires using 4 bolts for each Side Panel.

C x 1 **M** x 4 **N** x 1

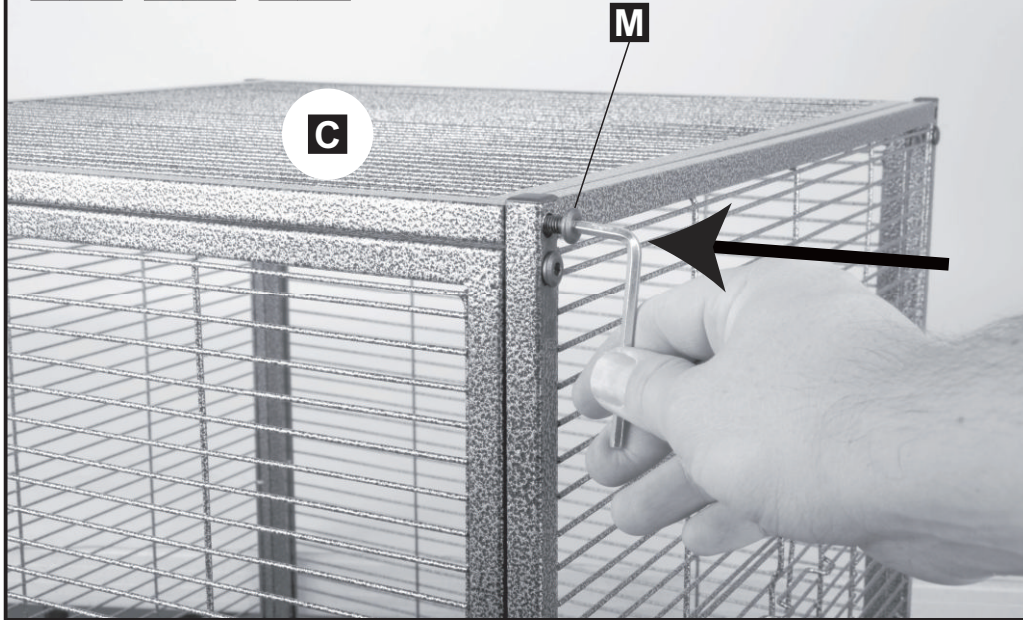

05

Lower the Top Wire into place and attach with bolts on each corner. **Tighten all bolts used in previous steps.**

H x 1

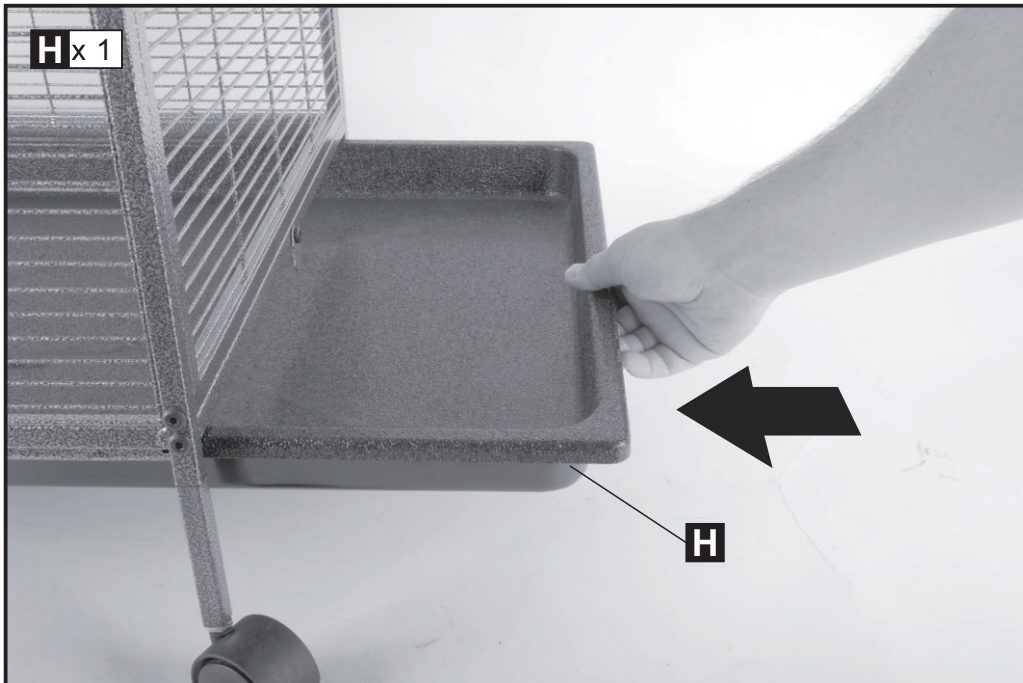

06

Slide the Plastic Pull Pan into the slots located on the lower panels.

F x 2 **G** x 1 **K** x 3

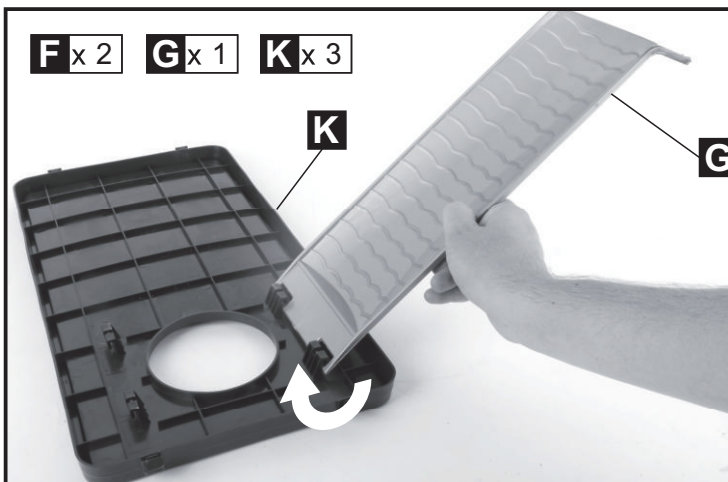

07

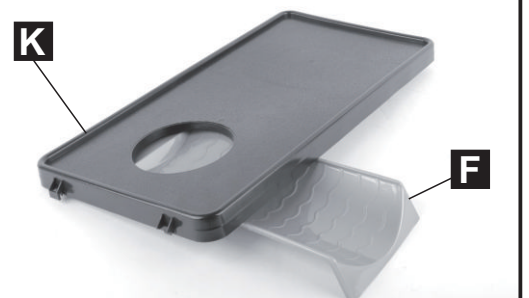

Connect the ramps to the bottom of the shelves as shown in image.

L x 1

Place assembled shelves and ramps in the cage through the doors.

Next, attach the top shelf with a **Short Ramp** to the **14th bar up from the center bar at the back of the cage.**

Then, attach the middle shelf with a **Short Ramp** to the **3rd wire down from the center bar in the front.**

Attach the lowest shelf with a **Long Ramp** to the **15th bar up from the bottom on the lower Side Panels at the back of the cage.**

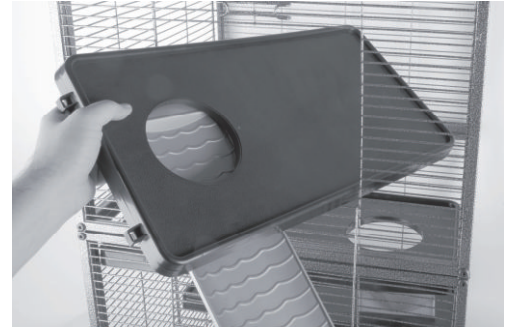

L



Attach Hammock to the roof of the cage.

Done



US



001-877-644-9366
customerservice@aosom.com

CA



001-855-537-6088
customerservice@aosom.ca

UK



0044-800-240-4004
enquiries@mhstar.co.uk

DE



0049-(0)40-88307530
service@aosom.de

FR



0033-1-84166106
contact@aosom.fr

ES



0034-931294512
atencioncliente@aosom.es

IT



0039-0249471447
clienti@aosom.it