



- 1.Suitable age for 18-36 Months.**
- 2.Maximum user weight: 20KGS.**
- 3.Adult assembly required**

# About Your New Vehicle

Specification	Item	Specifications
Maximum weight	Size	20KGS 73*39*48CM
Available ages		Children at 18-36 months

## WARNING:

- (1). this kind of product is fit for the children aged 18-36 month old and maximum load under 20kg maximum load under 20kg
- (2).WARNING-never leave the child unattended
- (3).prevent access to stairs, steps and uneven surface
- (4). remove hot liquids, electrical flexes and other potential hazards from reach
- (5).prevent collisions with glass in doors,windows and furniture
- (6).instrution for rountine maintenance and cleaning or washing
- (7). before using, this product will be inspected and assembled by the adult

## The notices of installing and changing batteries

- (1). installing and changing batteries should be fullfilled by adults
- (2).install the battries refer to the picturs(1) of the parts:

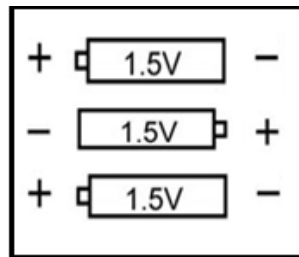

the installation of AA (1.5V) batteries: open the cover, install the battries correctly according to the marks of the postive and the negative erectrodes , finally put on the cover and fasten the cover

- (3).the unchargable battries must not be changed and do not mix the different types of the battries( or the new and the old) to use together
- (4).take out the used-up batteries and avoid short circuit.

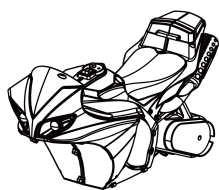

1.Body

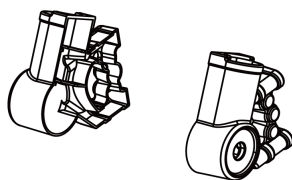

5.Front fork decoration



9.A rear axle



2. Windshield

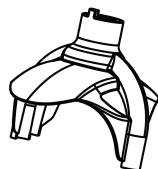

6.Front mud plate



10.Front wheel

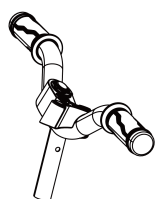

3.Handlerbar

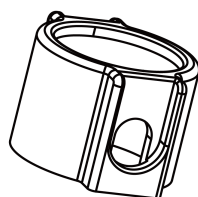

7.Tap sleeve



11.Rear wheel \*2



4.Fork

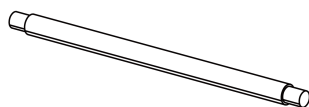

8.Front axle

**A** x 6



M10

**B** x 1



M5\*30

**C** x 4



M8

**D** x 1



M5

## Attach the Side Wheels & Rear Fender

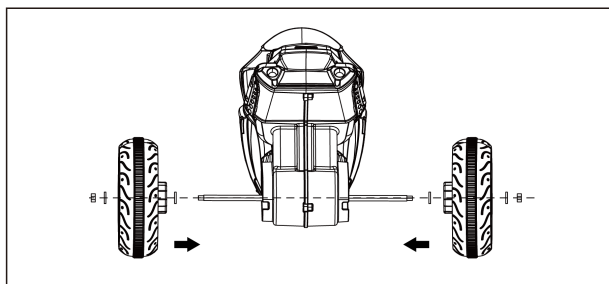

1. insert the back axis, assemble back wheels, fix the wheels (2XM8 NUT&4X10MM GASKET)

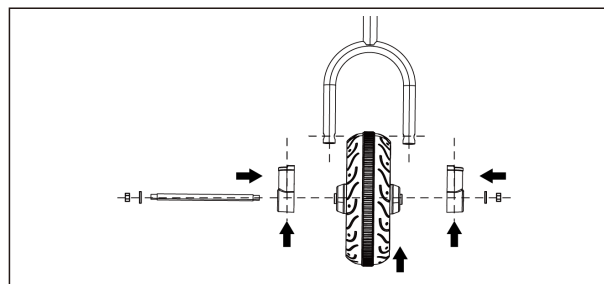

2. insert the fork decoration into the fork, insert the front axle & fix the front wheel (2XM8 NUT&2X10MM GASKET)

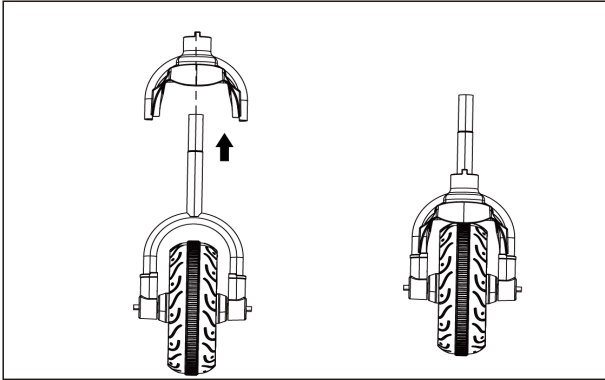

3. insert Front mud plate onto the fork

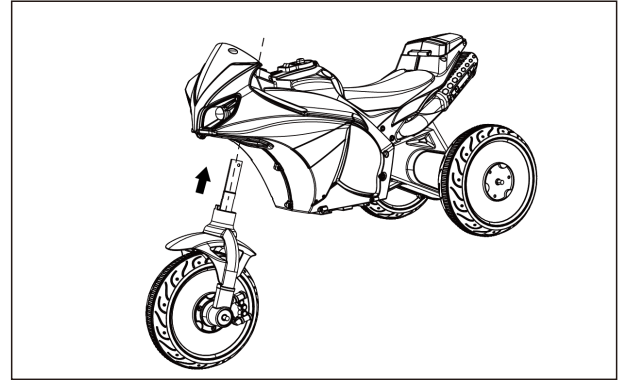

4. Lift the body and insert the steering tube

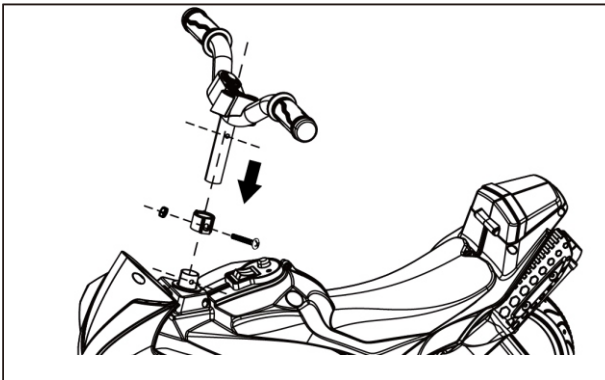

5. fix the handle bar & tap sleeve (1X(5X30)SCREW&1XM5 NUT)

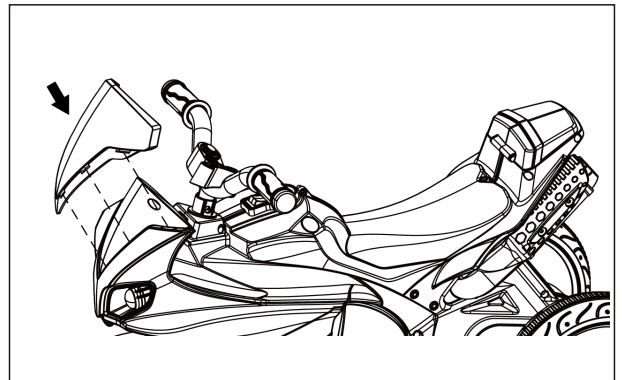

6. Stuck the windshield on car.

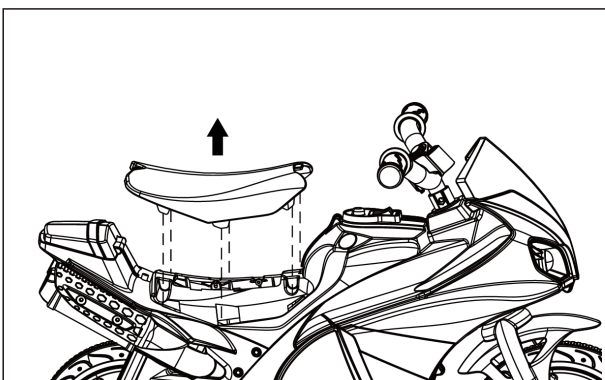

7. Loosen the 4x10 mounting screws and open the seat cushion

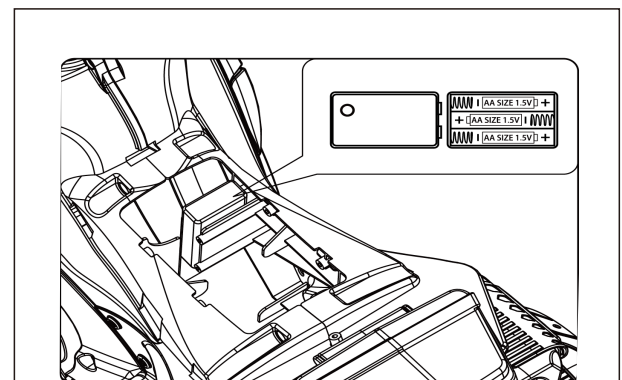

8. Add the dry battery and close the seat (3X1.5V#7 dry cell)

US



001-877-644-9366  
customerservice@aosom.com

CA



001-855-537-6088  
customerservice@aosom.ca

UK



0044-800-240-4004  
enquiries@mhstar.co.uk

DE



0049-(0)40-88307530  
service@aosom.de

FR



0033-1-84166106  
contact@aosom.fr

ES



0034-931294512  
atencioncliente@aosom.es

IT



0039-0249471447  
clienti@aosom.it